

# CERTIFIED CORNER RECORDATION

Corner N-S-N 1/256 T. 35N R. 27W P.M.M. Lincoln County

1. Found  $\frac{5}{8}$ " rebar and plastic cap-MarQuardt, LS #7328.
2. Removed plastic cap and set 3 1/4" USDA Forest Service Cadastral aluminum cap on existing 25"X  $\frac{5}{8}$ " rebar that has been stamped as shown.

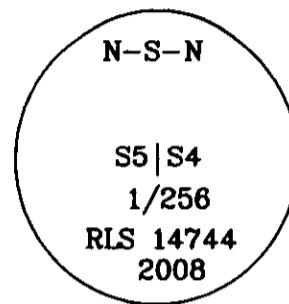

3. An 9 1/2" Western Larch bearing S 74° E at a distance of 14.4 feet and scribed (NSN 1/256 S4 BT).

A 6" Douglas Fir bearing N 02° E at a distance of 18.8 feet and scribed (NSN 1/256 S4 BT).

4. Set steel post with Land Survey Marker and Property Boundary stickers bearing East at a distance of 3.0 feet.

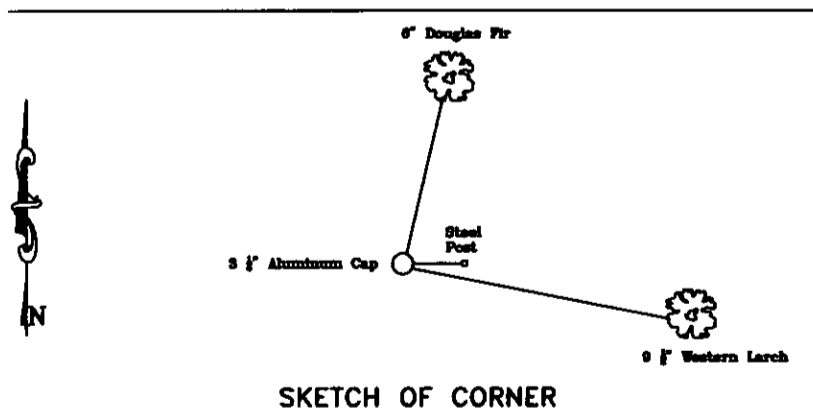
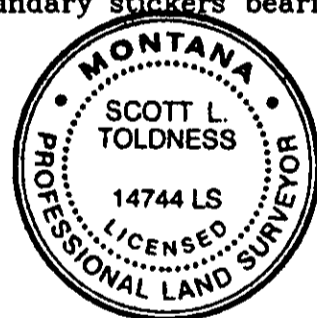

**CERTIFICATION**

I, Roger Miller  
certify the information shown herein is true and correct.  
ROGER MILLER  
Signature Ground Party Chief

I, Scott L. Toldness  
certify that this Corner Record correctly represents work performed by me or under my direction in compliance with the "Corner Recordation Act" (70-22-101, et seq., M.C.A.)  
Scott L. Toldness  
Signature of Surveyor & Seal  
 Date: 9/04/08 Reg. No. 14744LS  
 Employer: Glahe & Associates Inc.

Office of Clerk and Recorder, County of Lincoln . This "corner

record" was filed for r: 214207 BOOK: CCR CC&R'S PAGE: 11270 Pages: 1

was noted on the cross: STATE OF MONTANA LINCOLN COUNTY

book No.                      RECORDED: 09/08/2008 11:55 KOI: CC&R'S

TAMMY D. LAUER CLERK AND RECORDER

FEE: \$0.00

BY:                     

TO: GLAHE & ASSOCIATES, INC.

Cross Index No. B-B-C-9 T. 35N R. 27W PMM

Adopted July 1, 1981, Montana Board of Professional Engineers & Land Surveyors

Sec. 4

• corner this sheet