

# CERTIFIED CORNER RECORDATION

Corner NE 1/16 T. 35N R. 27W P.M.M. Lincoln County

1. Set 3 1/4" USDA Forest Service Cadastral aluminum cap on 25"X 5/8" rebar that has been stamped as shown.

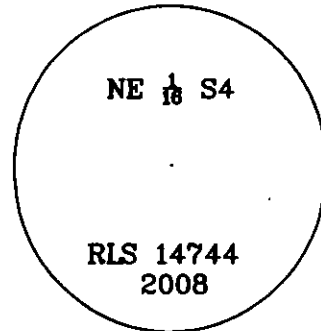

2. A 8" Douglas Fir bearing N 16° E at a distance of 10.8 feet and scribed (NE 1/16 S4 BT).

A 10" Western Larch bearing East at a distance of 15.7 feet and scribed (NE 1/16 S4 BT).

3. Set steel post with Land Survey Marker and Property Boundary stickers bearing East at a distance of 3.0 feet from corner.

Set steel post with Land Survey Marker and Property Boundary stickers bearing North at a distance of 3.0 feet from corner.

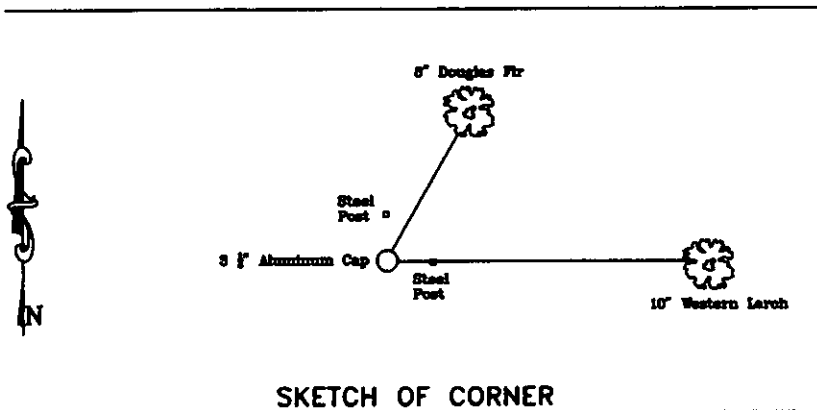

SKETCH OF CORNER

CERTIFICATION

Roger Miller  
I certify the information shown herein is true and correct.  
ROGER MILLER  
Signature Ground Party Chief

Scott L. Toldness  
I certify that this Corner Record correctly represents work performed by me or under my direction in compliance with the "Corner Recordation Act" (70-22-101, et seq., M.C.A.)  
Scott L. Toldness  
Signature of Surveyor & Seal

Date: 9/04/08 Reg. No. 14744 LS  
Employer: Glahe & Associates Inc.

Office of Clerk and Recorder, County of Lincoln . This "corner record" was filed for 214204 BOOK: CCR CC&R'S PAGE: 11267 Pages: 1 STATE OF MONTANA LINCOLN COUNTY  
was noted on the cr RECORDED: 09/08/2008 11:52 KOI: CC&R'S  
book No. TAMMY D. LAUER CLERK AND RECORDER  
FEE: \$0.00 BY: Francis Dwyer  
TO: GLAHE & ASSOCIATES, INC.

Cross Index No. B-12 T. 35N R. 27W PMM

Adopted July 1, 1981, Montana Board of Professional Engineers & Land Surveyors

Sec. 4

• corner this sheet