

CERTIFIED CORNER RECORDATION

Corner CC S4 | S5 T. 35 N. R. 27 W. P.M.M. LINCOLN County

I. 1893 Original Survey of the West and South Boundaries of T36N, R26, 27W. by Peter M. Cardell and Abram L. Jaqueth: Set a stone and four bearing trees.

1893 Subdivision and Meanders of T36N, R27W by Peter M. Cardell and Abram L. Jaqueth: Sites 1893 stone.

1911 Reestablishment of the Fractional South Boundary of T36N, 27W. by Abraham L. Rinearson and Gordon C. Smith: Sites the 1893 stone.

1911 Subdivision and Meanders of T35N, 27W. by Lewellyn D. Lyman and Royston C. Durnford: Intersect the N. bdy of the Tp. 125 lks. W. of the cor. of secs. 4, 5, 32 and 33. Hereinafter this will be known as the cor. of secs. 32 and 33 only. At the intersection, set a limestone and 2 BT's.

1969 BLM Remonumentation by Roy G. Leedy: The closing cor. of secs. 4 and 5, on the N. bdy. of the Tp., monumented with a limestone, 12x12x5 ins., firmly set, mkd. with 2 notches on the W. edge, CC on the S. face, and witnessed by the remains of the original bearing tree.

A stump, 12 ins. diam, bears S33 1/4°E, 238 lks.. dist., with butt of log mkd. S4 B lying alongside.

At the corner point, set an iron post, 30 ins. long, 2 1/2 ins. diam., 24 ins. in the ground, with brass cap mkd. from which:

A larch, 7 ins. diam, bears S75 3/4°E, 29 lks.. dist., T35N R27W S4 CC BT.

A larch, 10 ins. diam, bears S63°W, 45 lks.. dist., T35N R27W S5 CC BT

Bury the original stone alongside the iron pipe.

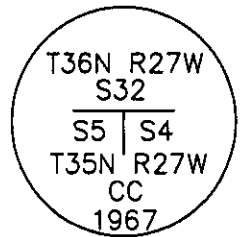

1995 Certified Corner Recordation by Ronald A. Pearson, MT Reg. No. 9008LS: Found a 2 1/2 in.s diam. iron pipe, 7 ins. out of ground with a 3 1/4 in. diam. BLM brass cap marked as shown above, from which

A larch, 8 ins. diam, bears S73°E, 19.5 ft. (29 lks.) dist., visible scribe marks.

A fir, 11 ins., bears S63°W, 29.5 ft. (45 lks.) dist., visible scribe marks.

Painted red bands around the bearing trees. Attached Land Survey Monument and Bearing Tree signs. Magnetic Declination: 20° East

II. Found a 2 1/2 in.s diam. iron pipe, 8 ins. above the ground with a 3 1/4 in. diam. BLM brass cap marked as shown above, from which

A larch snag, 6 ins. diam, bears S73°E, 19.5 ft. dist., visible scribe marks.

A fir, 10 ins. diam., bears S69°W, 29.5 ft. dist., visible scribe marks.

III. Establish 1 new bearing tree:

A fir, 10 ins. diam, bears S65°E, 22.8 ft. dist., mkd. T35N R27W CC S4 BT.

Painted red the scribed faces and 6 in. bands on the bearing trees. Attached Land Survey Monument and Bearing Tree signs.

Date of Fieldwork: 7/16/2007

Survey crew: Steve Boyer, Tom Hommel

Magnetic declination: 20° East assumed

Equipment used: Hand compass and loggers tape

U.S. Forest Service, Supervisors Office, 1101 Hwy. 2 West, Libby, MT 59923 (406) 293-6211

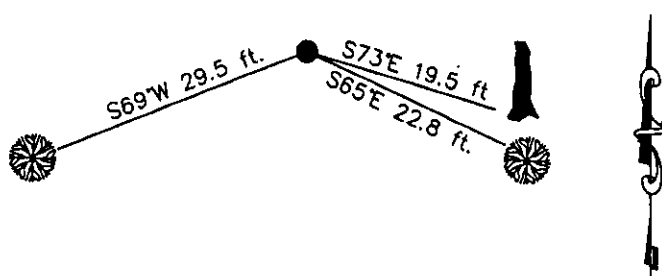

SKETCH OF CORNER

NOT TO SCALE

CERTIFICATION

I, Thomas M. Hommel 10800LS certify the information shown herein is true and correct.

Signature Ground Party Chief

I, Steven A. Boyer certify that this Corner Record correctly represents work performed by me or under my direction in compliance with the "Corner Recordation Act" (20-22-01, M.C.A.)

Signature of Surveyor & Seal STEVEN A. BOYER 9750LS

Date: 12/26/2007 Reg. No. 19750 REGISTERED

Employer: U. S. Forest Service SURVEYOR

Office of Clerk and Recorder, County of Lincoln

208435 BOOK: CCR CC&R'S PAGE: 11168 Pages: 1

STATE OF MONTANA LINCOLN COUNTY

RECORDED: 01/03/2008 1:56 KOI: CC&R'S

TAMMY D. LAUER CLERK AND RECORDER

FEE: \$0.00

BY: Lisa Blomdell, Deputy

TO: FILED

Sec. 4

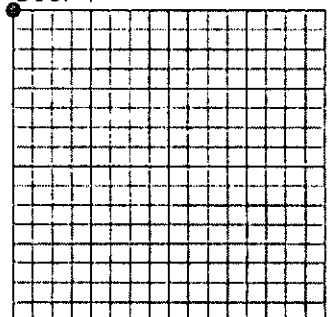

Cross Index No. A-9 T. 35N. R. 27W. P.M., MT

Adopted July 1, 1981, Montana Board of Professional Engineers & Land Surveyors

● corner this sheet