

CERTIFIED CORNER RECORDATION

Corner CNS 1/64 Sec. 13 T. 35N R. 27W P.M., MT Lincoln County

- I. No previous history.
- II. No evidence found.
- III. Set by survey, a 3/4 in. diam. x 30 ins. long aluminum rod, 25 ins. in the ground, in a small collar of stone, with a 3 1/4 in. diam. aluminum cap, mkd. as shown.

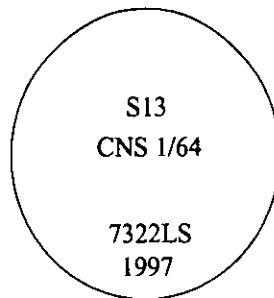

Established two bearing trees:

- A fir, 8 ins. diam., bears S05°W, 34.2 ft. dist., mkd. "X" on snowblaze "BT"
- A fir, 11 ins. diam., bears S42°W, 44.7 ft. dist., mkd. "CNS 1/64 S13 BT."

Painted bearing trees and attached Land Survey Monument and Bearing Tree signs.

Magnetic Declination: 20° East.

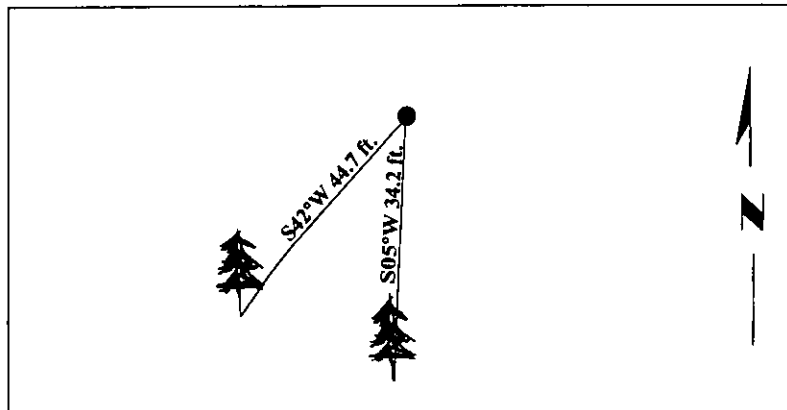

SKETCH OF CORNER

CERTIFICATION	
I, <u>Rex O. Rice</u>	certify the information shown herein is true and correct.
<u>Rex O. Rice</u>	
I, <u>Alvah F. Hughes</u>	certify that this Corner Record correctly represents work performed by me or under my direction in compliance with the "Corner Recordation Act" (70-22-101, et seq., M.C.A.)
<u>Alvah F. Hughes</u>	
Date: <u>07/24/97</u>	Signature of Surveyor & Seal
Reg. No.: <u>7322LS</u>	
Employer: <u>U.S. FOREST SERVICE</u>	

Office of Clerk and Recorder, County of Lincoln. This "corner record" was filed for record on 12-26-97 was noted on the cross-index plat and is assigned page No. 10037 in book No. _____

Coral M. Cummings R. R. S.
County Official

