

CERTIFIED CORNER RECORDATION

Corner 1/4 Sec. 25&36 T. 35N R. 27W P.M., MT Lincoln County

- I. 1913 G.L.O. Original Record by Royston C. Durnford et.al.: Set a slate stone, 14x12x10 ins., 10 ins. in the ground, for 1/4 sec. cor., mkd. "1/4" on N. face. Established two bearing trees.
- 1961 B.L.M. Remonumentation Record by David R. Cunningham et.al.: The 1/4 sec. cor. of secs. 25 & 36, monumented with a slate stone, 14x10x10 ins., loosely set, and mkd. "1/4" on the N. face, and witnessed by the original bearing trees. At the corner point, set an iron post, 30 ins. long, 2 1/2 in. diam., 26 ins. in the ground, in concrete, with a brass cap mkd. as shown.

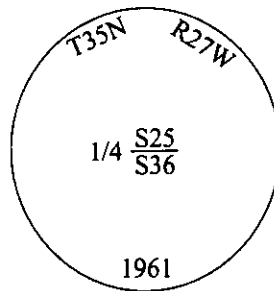

Established two new bearing trees and buried the original stone alongside the iron post.

- II. Found a B.L.M. brass cap, protruding 2 ins. above the ground, firmly set, mkd. as shown above, from which:

A dead fir, 25 ins. diam., bears N09°E, 34.3 ft. dist., with a healed face. (GLO-record)
 A larch, 21 ins. diam., bears S07°W, 40.1 ft. dist., with a healed face. (GLO-record)
 A larch, 14 ins. diam., bears S23°W, 52.3 ft. dist., with a healed face. (BLM-record)
 A larch, 10 ins. diam., bears N15°W, 33.3 ft. dist., with a healed face. (BLM-record)

- III. Painted bearing trees and attached Land Survey Monument and Bearing Tree signs.

Magnetic Declination: 20° East.

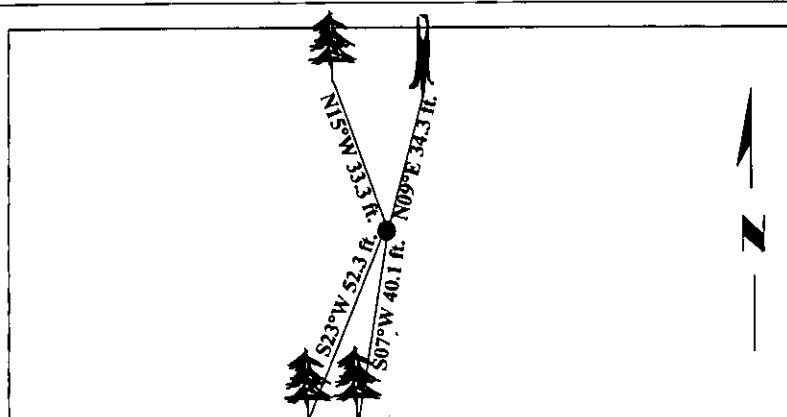

SKETCH OF CORNER

CERTIFICATION

I, Trish Bundrock
 certify the information shown herein is true and correct.

Alvah F. Hughes
 certify that this Corner Record correctly represents work performed by me or under my direction in compliance with the "Corner Recordation Act" (70-22-101, et seq., M.C.A.)

Alvah F. Hughes
 Signature of Surveyor & Seal

Date: 09/04/97

Reg. No.: 7322LS

Employer: U.S. FOREST SERVICE

Office of Clerk and Recorder, County of Lincoln. This "corner record" was filed for record on 1226 97 was noted on the cross-index plat and is assigned page No. 10031 in book No. _____

Coral M. Cunningham
 County Official

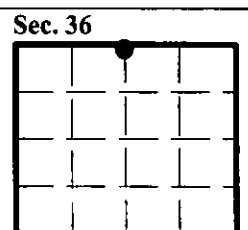

• - corner this sheet

Cross Index No. V-23 T. 35N R. 27W P.M., MT