

# CERTIFIED CORNER RECORDATION

Corner 1/4 Sec. 24&25 T. 35N R. 27W P.M., MT Lincoln County

- I. 1913 G.L.O. Original Record by Royston C. Durnford et.al.: Set a limestone, 12x10x8 ins., 8 ins. in the ground, for 1/4 sec. cor., mkd. "1/4" on the N. face.

Established two bearing trees:

A larch, 10 ins. diam., bears N31°E, 4 lks. dist., mkd. "1/4 S24 BT".  
A larch, 14 ins. diam., bears S42°W, 43 lks. dist., mkd. "1/4 S25 BT".

1961 B.L.M. Remonumentation Record by David R. Cunningham et.al.: The 1/4 sec. cor. of secs. 24 & 25, monumented with a limestone, 12x10x8 ins., firmly set, and mkd. "1/4" on the N. face, and witnessed by the original bearing trees. At the corner point, set an iron post, 30 ins. long, 2 1/2 in. diam., 26 ins. in the ground, in concrete, with a brass cap mkd. as shown.

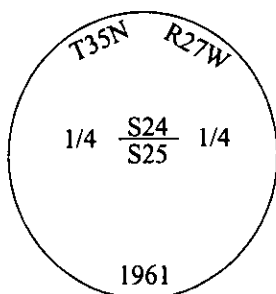

Established two new bearing trees and buried the original stone alongside the iron post.

- II. Found a B.L.M. brass cap, protruding 2 ins. above the ground, firmly set, mkd. as shown above.  
from which:

A larch, 17 ins. diam., bears N53°E, 3.3 ft. dist., with a healed face. (GLO-rec.-N31°E, 2.64 ft.)  
A larch, 12 ins. diam., bears S30°E, 64.4 ft. dist., with a healed face. (BLM-record)  
A rotten stump, bears S47°W, 26.3 ft. dist., with visible scribe. (GLO-rec.-S42°W, 28.38 ft.)  
A larch, 13 ins. diam., bears N71°W, 38.9 ft. dist., with a healed face. (BLM-record)

- III. Built up a collar of stone around the monument.

Painted bearing trees and attached Land Survey Monument and Bearing Tree signs.

Magnetic Declination: 20° East.

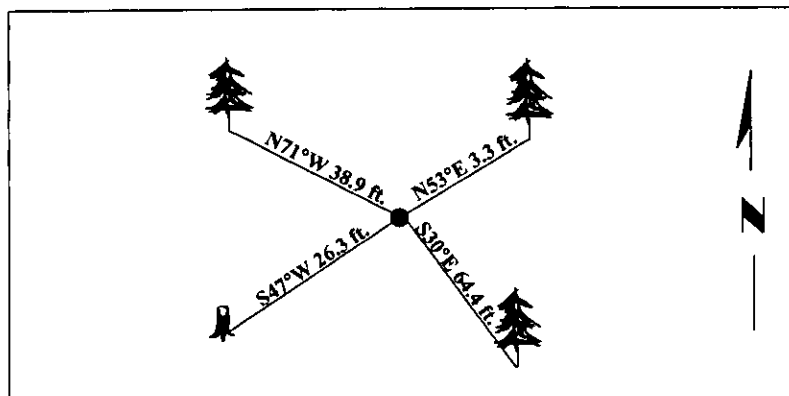

SKETCH OF CORNER

CERTIFICATION

I, Rex O. Rice  
certify the information shown herein is true and correct.

Rex O. Rice

I, Alvah F. Hughes  
certify that this Corner Record correctly represents work performed by me or under my direction in compliance with the "Corner Recordation Act" (70-22-101, et seq., M.C.A.)

Alvah F. Hughes  
Signature of Surveyor & Seal

Date: 09/04/97

Reg. No.: 7322LS

Employer: U.S. FOREST SERVICE

Office of Clerk and Recorder, County of Lincoln. This "corner record" was filed for record on 12-26-97 was noted on the cross-index plat and is assigned page No. 10030 in book No. \_\_\_\_\_

Coral M. Cunningham  
County Official

