

CERTIFIED CORNER RECORDATION

Corner C 1/4 Sec. 25 T. 35N R. 27W P.M., MT Lincoln County

- I. No previous history.
- II. No evidence found.
- III. Set by survey, a 30 ins. long, 2 1/2 in. diam. aluminum pipe, 25 ins. in the ground, with a 3 1/4 in. diam. aluminum cap mkd. as shown, with an "X" for the exact corner position.

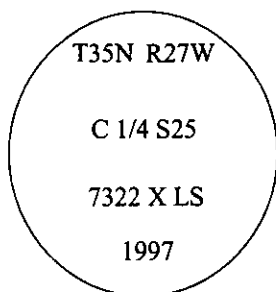

Established two bearing trees:

A fir, 10 ins. diam., bears N70°E, 50.5 ft. dist., mkd. "C 1/4 S25 BT".
A larch, 15 ins. diam., bears S22°W, 24.0 ft. dist., mkd. "C 1/4 S25 BT".

Painted bearing trees and attached Land Survey Monument and Bearing Tree signs.

Magnetic Declination: 20° East.

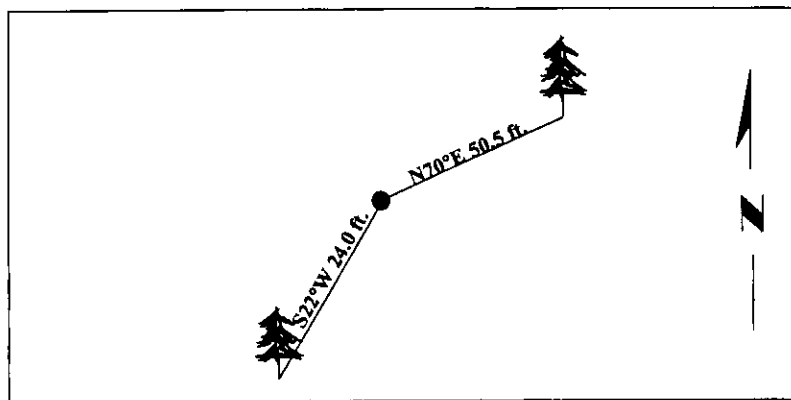

SKETCH OF CORNER

CERTIFICATION

I, Trish Bundrock
certify the information shown herein is true and correct.

I, Alvah F. Hughes
certify that this Corner Record correctly represents work performed by me or under my direction in compliance with the "Corner Recordation Act" (70-22-101, et seq., M.C.A.)

Alvah F. Hughes
Signature of Surveyor & Seal

Date: 10/07/97

Reg. No.: 7322LS

Employer: U.S. FOREST SERVICE

Office of Clerk and Recorder, County of Lincoln. This "corner record" was filed for record on 12-26-97 was noted on the cross-index plat and is assigned page No. 10016 in book No. _____

Coral M. Cunningham
County Official

