

CERTIFIED CORNER RECORDATION

Corner 1/4 Sec. 25&26 T. 35N R. 27W P.M., MT Lincoln County

- I. 1913 G.L.O. Original Record by Royston C. Durnford et.al.: Set a limestone, 14x8x6 ins., 10 ins. in the ground, for 1/4 sec. cor., mkd. "1/4" on the West face.

Established two bearing trees:

A larch, 14 ins. diam., bears N19 1/4°E, 68 lks. dist., mkd. "1/4 S25 BT".
A fir, 16 ins. diam., bears N70°W, 31 lks. dist., mkd. "1/4 S26 BT".

- II. Found a limestone, 8x6 ins., protruding 5 ins. above the ground, firmly set, mkd. "1/4" on the W. face.
from which:

A rotten stump, bears N19°E, 44.9 ft. dist., with a healed face.
A fir, 25 ins. diam., bears N70°W, 20.0 ft. dist., with a healed face.

- III. At the corner position, of original stone, set a 30 ins. long x 2 1/2 ins. diam. aluminum pipe, 23 ins. in the ground, with a 3 1/4 in. diam. aluminum cap, mkd. as shown. Buried the original found stone alongside the aluminum pipe.

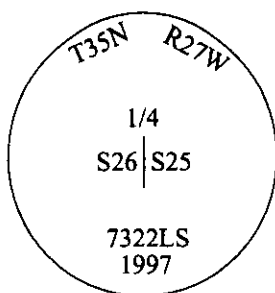

Established one new bearing tree:

A fir, 16 ins. diam., bears N40°E, 26.7 ft. dist., mkd. "1/4 S25 BT".

Painted bearing trees and attached Land Survey Monument and Bearing Tree signs.

Magnetic Declination: 20° East.

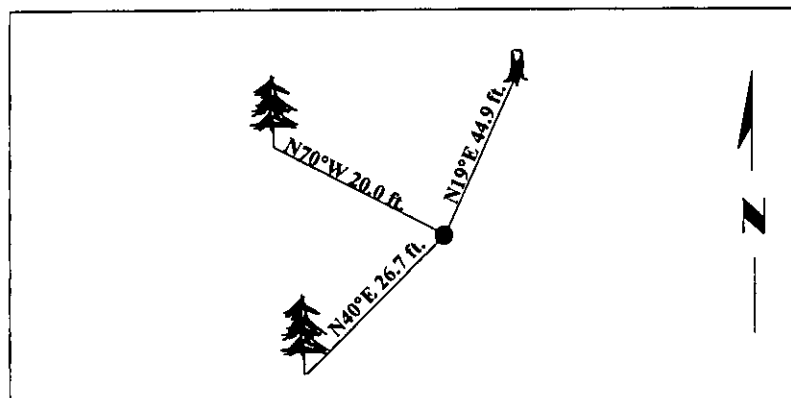

SKETCH OF CORNER

CERTIFICATION

I, Trish Bundrock
certify the information shown herein is true and correct.

I, Alvah F. Hughes
certify that this Corner Record correctly represents work performed by me or under my direction in compliance with the "Corner Recordation Act", (70-22-101, et seq., M.C.A.).

Alvah F. Hughes
Signature of Surveyor & Seal

Date: 10/06/97

Reg. No.: 7322LS

Employer: U.S. FOREST SERVICE

Office of Clerk and Recorder, County of Lincoln. This "corner record" was filed for record on 12-26-97 was noted on the cross-index plat and is assigned page No. 10015 in book No. _____

Carol M. Cummings By DLB
County Official

