

## INSTRUCTIONS

1. Original and/or subsequent record used to evaluate the corner position.
2. Description of evidence found, note discrepancies in the record, state method of establishing lost or obliterated corners.
3. Description of monument and accessories set to perpetuate the corner position.
4. Sketch of corner, show all pertinent data which can best be shown in a sketch example, corner marking, topography ties, position of accessories, etc.
5. Certification must be signed and sealed by Land Surveyor registered in the State of Montana.
6. Fill in Cross Index & Section Diagram at bottom of sheet.

## CERTIFIED CORNER RECORDATION

Corner 8 of HES 735 T. 34 N. R. 33 W. Lincoln County

- I. 1917 HES 735 record by Elmer R. Johnson: "Set for Cor. No. 8, a small stone marked with a cross(X) under a granite stone 24x7x4 ins., 14 ins. in the ground, marked 8 H.E.S. 735 on SE face and a cross (x) on top for exact corner point."

No bearings available, therefore dig pits 24x24x12 ins. crosswise on this and the succeeding course 7 ft. dist., and raise a mound of earth 4 ft. base, 2 ft. high, SE of corner.

- II. Found the top portion, 12x10x3 ins., mkd. 8 HES 735, of the original stone monument lying loose on top of the ground. Bottom of broken monument, 14x10x3 ins., found set upright buried in the ground. This position was checked by survey and accepted.

- III. At position of buried stone, set a 2 1/2 ins. diam. aluminum pipe, 24 ins. in the ground, with aluminum cap mkd. as shown.

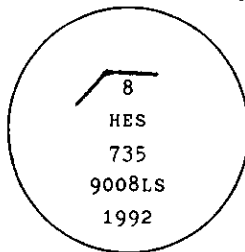

Established two new bearing trees:

- A larch, 20 ins. diam., bears S86° E, 38.2 ft. dist. Mkd. 8 HES 735 BT.  
A larch, 16 ins. diam., bears N4° W, 54.8 ft. dist. Mkd. 8 HES 735 BT.

Painted red bands around the bearing trees and attached "Land Survey Monument" and "Bearing Tree" signs. Set a galvanized steel gaurd post with "Land Survey Marker" and "Property Boundary" decals. S80° E, 3 ft.

Magnetic declination: 20° East

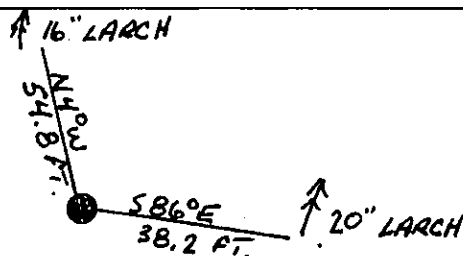
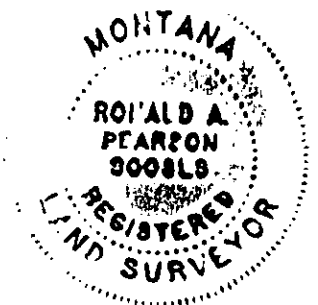

SKETCH OF CORNER

## CERTIFICATION

I, Kevin A. Todd  
certify the information shown herein is true and correct.

Kevin A. Todd  
Signature Ground Party Chief

I, Ronald A. Pearson  
certify that this Corner Record correctly represents work performed by me or under my direction in compliance with the "Corner Recordation Act" (70-22-101, et seq., M.C.A.)

Ronald A. Pearson  
Signature of Surveyor & Seal

Date: 11/16/92 Reg. No. 9008LS

Employer: U.S. FOREST SERVICE

Office of Clerk and Recorder, County of Lincoln. This "corner record" was filed for record on 12-7-92 was noted on the cross-index plat and is assigned page No. 5121, in book No. Coral M. Cummings

County Official

8 HES 735

34 N

33W

Cross Index No. \_\_\_\_\_ T. \_\_\_\_\_ R. \_\_\_\_\_ PMM

Sec. 27

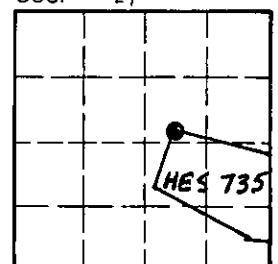

• - corner this sheet