

INSTRUCTIONS

1. Original and/or subsequent record used to evaluate the corner position.
2. Description of evidence found, note discrepancies in the record, state method of establishing lost or obliterated corners.
3. Description of monument and accessories set to perpetuate the corner position.
4. Sketch of corner, show all pertinent data which can best be shown in a sketch example, corner marking, topography ties, position of accessories, etc.
5. Certification must be signed and sealed by Land Surveyor registered in the State of Montana.
6. Fill in Cross Index & Section Diagram at bottom of sheet.

CERTIFIED CORNER RECORDATION

Corner 4 of HES 844 T. 34 N. R. 33 W. P.M.M. Lincoln County

- I. 1896 M.S. original record by Abram L. Jacqueth: "I commenced this survey at Cor. No. 1 where I set a post, 5 ins. square, 5 ft. long 2 ft. deep, marked 1-5024 for Cor. No. 1., from which

A blazed fir tree, 6 ins. in diam., marked 1-5024 B.T., bears $S74^{\circ}30'W$, 10 ft.

A blazed pine tree, 12 ins. in diam., marked 1-5024 B.T., bears $S30^{\circ}00'E$, 10 ft."

1917 H.E.S. record by E. R. Johnson: "Intersect cor. no. 1 of survey no. 5024 Evergreen placer, ... which is a post 5 ins. square, marked and witnessed as described by the Surveyor General.

As this corner is badly rotted I destroy it and in same place set for Cor. No. 4 of this survey and Cor. No. 1 of Survey No. 5024 a small stone marked with a cross (x) under a granite stone 26x9x9 ins., 16 ins. in the ground, marked 4 HES 844 on SW face, 1 MS 5024 on SE face, and a cross (x) on top for exact corner point, from which

A cross on a larch tree, 12 ins. dia., bears $S13^{\circ}15'E$, 150 lks. (99 ft.) dist.

A cross on a pine tree, 5 ins. dia., bears $S80^{\circ}00'W$, 34 lks. (22.44 ft.) dist. each blazed and scribed 4 HES 844 BT.

Raised a mound of stone, 4 ft. base, 2 ft. high, SW of corner."

- II. Found a 6x6 ins. stone, firmly set, protruding 8 ins. out of the ground, mkd. 4 HES 844 on SW face, 1 MS 5024 on SE face and a cross on top, from which

A larch, 26 ins. dia., bears $S13^{\circ}E$, 99 ft. dist., overgrown scribe.

A pine, 10 ins. dia., bears $S82^{\circ}W$, 22.7 ft. dist., mkd. 4 HES 844 BT.

- III. Painted red bands around the bearing trees and attached Land Survey Monument and Bearing Tree signs. Set a 6 ft. galvanized steel guard post with Land Survey Marker decal, North, 2 ft.

Magnetic declination: 20° East.

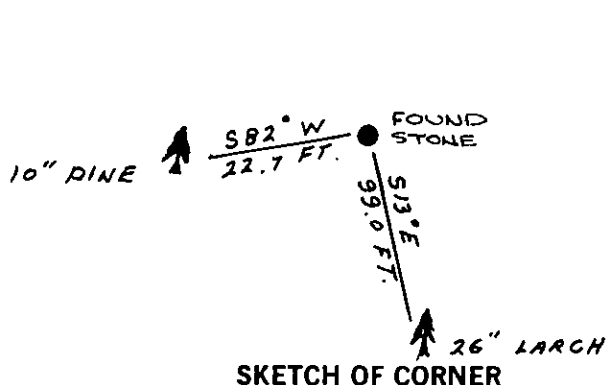
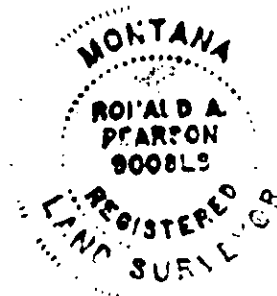

SKETCH OF CORNER

CERTIFICATION

- I. Gary C. Crismon
certify the information shown herein is true and correct.

Gary C. Crismon
Signature Ground Party Chief

- I. Ronald A. Pearson
certify that this Corner Record correctly represents work performed by me or under my direction in compliance with the "Corner Recordation Act" (70-22-101, et seq., M.C.A.)

Ronald A. Pearson
Signature of Surveyor & Seal

Date: 7/10/91 Reg. No. 9008 LS

Employer: U.S. FOREST SERVICE

Office of Clerk and Recorder, County of Lincoln. This "corner

record" was filed for record on Aug 13, 1991

was noted on the cross-index plat and is assigned page No. 4558, in

book No. _____

Coral M. Cummings by Bill Buckley
County Official

Cross Index No. 4 HES 844 T. 34 N. R. 33 W. P.M.M.

Sec. 16

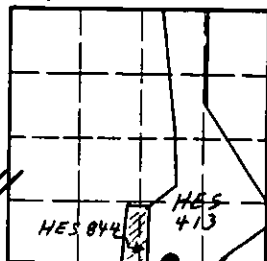

• - corner this sheet