

INSTRUCTIONS

1. Original and/or subsequent record used to evaluate the corner position.
2. Description of evidence found, note discrepancies in the record, state method of establishing lost or obliterated corners.
3. Description of monument and accessories set to perpetuate the corner position.
4. Sketch of corner, show all pertinent data which can best be shown in a sketch example, corner marking, topography ties, position of accessories, etc.
5. Certification must be signed and sealed by Land Surveyor registered in the State of Montana.
6. Fill in Cross Index & Section Diagram at bottom of sheet.

CERTIFIED CORNER RECORDATION

Corner Cor. 2 MS 4968B T. 34 N. R. 33 W. P.M.M. Lincoln County

- I. 1897 G.L.O. Original Record of the Keystone Lode MS 4968B Amended by Abram L. Jaqueth: "First Course N61 45'E at 523.4 feet: I set a post, 5 ins. square, 6 ft. long, 2 ft. deep, marked 2-4968 for Cor. No. 2.

A blazed spruce tree, 10 ins. in diam. marked 2-4968 BT bears S19°08'W, 7.0 feet.

A blazed spruce tree, 15 ins. in diam. marked 2-4968 BT bears N89°53'E, 14.2 feet."

- II. I found no evidence of either the corner post nor the bearing trees as the corner location falls in a tallings slope.

- III. At the determined corner position using the grant boundary method of proportion, I reestablished the corner position and set a aluminum pipe, 2 1/2 ins. diam., 30 ins. long, 28 ins. in the ground, with a 1/4 in. diam., aluminum cap, marked as shown, from which:

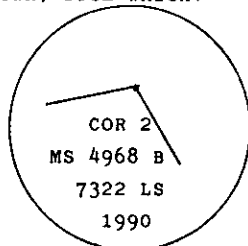

I established two new bearing trees.

A larch, 15 ins. diam., bears S67°W, 35.6 feet dist., scribed Cor.2 MS 4968B BT.

A larch, 13 ins. diam., bears N42°W, 9.9 feet dist., scribed Cor.2 MS 4968B BT.

Painted red bands around the bearing trees and attached Land Survey Monument and Bearing Tree signs. Set a 6 ft. galvanized steel guard post with Land Survey Marker and Property Boundary decals, NW. 3.0 ft.

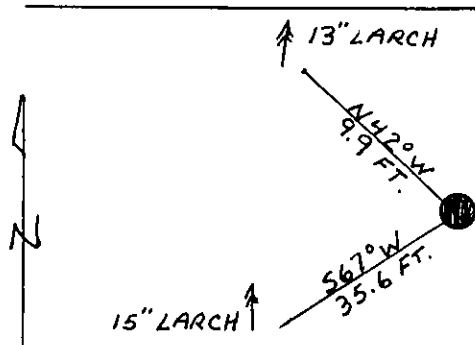

SKETCH OF CORNER

CERTIFICATION

I, Jane Eby
certify the information shown herein is true and correct.

Signature Ground Party Chief

I, Alvah F. Hughes

certify that this Corner Record correctly represents work performed by me or under my direction in compliance with the "Corner Recordation Act" (70-22-101, et seq., M.C.A.)

Alvah F. Hughes
Signature of Surveyor Seal HUGHES

Date: 01/15/91

Reg. No. 7322 LS

Employer: U.S. FOREST SERVICE

Office of Clerk and Recorder, County of Lincoln. This "corner record" was filed for record on May 2, 1991 was noted on the cross-index plat and is assigned page No. 4534, in book No. _____

Coral McComings by Bill Backoff
County Official

L. 70 8.80

34 N 33 W

Cross Index No. _____ T. _____ R. _____ P.M.M.

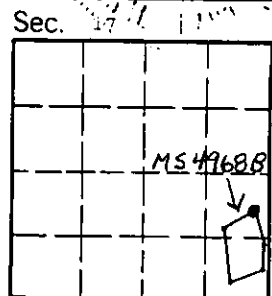

• corner this sheet