

## INSTRUCTIONS

1. Original and/or subsequent record used to evaluate the corner position.
2. Description of evidence found, note discrepancies in the record, state method of establishing lost or obliterated corners.
3. Description of monument and accessories set to perpetuate the corner position.
4. Sketch of corner, show all pertinent data which can best be shown in a sketch example, corner marking, topography ties, position of accessories, etc.
5. Certification must be signed and sealed by Land Surveyor registered in the State of Montana.
6. Fill in Cross Index & Section Diagram at bottom of sheet.

## CERTIFIED CORNER RECORDATION

Corner 6 of HES 413 T. 34 N. R. 33 W. P.M.M. Lincoln County

- I. 1915 H.E.S. original record by E. R. Johnson: Set a sandstone 24 by 10 by 6 ins., 14 ins. in the ground, mkd. 6 HES 413 on SW face, and a cross on top for the exact corner point, from which
- A cross on a cedar 10 ins. dia., bears  $N43^{\circ}02'E$ , 10 lks. (6.60 ft.) dist.
- A cross on a cedar 15 ins. dia., bears  $S48^{\circ}15'W$ , 19 lks. (12.54 ft.) dist.
- Each blazed and scribed 6 HES 413 BT.
- Raised a mound of earth, 4 ft. base, 2 ft. high, SW of corner.

- II. Found a 10 by 6 ins. stone, firmly set, protruding 6 ins. out of the ground, mkd. 6 HES 413 on SW face and a cross on top, from which
- A stump hole, bears  $N48^{\circ}E$ , 6.5 ft. dist.
- A cedar, 31 ins. dia., bears  $S48^{\circ}W$ , 12.7 ft. dist., mkd. 6 HES 413.

- III. Established one new bearing tree.
- A hemlock, 6 ins. dia., bears East, 6.5 ft. dist., mkd. 6 HES 413 BT.

Painted red bands around the bearing trees and attached Land Survey Monument and Bearing Tree signs.

Set a 6 ft. galvanized steel guard post with Land Survey Marker and Property Boundary decals,  $S31^{\circ}E$ , 3 ft.

Magnetic declination:  $20^{\circ}$  East.

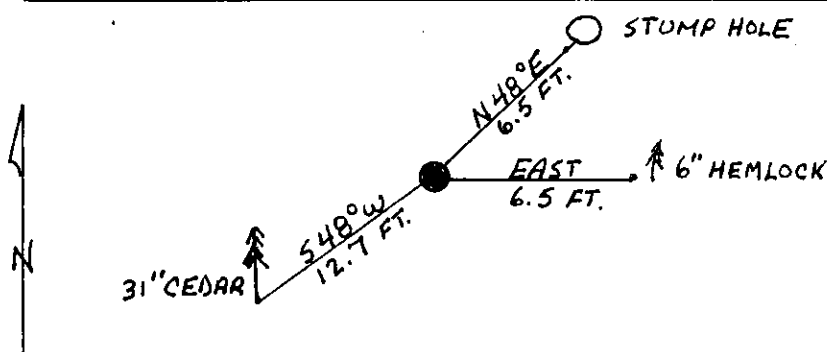

SKETCH OF CORNER

## CERTIFICATION

- I. Kevin A. Todd  
certify the information shown herein is true and correct.

Kevin A. Todd  
Signature Ground Party Chief

- I. Alvah F. Hughes  
certify that this Corner Record correctly represents work performed by me or under my direction in compliance with the "Corner Recordation Act" (70-22-101, et seq., M.C.A.).

Alvah F. Hughes  
Signature of Surveyor & Seal

Date: 1/8/91 Reg. No. 7322

Employer: U.S. FOREST SERVICE

Office of Clerk and Recorder, County of Lincoln. This "corner record" was filed for record on 1-10-91 was noted on the cross-index plat and is assigned page No. 4477, in book No. Coral M. Cummings by Eric Bruch

County Official

6 HES 413

34 N 33 W

Cross Index No. T. R. PMM

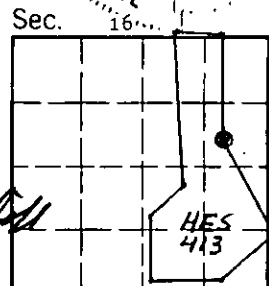

• - corner this sheet