

INSTRUCTIONS

1. Original and/or subsequent record used to evaluate the corner position.
2. Description of evidence found, note discrepancies in the record, state method of establishing lost or obliterated corners.
3. Description of monument and accessories set to perpetuate the corner position.
4. Sketch of corner, show all pertinent data which can best be shown in a sketch example, corner marking, topography ties, position of accessories, etc.
5. Certification must be signed and sealed by Land Surveyor registered in the State of Montana.
6. Fill in Cross Index & Section Diagram at bottom of sheet.

CERTIFIED CORNER RECORDATION

Corner 4 of HES 413 T. 34 N. R. 33 W. P.M.M. Lincoln County

- I. 1915 H.E.S. original record by E. R. Johnson: Set a sandstone 36 by 10 by 10 ins., 26 ins. in the ground, mkd. 4 HES 413 on SE face, and a cross on top for the exact corner point. No bearings available, and pits impracticable. Raise a mound of stone 4 ft. base, 2 ft. high, E. of corner.
- II. Found a 7 by 6 ins. sandstone, firmly set, protruding 7 ins. out of the ground. Stone mkd. 4 HES 413 on SE face and a cross on top. On the NE face, stone is mkd. 1 HES 1165. Mound of stone not found, possibly due to the proximity of the Yaak River. I accept this position as being original without a supporting survey tie.
- III. Established two new bearing trees
 A cedar, 15 ins. dia., bears $S77^{\circ}E$, 18.3 ft. dist., mkd. 4 HES 413 BT.
 A cedar, 15 ins. dia., bears $S1^{\circ}W$, 29.7 ft. dist., mkd. 4 HES 413 BT.

Painted red bands around the bearing trees and attached Land Survey Monument and Bearing Tree signs.
 Set a 6 ft. galvanized steel guard post with Land Survey Marker and Property Boundary decals, East, 3 ft.
 Magnetic declination: 20° East.

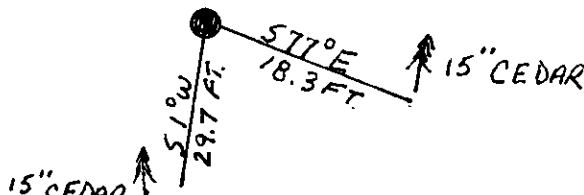

SKETCH OF CORNER

CERTIFICATION

I, Ray Pederson
 certify the information shown herein is true and correct.

Signature Ground Party Chief

I, Alvah F. Hughes
 certify that this Corner Record correctly represents work performed by me or under my direction in compliance with the "Corner Recordation Act" (70-22-101, et seq., M.C.A.).

Alvah F. Hughes
 Signature of Surveyor & Seal

Date: 1/8/91 Reg. No. 7322

Employer: U.S. FOREST SERVICE

Office of Clerk and Recorder, County of Lincoln. This "corner record" was filed for record on 1-10-91 was noted on the cross-index plat and is assigned page No. 4475, in book No. Coral M Cummings by Eric Buck

County Official

4 HES 413

34 N 33 W

Cross Index No. T. R. PMM

Sec. 16

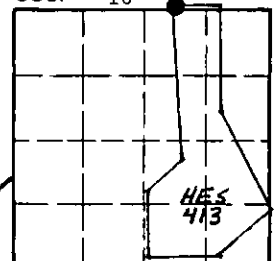

• - corner this sheet