

INSTRUCTIONS

1. Original and/or subsequent record used to evaluate the corner position.
2. Description of evidence found, note discrepancies in the record, state method of establishing lost or obliterated corners.
3. Description of monument and accessories set to perpetuate the corner position.
4. Sketch of corner, show all pertinent data which can best be shown in a sketch example, corner marking, topography ties, position of accessories, etc.
5. Certification must be signed and sealed by Land Surveyor registered in the State of Montana.
6. Fill in Cross Index & Section Diagram at bottom of sheet.

CERTIFIED CORNER RECORDATION

Corner 1 of HES 413 T. 34 N. R. 33 W. Lincoln County

- I. 1915 H.E.S. original record by E. R. Johnson: Set a sandstone 24 by 10 by 6 ins., 14 ins. in the ground, mkd. 1 HES 413 on SE face, and a cross on top for the exact corner point. No bearings available, therefore dig pits 24 by 24 by 12 ins. crosswise on this and the succeeding course 7 ft. dist., and raise a mound of earth, 4 ft. base, 2 ft. high, SE of corner.
- II. Found a 5 by 5 ins. sandstone, firmly set, protruding 6 ins. out of the ground, mkd. 1 HES 413 on SE face and a cross on top. Logging activity has destroyed pits and mound. I accept this position as being original, without a supporting survey tie.
- III. Established two new bearing trees
 A larch, 10 ins. dia., bears N21° E, 21.2 ft. dist., mkd. 1 HES 413 BT.
 A larch, 15 ins. dia., bears N55° W, 55.1 ft. dist., mkd. 1 HES 413 BT.

Painted red bands around the bearing trees and attached Land Survey Monument and Bearing Tree signs.
 Set a 6 ft. galvanized steel guard post with Land Survey Marker and Property Boundary decals, N51° E, 3 ft.
 Magnetic declination: 20° East.

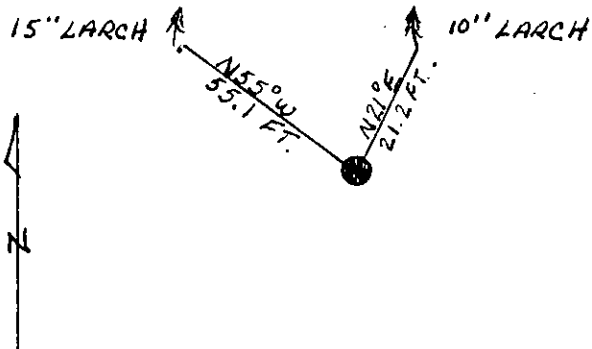

SKETCH OF CORNER

CERTIFICATION

I, Ray Pederson
 certify the information shown herein is true and correct.

Signature Ground Party Chief

I, Alvah F. Hughes

certify that this Corner Record correctly represents work done by me or under my direction in compliance with the "Corner Recordation Act" (70-22-101, et seq., M.C.A.)

Signature of Surveyor Alvah F. Hughes

Date: 1/8/91 Reg. No. 7322 LS

Employer: U.S. FOREST SERVICE

Office of Clerk and Recorder, County of Lincoln. This "corner record" was filed for record on 1-10-91 was noted on the cross-index plat and is assigned page No. 4472, in book No. _____

Coral M. Cummings by Bill Buckhoff
 County Official

1 HES 413 34 N 33 W
 Cross Index No. _____ T. _____ R. _____ PMM

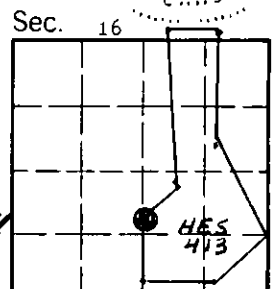

• - corner this sheet