

INSTRUCTIONS

1. Original and/or subsequent record used to evaluate the corner position.
2. Description of evidence found, note discrepancies in the record, state method of establishing lost or obliterated corners.
3. Description of monument and accessories set to perpetuate the corner position.
4. Sketch of corner, show all pertinent data which can best be shown in a sketch example, corner marking, topography ties, position of accessories, etc.
5. Certification must be signed and sealed by Land Surveyor registered in the State of Montana.
6. Fill in Cross Index & Section Diagram at bottom of sheet.

CERTIFIED CORNER RECORDATION

Corner 1 of HES 845 T. 34 N. R. 33 W. P.M.M. Lincoln County

- I. 1917 H.E.S. original record by E. R. Johnson: "Set a small stone, marked with a cross (x); under a sandstone 26x10x8 ins., 16 ins. in the ground, marked 1 HES 845 on E face and a cross (x) on top for exact corner point, from which

A cross (x) on an alder tree, 6 ins. dia., bears $S65^{\circ}15'W$, 13 links distant.

A cross (x) on an alder tree, 6 ins. dia., bears $S44^{\circ}00'E$, 20 links distant; each blazed and scribed 1 HES 845 BT.

Raise a mound of stone 4 ft. base, 2 ft. high, East of corner."

- II. Found a set stone, loose and leaning, 9x7 ins., 10 ins. out of ground, marked 1 HES 845 on E face and a X on top. No evidence of bearing trees or mound of stone as corner falls in Yaak river flood plain. Searched for small stone memorial, marked with a cross (x), underneath stone monument. Excavated in sandy soil to a 24 in. depth; however, the small stone was not found.

- III. Reset the stone monument in found position, 10 ins. out of ground, as true original position can not be verified, except by survey.

Established two new bearing trees to perpetuate present location of stone; however, not necessarily the correct position of Cor. 1:

A cedar, 17 ins. dia., bears $S4^{\circ}E$, 33.9 ft. dist., scribed 1 HES 845 BT.

A cedar, 21 ins. dia., bears $S49^{\circ}W$, 51.2 ft. dist., scribed 1 HES 845 BT.

Painted red bands around the bearing trees and attached Land Survey Monument and Bearing Tree signs.

Set a 6 ft. galvanized steel guard post with Land Survey Marker and Property Boundary decals, $S29^{\circ}E$, 3 ft. Magnetic declination: $20^{\circ}30'$ East.

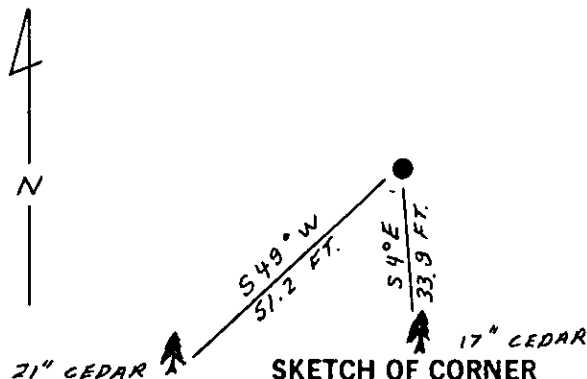

CERTIFICATION

I, Gary C. Crismon
certify the information shown herein is true and correct.

Gary C. Crismon
Signature Ground Party Chief

I, Alvah F. Hughes
certify that this Corner Record correctly represents work performed by me or under my direction in compliance with the Corner Recordation Act" (70-22-101, et seq., M.C.A.)

Alvah F. Hughes
Signature of Surveyor

Date: 12/27/89 Reg. No. 7322

Employer: U.S. FOREST SERVICE

Office of Clerk and Recorder, County of Lincoln. This "corner record" was filed for record on Jan 9, 1990

was noted on the cross-index plat and is assigned page No. 4199, in book No. _____

County Official [Signature]

Cross Index No. 1 HES 845 T. 34 N R. 33 W P.M.M.

Sec. 5

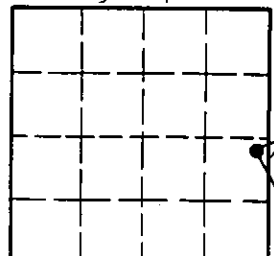

• - corner this sheet