

INSTRUCTIONS

1. Original and/or subsequent record used to evaluate the corner position.
2. Description of evidence found, note discrepancies in the record, state method of establishing lost or obliterated corners.
3. Description of monument and accessories set to perpetuate the corner position.
4. Sketch of corner, show all pertinent data which can best be shown in a sketch example, corner marking, topography ties, position of accessories, etc.
5. Certification must be signed and sealed by Land Surveyor registered in the State of Montana.
6. Fill in Cross Index & Section Diagram at bottom of sheet.

CERTIFIED CORNER RECORDATION

Corner 4 of HES 845 T. 34 N. R. 33 W. P.M.M. Lincoln County

- I. 1917 H.E.S. original record by E. R. Johnson: "Set a small stone, marked with a cross (x) under a sandstone 24x10x6 ins., 14 ins. in the ground marked 4 HES 845 on SW face and a cross (x) on top for exact corner point, from which
- A cross (x) on a larch tree, 6 ins. dia., bears N84°30'E, 25 lks. dist.
- A cross (x) on a larch tree, 6 ins. dia., bears S15°45'W, 19 lks. dist.; each blazed and scribed 4 HES 845 BT.
- Raise a mound of earth 4 ft. base, 2 ft. high SW of corner."
- 1982 C.O.S. record by M. D. Lauteren Reg. No. 4232-S: "Pd original rock 6x8x15 ins. and spruce BT"
- II. Found, a set stone, 6x9 ins., 6 ins. out of ground, marked 4 HES 845 on SW face and X on top, from which
- A larch, 11 ins. dia., bears N84°E, 16.6 ft. (25.1 lks.) dist., scribe overgrown.
- A larch, 19 ins. dia., bears S17°W, 12.5 ft. (18.9 lks.) dist., scribe overgrown.
- A mound of earth, 3 ft. dia., 1 ft. high, bears S50°W, 3.5 ft. dist.
- III. Painted red bands around the bearing trees and attached Land Survey Monument and Bearing Tree signs.
- Set a 6 ft. galvanized steel guard post with Land Survey Marker and Property Boundary decals, N49°W, 3 ft.
- Magnetic Declination: 20°30' East

CERTIFICATION

I, Gary C. Crismon
certify the information shown herein is true and correct.

Gary C. Crismon
Signature Ground Party Chief

I, Alvah F. Hughes
certify that this Corner Record correctly represents work performed by me or under my direction in compliance with the "Corner Recordation Act" (70-22-101, et seq., M.C.A.)

Alvah F. Hughes
Signature of Surveyor & Seal

Date: 12/28/89 Reg. No. 7322

Employer: U.S. FOREST SERVICE

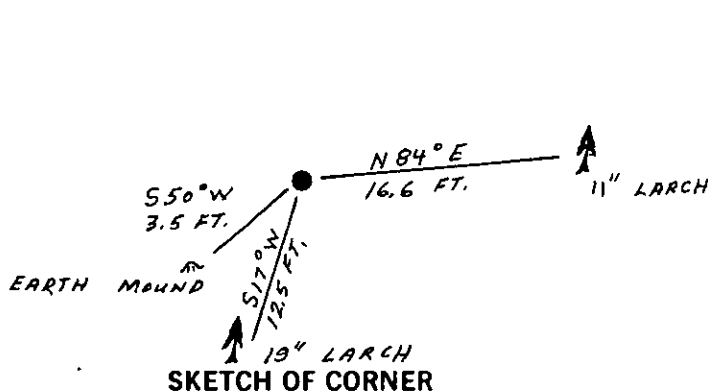

SKETCH OF CORNER

Office of Clerk and Recorder, County of Lincoln. This "corner record" was filed for record on Jan 9, 1990 was noted on the cross-index plat and is assigned page No. 4197 in book No. _____

Cross Index No. 4 HES 845 T. 34 N R. 33 W P.M.M.

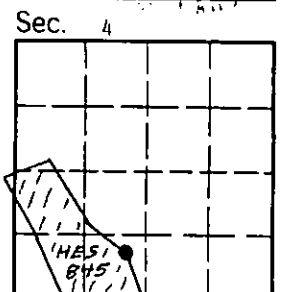

• - corner this sheet