

INSTRUCTIONS

1. Original and/or subsequent record used to evaluate the corner position.
2. Description of evidence found, note discrepancies in the record, state method of establishing lost or obliterated corners.
3. Description of monument and accessories set to perpetuate the corner position.
4. Sketch of corner, show all pertinent data which can best be shown in a sketch example, corner marking, topography ties, position of accessories, etc.
5. Certification must be signed and sealed by Land Surveyor registered in the State of Montana.
6. Fill in Cross Index & Section Diagram at bottom of sheet.

CERTIFIED CORNER RECORDATION

Corner 5 of HES 845 T. 34 N. R. 33 W. P.M.M. Lincoln County

- I. 1917 H.E.S. record by E. R. Johnson: "A granite ledge, 6x5x4 ft. . . . adopt this ledge for Cor. No. 5 of this survey, and mark it 5 HES 845 on NW face and a cross (x) on top for exact corner point, from which

A cross (x) on a larch tree, 5 ins. dia., bears S77° 30' W, 84 lks. dist.

A cross (x) on a white pine tree, 6 ins. dia., bears S1° 30' E, 66 lks. dist.; each blazed and scribed 5 HES 845 BT.

Raise a mound of stone 4 ft. base, 2 ft. high, NW of corner."

1982 C.O.S. No. 1053 by M. D. Lauteren Reg. No. 4232-S: "Rock outcrop with X"

- II. Found, a rock outcrop, 19x7x4 ft., marked X ← on top and 5 HES 845 on NW face, from which

A white pine, 16 ins. dia., bears S2° W, 43.5 ft. (65.9 lks.) dist., scribe overgrown.

A mound of stone, 4 ft. dia, 1 ft. high, bears Northwest, 7 ft. dist.

- III. Established one new bearing tree:

A larch, 10 ins. dia., bears N87° E, 23.8 ft. dist., scribed 5 HES 845 BT.

Painted red bands around the bearing trees and attached Land Survey Monument and Bearing Tree signs.

Set a 6 ft. galvanized steel guard post with Land Survey Marker and Property Boundary decals, N81° W, 7 ft.

Magnetic Declination: 20° 30' East

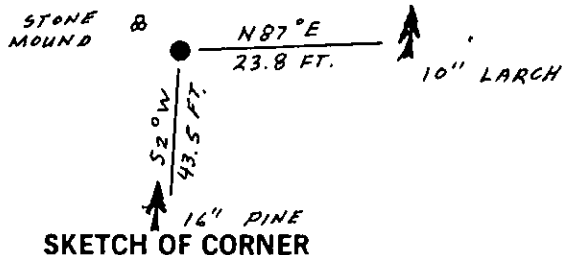
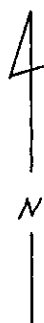

CERTIFICATION

I, Gary C. Crismon
certify the information shown herein is true and correct.

Gary C. Crismon
Signature Ground Party Chief

I, Alvah F. Hughes
certify that this Corner Record correctly represents work performed by me or under my direction in compliance with the Montana Recordation Act" (70-22-10), et seq., M.C.A.;

Alvah F. Hughes
Signature of Surveyor

Date: 12/28/89 Reg. No. 7322

Employer: U.S. FOREST SERVICE

Office of Clerk and Recorder, County of Lincoln. This "corner record" was filed for record on Jan 9, 1990

was noted on the cross-index plat and is assigned page No. 4195, in

book No. _____

Paul F. Sigel by Dill Sigel
County Official

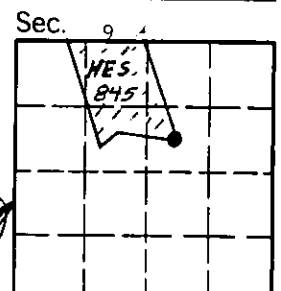

Cross Index No. 5 HES 845 T. 34 N R. 33 W P.M.M.

• - corner this sheet