

INSTRUCTIONS

1. Original and/or subsequent record used to evaluate the corner position.
2. Description of evidence found, note discrepancies in the record, state method of establishing lost or obliterated corners.
3. Description of monument and accessories set to perpetuate the corner position.
4. Sketch of corner, show all pertinent data which can best be shown in a sketch example, corner marking, topography ties, position of accessories, etc.
5. Certification must be signed and sealed by Land Surveyor registered in the State of Montana.
6. Fill in Cross Index & Section Diagram at bottom of sheet.

CERTIFIED CORNER RECORDATION

Corner 6 of HES 845 T. 34 N. R. 33 W. P.M.M. Lincoln County

- I. 1917 H.E.S. original record by E. R. Johnson: "Set a small stone, marked with a cross (x), under a limestone, 26x9x5 ins., 16 ins. in the ground, marked 6 HES 845 on NW face and a cross (x) on top for exact corner point, from which

A cross (x) on a larch tree, 6 ins. dia., bears $N86^{\circ}30'W$, 66 lks. dist.

A cross (x) on a pine tree, 6 ins. dia., bears $S12^{\circ}00'W$, 49 lks. dist.; each blazed and scribed 6 HES 845 BT.

Raise a mound of earth 4 ft. base, 2 ft. high, NW of corner.

1982 C.O.S. No. 1053 by M. D. Lauteren Reg. No. 4232-S: "Fd. original rock 4x6x15 ins."

- II. Found a set stone, 5x7 ins., 5 ins. out of the ground, marked 6 HES 845 on N face and X on top, from which

A saw stump, 12 ins. dia., bears $N85^{\circ}W$, 49.0 ft. (74 lks., rcd. 66 lks.) dist., T scribe is visible.

A dead pine, 11 ins. dia., bears $S13^{\circ}W$, 33.8 ft. (51.2 lks.) dist., 6 HES 845 BT is visible.

- III. Established two new bearing trees:

A cedar, 7 ins. dia., bears $S7^{\circ}W$, 39.7 ft. dist., scribed 6 HES 845 BT.

An alpine fir, 4 ins. dia., bears $S61^{\circ}W$, 19.5 ft. dist., scribed X BT.

Painted red bands around the bearing trees and attached Land Survey Monument and Bearing Tree signs.

Set a 6 ft. galvanized steel guard post with Land Survey Marker and Property Boundary decals, $S48^{\circ}W$, 3 ft.

Magnetic Declination: $20^{\circ}30'$ East

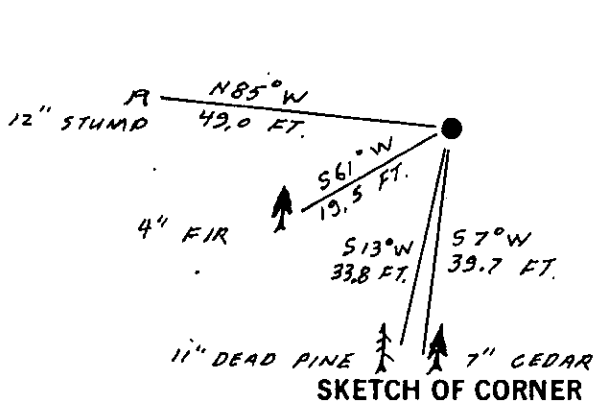

CERTIFICATION

I, Gary C. Crismon
certify the information shown herein is true and correct.

Gary C. Crismon
Signature Ground Party Chief

I, Alvah F. Hughes
certify that this Corner Record correctly represents work performed by me or under my direction in compliance with the "Corner Recordation Act" (70-22-101, et seq., M.C.A.)

Alvah F. Hughes
Signature of Surveyor

Date: 12/28/89 Reg. No. 7322-481322-13

Employer: U.S. FOREST SERVICE

Office of Clerk and Recorder, County of Lincoln. This "corner record" was filed for record on Jan 9, 1990 was noted on the cross-index plat and is assigned page No. 4194, in book No. _____

Cross Index No. 6 HES 845 T. 34 N R. 33 W P.M.M.

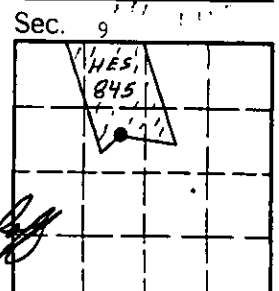

• - corner this sheet