

INSTRUCTIONS

Q:CO-STD/152
Created 4/8/92

1. Original ar
2. Descriptio
3. Descriptio
4. Sketch of c
5. Certificatio
6. Fill in Cro

179990 BOOK: CCR CC&R'S PAGE: 10671 Pages: 1
STATE OF MONTANA LINCOLN COUNTY
RECORDED: 10/18/2004 9:08 KOI: CC&R'S
CORAL M. CUMMINGS CLERK AND RECORDER
FEE: \$0.00
TO: FILED

obliterated corners.

ig. topography ties, position of accessories,

BY: *Jeannie Denny*
Deputy

CERTIFIED CORNER RECORDATION

Corner Secs. 20, 21, 28 & 29 T. 34 North R. 34 West P.M.M. LINCOLN County

RECORD:

GLO 1903: Set a limestone, 15"x10"x4", 10" in the ground for the corner of Sections 20, 21, 28 & 29, marked with 2 notches on the S. and 4 notches on the E. edges.

From which:

A 8" Pine, bears N.21 1/2°E., 5 links, marked: T34N R34W S21 BT.

A 7" Fir, bears S.12°E., 13 links, marked: T34N R34W S28 BT.

A 9" Cedar, bears S.63 1/2°W., 29 links, marked: T34N R34W S29 BT.

A 12" Pine, bears N.87°W., 20 links, marked: T34N R34W S20 BT.

11/1979 U.S.D.A. Forest Service corner card. Found stone with BT on top of monument.

A 18" Fir, S.12°E., 13 lks., with healed blaze.

A 18" Cedar, S.63°W., 8 lks., scribing visible.

Pine, dead & standing, N.87°W., 18 lks., scribing visible.

7/1994 Plat of Chapman Acres, Plat No. 5167 (Davis, 4975S). Found original GLO stone.

FOUND:

7/2004

Found fractured stone (5"x8", with 4 notches visible on face), lying loose on the ground with the remainder of the stone still firmly set. I pull remains of the original stone and remonument with a 2-1/2"x30" aluminum pipe, set 24" in the ground with a 3-1/4" U.S.D.A. aluminum cap. Raise a 20" diameter collar of stone around the monument and bury the remains of the original stone alongside. Place 6' tall galvanized post with "Survey Monument" decal 1' SW. of corner.

From which the remains of the record BT's:

A 8" rotted Pine snag, dead and down, lying alongside corner, with scribing visible on rotted blaze.

A 16" Fir, bears S.12°E., 8.6', with a healed blaze.

A 17" Cedar, bears S.63 1/2°W., 5.3' (19.14' Record), with "4 S29 BT" visible on a partially open blaze.

From which the new bearing trees:

A 13" Fir, bears N.55°E., 12.4', marked: T34N R34W S21 BT.

A 7" Fir, bears N.16°W., 10.8', marked: T34N R34W S20 BT.

Paint blaze and 6" band and posted "Bearing Tree" and "Land Survey Monument" on bearing trees.

See Certificate of Survey on file at the Lincoln County Courthouse.

CERTIFICATION

I, Jason Culp
certify the information shown herein is true and correct.*Jason Culp*
Signature Ground Party ChiefI, Richard A. Ainsworth
certify that this Corner Record correctly
represents work performed by me or under my
direction in compliance with the "Corner
Recordation Act" (70-22-101, et seq., M.C.A.)*Richard A. Ainsworth*
Signature of Surveyor & Seal
2923 S

Date: 7/2004

Reg. No. 2923 S

Employer: Professional Consultants, Inc.

Sec. 28

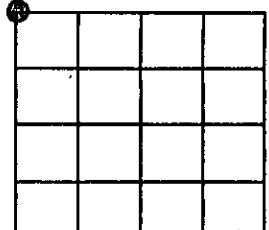

SKETCH OF CORNER

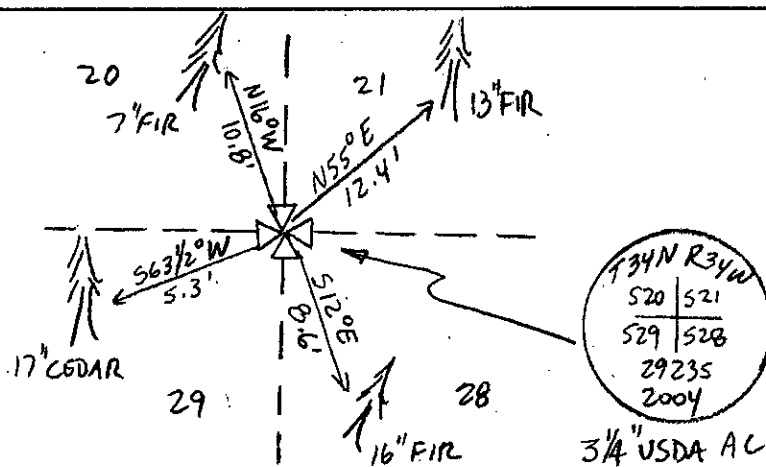
Office of Clerk and Recorder, County of LINCOLN. This "corner record" was filed for record on 10-18-04was noted on the cross-index plat and is assigned page No. 179990, inbook No. 10671

page

Jeannie Denny
County Official