

CERTIFIED CORNER RECORDATION

Corner **HES 1065** Sec. **21** T. **34N** R. **34W** P.M., MT **Lincoln** County
Cor. 1

- I. 1921 Homestead Entry No. 1065 by Grant Higgins: Beginning at listing cor. No. 5, mkd. and witnessed as described by the District Forester. I destroy the listing cor. and its accessories and in its place, establish cor. No. 1 of this survey, as follows: Place a small stone, mkd. with a cross (x) under a sandstone, 24x15x6 ins., 14 ins. in the ground, mkd. "1 HES 1065", on SE face and a cross (x) on top for the exact corner point.

Established two bearing trees:

- A cross (x) on a white pine tree, 6 ins. diam., bears N31°57'E, 22 lks. dist.
- A cross (x) on a white pine tree, 8 ins. diam., bears S66°38'W, 26 lks. dist.

Each bearing tree is blazed and scribed "1 HES 1065 BT.

Raise a mound of earth and stone, 4.0 ft. base, 2.0 ft. high, SE of the corner.

1980 U.S.F.S. Certified Corner Recordation by Thomas C. Hill, No. 5612S: Found a sandstone, 13x6 in., 4 ins. above the ground, with an "x" mkd. on top and "1 HES 1065" on SE face and witnessed by the remains of the 1921 bearing trees. Highlighted "x" with red paint and established on new bearing tree.

- II. Found a 6x14 in. stone, protruding 5 ins. above the ground, firmly set, mkd. "1 HES 1065" on the SE face, with an "x" on top and witnessed by the remains of one original and the 1980 bearing tree and a mound of stone SE of the corner.

from which:

- A cedar, 16 ins. diam., bears N02°E, 20.9 ft. dist., with visible scribe. (1980-record)
- A pine stump, 12 ins. diam., bears S66°W, 16.9 ft. dist., with visible scribe. (1921-record)

- III. Established one new bearing tree:

A cedar, 16 ins. diam., bears N35°E, 21.1 ft. dist., mkd. "1 HES 1065 BT".

Painted the chiseled SE face of the stone and "x" on top red.

Painted bearing trees and attached Land Survey Monument and Bearing Tree signs.

Magnetic Declination: 20° East.

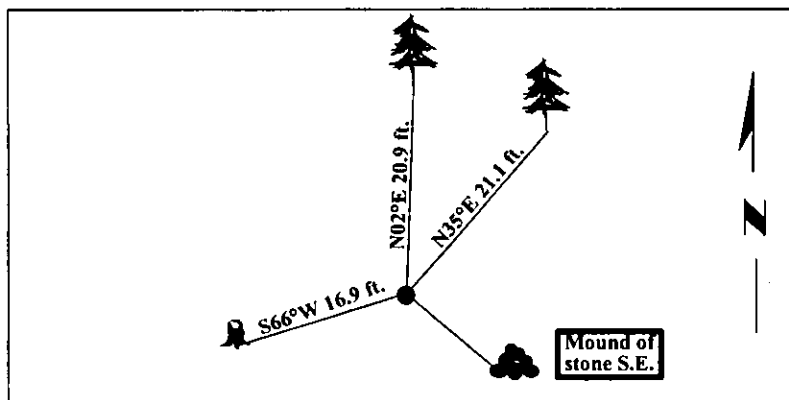

SKETCH OF CORNER

CERTIFICATION

I, **Rex O. Rice**

certify the information shown herein is true and correct.

Rex O. Rice

I, **Steven A. Boyer**

certify that this Corner Record correctly represents work performed by me or under my direction in compliance with the "Corner Recordation Act" (70-22-101, et seq., M.C.A.)

Steven A. Boyer
Signature of Surveyor & Seal

Date: **08/17/98**

Reg. No.: **9750LS**

Employer: **U.S. FOREST SERVICE**

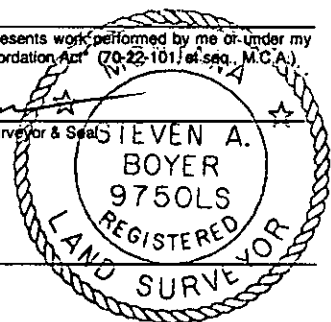

Office of Clerk and Recorder, County of Lincoln. This "corner record" was filed for record on 10/19/98 was noted on the cross-index plat and is assigned page No. 10249 in book No. _____

Coral M. Cummings By SLS
County Official

Sec. 21

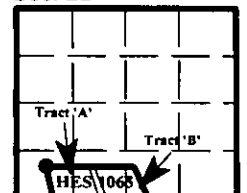

• - corner this sheet

Index No.

Cross **HES 1065 Cor. 1** T. **34N** R. **34W** P.M., MT