

CERTIFIED CORNER RECORDATION

Corner **HES 1065** Sec. **21** T. **34N** R. **34W** P.M., MT Lincoln County
Cor. 8

- I. 1921 Homestead Entry No. 1065 by Grant Higgins: To listing cor. No. 8, mkd. and witnessed as described by the District Forester. I destroy the listing cor. and its accessories and in its place, establish cor. No. 8 of this survey, as follows: Place a small stone, mkd. with a cross (x) under a sandstone, 24x10x4 ins., 14 ins. in the ground, mkd. "8 HES 1065", on SW face and a cross (x) on top for the exact corner point.

Established two bearing trees:

A cross (x) on a white pine tree, 8 ins. diam., bears S70°39'E, 16 lks. dist.
A cross (x) on a white pine tree, 7 ins. diam., bears S46°50'W, 21 lks. dist.

Each bearing tree is blazed and scribed "8 HES 1065 BT".
Raise a mound of earth and stone, 4.0 ft. base, 2.0 ft. high, SW of the corner.

- II. Found a 5x12 in. stone, protruding 7 ins. above the ground, firmly set, mkd. "8 HES 1065" on the SW face, with an "x" on top. No evidence found of the original bearing trees.

- III. Established two new bearing trees:

A fir, 11 ins. diam., bears N22°E, 51.4 ft. dist., mkd. "8 HES 1065 BT".
A pine, 11 ins. diam., bears N75°E, 45.6 ft. dist., mkd. "8 HES 1065 BT".

Painted bearing trees and attached Land Survey Monument and Bearing Tree signs.

Magnetic Declination: 20° East.

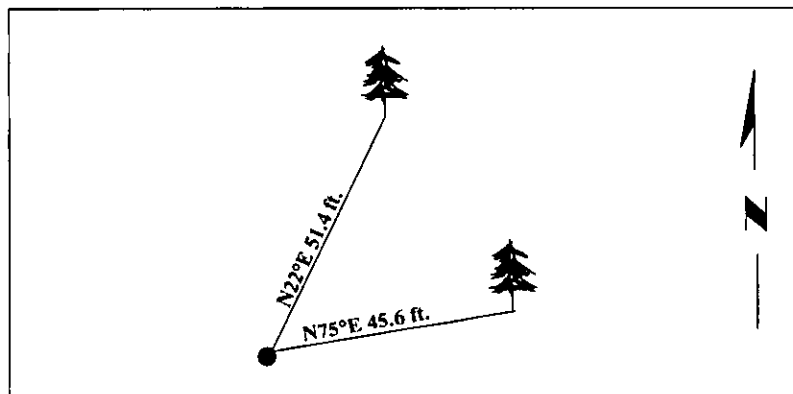

SKETCH OF CORNER

CERTIFICATION	
I. Rex O. Rice	certify the information shown herein is true and correct.
<i>Rex O. Rice</i>	
I. Steven A. Boyer	certify that this Corner Record correctly represents work performed by me or under my direction in compliance with the Corner Recordation Act (70-22-101, et seq., M.C.A.)
<i>Steven A. Boyer</i>	
Date: 08/18/98	Signature of Surveyor & Seal
Reg. No.: 9750LS	
Employer: U.S. FOREST SERVICE	

Office of Clerk and Recorder, County of Lincoln. This "corner record" was filed for record on 10/19/98 was noted on the cross-index plat and is assigned page No. 10248 in book No.

Coral M. Cummings By sub
County Official

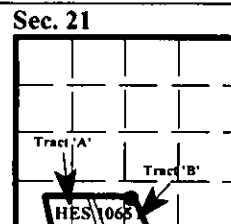

• - corner this sheet

Index No.

Cross **HES 1065 Cor. 8** T. **34N** R. **34W** P.M., MT