

## INSTRUCTIONS

1. Original and/or subsequent record used to evaluate the corner position.
2. Description of evidence found, note discrepancies in the record, state method of establishing lost or obliterated corners.
3. Description of monument and accessories set to perpetuate the corner position.
4. Sketch of corner, show all pertinent data which can best be shown in a sketch example, corner marking, topography ties, position of accessories, etc.
5. Certification must be signed and sealed by Land Surveyor registered in the State of Montana.
6. Fill in Cross Index & Section Diagram at bottom of sheet.

## CERTIFIED CORNER RECORDATION

Corner U.S.L.M. No. 739 T. 34 N. R. 32 W. P.M.M. Lincoln County

- I. 1917 USLM 739 original record by E. R. Johnson: "For U.S.L.M. No. 739, established to govern surveys in unsurveyed T. 34 N., R. 32 W., I mark a quartzite outcrop 8 x 8 x 8 ft. above ground, U.S.L.M. 739 on the SW face and a cross (X) on top for the exact corner point,

from which:

- A cross (X) on a fir tree, 12 ins. diam., bears S.81°30'W., 56 lks. dist.  
 A cross (X) on a fir tree, 12 ins. diam., bears N.30°45'W., 17 lks. dist.,  
 each blazed and scribed USLM 739 BT.  
 Raise a mound of stone 6 ft. base, 4 1/2 ft. high, 6 ft. dist., NE of corner.

- II. Found a 8x8x8 ft. outcrop of rock. Marked USLM 739 on the SW face and "X" on top.

From which:

- A fir stump, 28 ins. diam., bears S80°W, 37.0 ft. (56.06 lks.) dist., no scribe - cut to low.  
 A stump hole, bears N30°W, 11.6 ft. (17.58 lks.) dist., no visible scribe.  
 A mound of stone 8x8 ft. base, 4 ft. high, NE. of corner.

- III. Established two new bearing trees:

- A fir, 17 ins. diam., bears N64°E, 14.0 ft. dist., marked USLM 739 BT.  
 A fir, 7 ins. diam., bears N2°W, 18.3 ft. dist., marked USLM 739 BT.

Painted red bands around the bearing trees and attached "Land Survey Monument" and "Bearing Tree" signs.  
 Set a galvanized steel guard post with "Land Survey Marker" decal, 6 ft. N32°E of the corner.

Magnetic declination: 20° East

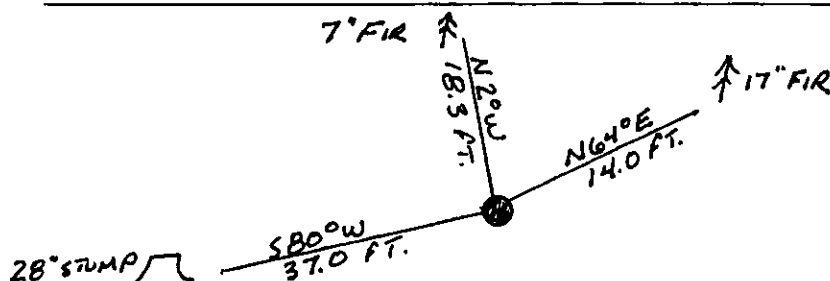
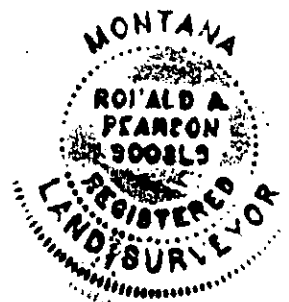

SKETCH OF CORNER

CERTIFICATION

I, Kevin A. Todd  
 certify the information shown herein is true and correct.  
Kevin A. Todd  
 Signature Ground Party Chief

I, Ronald A. Pearson  
 certify that this Corner Record correctly represents work performed  
 by me or under my direction in compliance with the "Corner  
 Recordation Act" (70-22-101, et seq., M.C.A.)  
Ronald A. Pearson  
 Signature of Surveyor & Seal

Date: 11/16/92 Reg. No. 9008LS  
 Employer: U.S. FOREST SERVICE

Office of Clerk and Recorder, County of Lincoln. This "corner  
 record" was filed for record on 12-7-92  
 was noted on the cross-index plat and is assigned page No. 5107, in  
 book No. Coral M. Cunningham

County Official

USLM 739 34 N 32 W

Cross Index No. T. R. PMM

Sec. 31

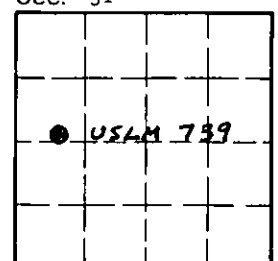

• - corner this sheet