

## CERTIFIED CORNER RECORDATION

Corner 1/4 Corner Sections 32/33 T. 34 North R. 31 West P.M.M. Lincoln County

ORIGINAL – M.W. COFFIN AND R.F. McCLEAN – 1916

N0° 04' W between sections 32 and 33 – 40.00 chains.....

Set a limestone 14X14X8 inches, 10 inches in the ground, marked "1/4" on the west face, from which:

A 12" fir bears S42° E, 20 links (13.2 ft.), marked "1/4 S33 BT"

A 16" pine bears S84° W, 10 links (6.6 ft.) marked "1/4 S32 BT"

### FOUND:

Found the original stone laying on its side. Found the remains of the original bearing tree in Section 32, "BT" visible at the base. By bringing the stone into an upright position the bearing tree was at record bearing and distance.

### SET:

At the upright position of the stone and record bearing and distance from the original bearing tree in Section 32, I set a standard 2 1/2" aluminum pipe with a 3 1/4" aluminum cap, marked as shown below, from which:

A 10" Alpine fir bears N35° W, 5.9 feet, marked "1/4 S32 BT"

A 12" Cedar bears N23° E, 18.5 feet, marked "1/4 S33 BT"

Placed a 6 foot metal post with Land Survey Monument Decal 2 feet south of the corner. Placed bearing tree tags on the new trees and the original bearing tree stump.

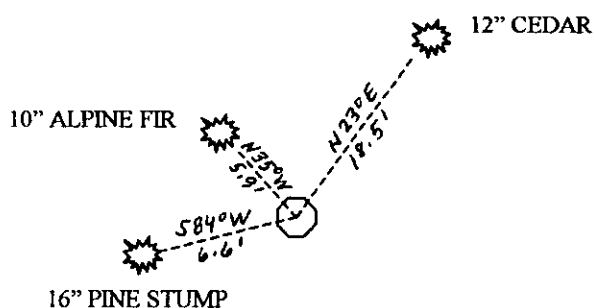
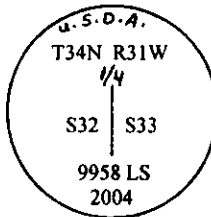

SKETCH OF CORNER

### CERTIFICATION

I, James R. Staples

Certify the information shown herein is true and correct.

*James R. Staples*  
Signature Ground Party Chief

I, James R. Staples

certify that this Corner Record correctly represents work performed by me or under my direction in compliance with the "Corner Recordation Act" (70-22-101, et seq., M.C.A.)

*James R. Staples*  
Signature of Surveyor & Seal

Date: 8/2/04 Reg. No. 9958 LS

Employer: J.R.S. Surveying, Inc.

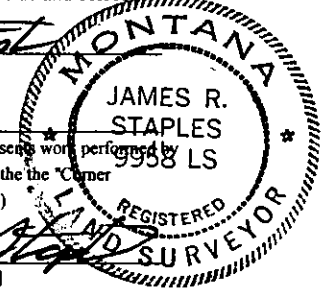

Office of Clerk and Recorder, County of Lincoln. This "corner record" was filed for record on 8-18-04

was noted on the cross-index plat and is assigned page no. 10660, in

Doc# 178554 *James R. Staples*

book no.

County Official

Cross Index No. X9 T. 34N R. 31W PMM

Adopted July 1, 1981, Montana Board of Professional Engineers & Land Surveyors

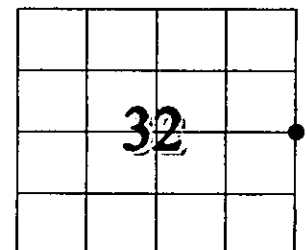

• - Corner this sheet