

1. Original and/or subsequent record use
2. Description of evidence found, note d
3. Description of monument and access
4. Sketch of corner, show all pertinent d
5. Certification must be signed and seal
6. Fill in Cross Index & Section Diagram

178552 BOOK: CCR CC&R'S PAGE: 1065 Pages: 1
STATE OF MONTANA LINCOLN COUNTY
RECORDED: 08/18/2004 9:00 KOI: CC&R'S
CORAL M. CUMMINGS CLERK AND RECORDER
FEE: \$0.00 BY: *Jeanni Dennis Deputy*
TO: FILED

CERTIFIED CORNER RECORDATION

Corner 1/4 Corner Sections 30/31 T. 34 North R. 31 West P.M.M. Lincoln County

ORIGINAL - M.W. COFFIN AND R.F. McCLEAN - 1916

East on a true line between Sections 30 and 31.....

39.92 chains - Set a sandstone 17X11X5 inches, 12 inches in the ground for the 1/4 corner, marked "1/4" on the north face, from which:

A 26" tamarack bears N64° 45'E, 112 links (73.92 feet), mrkd "1/4 S30 BT"

A 20" tamarack bears S49° 15'E, 225 links (148.50 feet), mrkd "1/4 S31 BT"

FOUND:

Found the original stone clearly marked and firmly in place

SET:

Set a standard 2 1/2" X 30" aluminum pipe with a 3 1/4" cap, marked as show below, from which:

An 11" larch bears N69° 39'W, 3.8 ft., marked "1/4 S30 BT"

A 17" larch bears S23° 56'W, 12.0 ft., marked "1/4 S31 BT"

Placed a 6' metal post with Land Survey Monument Decal 2' east of the corner. Attached bearing tree tags to the new bearing trees.

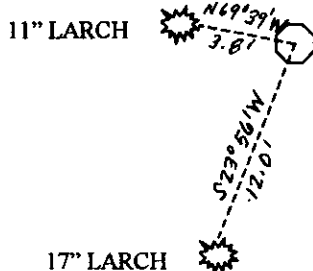
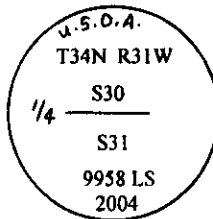

SKETCH OF CORNER

CERTIFICATION

I, James R. Staples

Certify the information shown herein is true and correct.

James R. Staples
Signature Ground Party Chief

I, James R. Staples

certify that this Corner Record correctly represents work performed by me or under my direction in compliance with the "Corner Recordation Act" (70-22-101, et seq., M.C.A.)

James R. Staples
Signature of Surveyor & Seal

Date: 8/5/04 Reg. No. 9958 LS

Employer: J.R.S. Surveying, Inc.

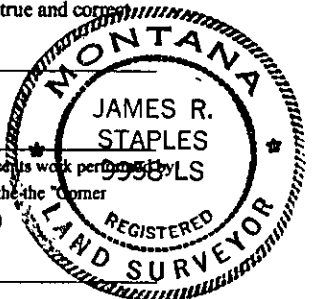

Office of Clerk and Recorder, County of Lincoln. This "corner record" was filed for record on 8-18-04

was noted on the cross-index plat and is assigned page no. 10657, in

DOC book no. 178552.

Jeanni Dennis

County Official

Cross Index No. 23 T. 34N R. 31W PMM

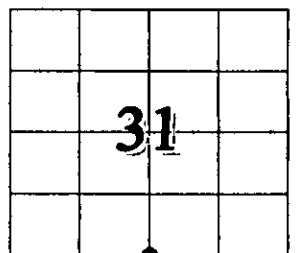

• - Corner this sheet