

# CERTIFIED LAND CORNER RECORDATION

Corner 23,24,26,25 T 34N R 29W

## DESCRIPTION OF CORNER EVIDENCE FOUND, AND ORIGINAL RECORD (IF KNOWN)

Original  
1912 GLO Notes, Vol. 6501 Page 4&5 T34N R29W Lincoln County, Mont.  
Corner Desc. Slatestone 18"x10"x8", 12" in grd. mkd W/2 notches  
on S and 1 notch on E. edge. 12" Tamarack bears N35°W, 26 lks, mkd.  
T34N R29W S 23 BT, 8" Pine bears N29°E 74 lks, mkd. T34N R29W S 24 BT  
12" Tamarack bears S50°W 39 lks, mkd. T34N R29W S, 26 BT  
12" Tamarack bears S 21°E, 14 lks., mkd. T34N R29W S 25 BT  
Oct. 26, 1966  
Found the original stone-still firmly in place-marked as reported. All  
four bearing trees are live and though blazes are partly overgrown- and  
three have been slightly burned-the scribing is partly legible in every  
case. Corner is in E edge of small natural clearing (120x80') nearly  
flat-about 70 Ft. E of rock outcrop-overlooking Kootenai Valley  
(See otherside of this sheet)

## DESCRIPTION OF MONUMENT AND ACCESSORIES ESTABLISHED TO PERPETUATE THE ORIGINAL LOCATION OF THIS CORNER:

Date of work: 26/10/66

We set a Std. Brass Capped Monument in a mound of stone  
Placed original stone alongside Cap marked T34N R29W

23 | 24  
26 | 25  
1966

We tagged all of the bearing trees with Std. BT signs  
17" Larch bears N35°W, 17' Blaze Burned  
14" Pine bears N29°E, 49'  
17" Larch bears S50°W, 26' Blaze Burned R29W legible  
20" Larch bears S21°E, 9', blazed mostly overgrown

SKETCH, WITH COURSE AND DISTANCE TO ADJACENT CORNERS IF DETERMINED IN THIS SURVEY.  
(MAY SKETCH OR PASTE REPRODUCTION ON REVERSE SIDE.)

~ See other side ~

Surveyor's Seal

I, \_\_\_\_\_  
certify that the information shown herein is true and  
correct.

*Jack Nunneman*  
Signature of Ground Party Chief

I, \_\_\_\_\_  
certify that I have carefully performed or reviewed the  
work done on the diagrammed corner as reported on this  
recording form and approve the same.

*Jack Nunneman*  
Signature of Surveyor

## DIAGRAM OF CORNER:

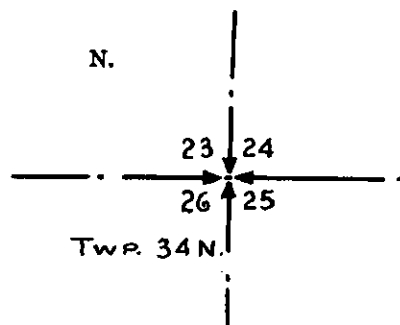

✦ = Corner recorded on the sheet

534 ES  
Registration Number

Office of Clerk and Recorder, County of Lincoln

This "corner record" was filed for record on the 5th day of January 1967, was noted on the cross-index plat and is  
assigned page No. 74, in book No. 1

ELEANOR L. VAUGHN, By: *Verde Hayden*  
County Official Deputy.

(continued from Found Section on otherside)  
 (+ 2000' below)- to the N slope breaks steeply to McGuire Cr.

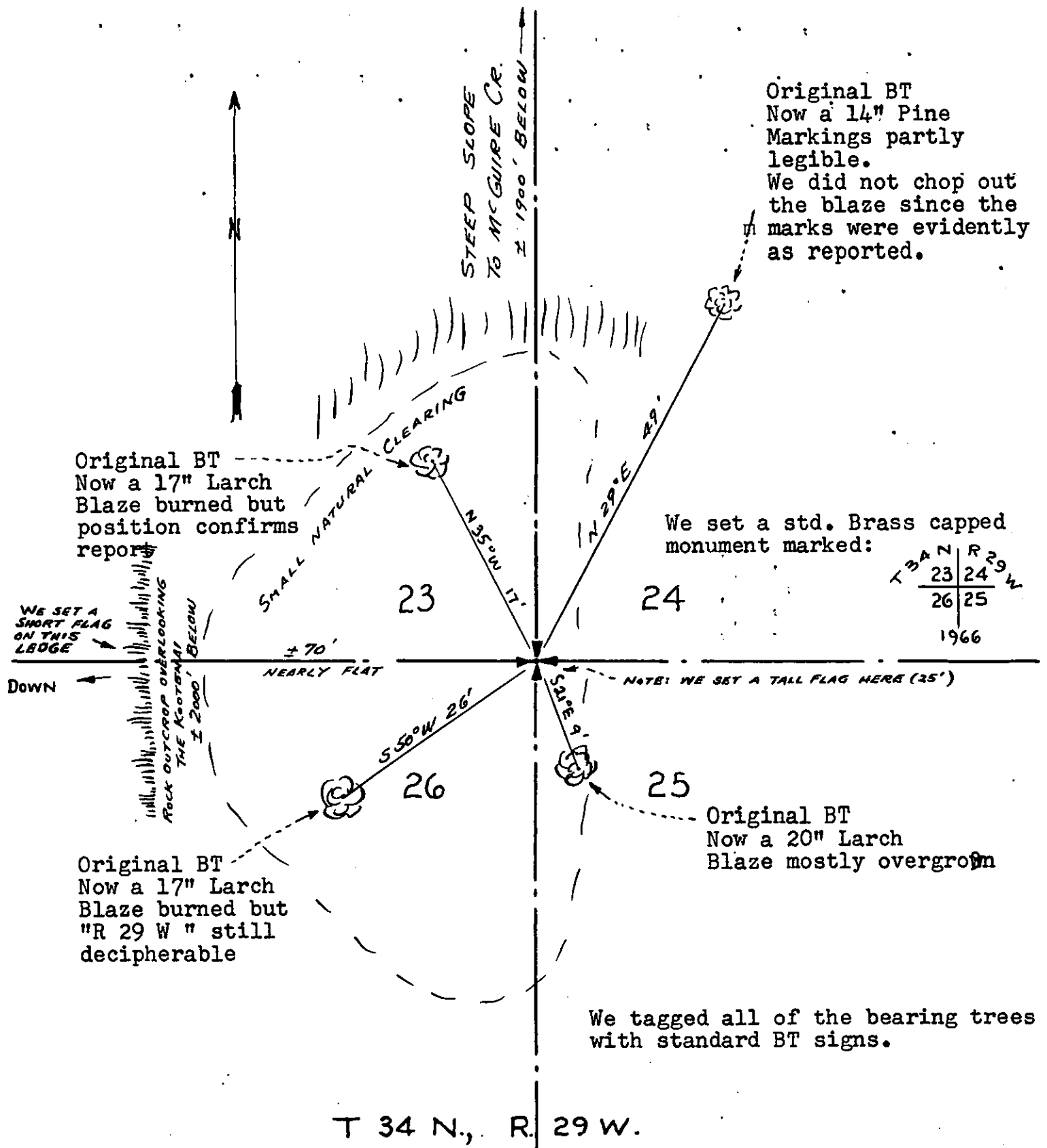

STATE OF MONTANA  
 COUNTY OF LINCOLN  
 Filed this 5th day of January A.D. 1967  
 at 2:45 P.M.  
 By *Edward J. Laughlin* County Clerk  
 Deputy

