

# CERTIFIED LAND CORNER RECORDATION

1/4 Corner between Sees <sup>15</sup>/<sub>22</sub> Twp. 34 N., R. 29 W., M.P.M.

Original DESCRIPTION OF CORNER EVIDENCE FOUND, AND ORIGINAL RECORD (IF KNOWN)  
 1913 GLO 1913 Vol. 6501 Page 64 Lincoln County, Montana  
 Desc. Granite stone in place, 20x16"x10" above grd mkd W/cross(X)  
 and 1/4 on N. face. 10" Lodgepole bears N36 1/2° E, 54 lks, mkd. 1/4 S 15 BT  
 20" Fir bears S 35 1/2° E, 55 lks. mkd 1/4 S 22 BT

Oxt. 13, 1966  
 Found the original stone which is not a 20"x16"x10", stone in place  
 above ground but is 12"x12"x5" stone lying flat with X and 1/4 on top-  
 the stone is at the reported bearing and distance from the NE BT  
 which is now 10"-live, markings plain-The SE BT is gone (blowdown) The  
 corner is on a steep slope to the E. in a small clearing (± 80' in Dia.)  
 Caused by windfalls. Approximately 1800 Ft. above the River

## DESCRIPTION OF MONUMENT AND ACCESSORIES ESTABLISHED TO PERPETUATE THE ORIGINAL LOCATION OF THIS CORNER:

Date of work: 13/10/66

We set a Std. Brass Capped Mounment in a large mound of stone.  
 Original stone is base of mound. Cap mkd 1/4 <sup>15</sup>/<sub>22</sub>  
 1966

We tagged the original BT with a Std. Bt. sign.  
 We blazed and scribed a 6" Fir which bears S70°W 44' mkd. 1/4 S 22 BT  
 10 Ft. Lodgepole bears N36 1/2° E, 36' mkd. 1/4 S15 BT  
 6" Fir mkd. 1/4 S22 BT bears S70°W 44 ft. (light snow)

SKETCH, WITH COURSE AND DISTANCE TO ADJACENT CORNERS IF DETERMINED IN THIS SURVEY.  
 (MAY SKETCH OR PASTE REPRODUCTION ON REVERSE SIDE.)

~ See other side ~

Surveyor's Seal

I, Jack Ninneman  
 certify that the information shown herein is true and  
 correct.

*Jack Ninneman*  
 Signature of Ground Party Chief

I, Jack Ninneman  
 certify that I have carefully performed or reviewed the  
 work done on the diagrammed corner as reported on this  
 recordation form and approve the same.

*Jack Ninneman*  
 Signature of Surveyor

DIAGRAM OF CORNER:

N.

15

22

T. 34 N., R. 29 W.

◀== Corner recorded on the sheet

534 ES  
 Registration Number

Office of Clerk and Recorder, County of Lincoln

This "corner record" was filed for record on the 5th day of January 1967, was noted on the cross-index plat and is  
 assigned page No. 69, in book No. 1

ELEANOR L. VAUGHN, By: *Kirk Hiden*  
 County Official Deputy.

The corner is on a steep slope to the east in a small clearing  
 ( about 80 feet in diameter ) caused by windfalls.  
 Approximately 1800 feet above the river..

We set a standard brass capped monument in a large mound of stone, with  
 the original stone in the base of the mound.

We marked the cap thus:

$$\frac{1}{4} \frac{15}{22} \\ 1966$$

We tagged the original Bearing Tree with a standard bearing tree sign.

We blazed and scribed a 6" fir which bears S 7 W 44 feet Marked  
 $\frac{1}{4}$  S 2 2 BT

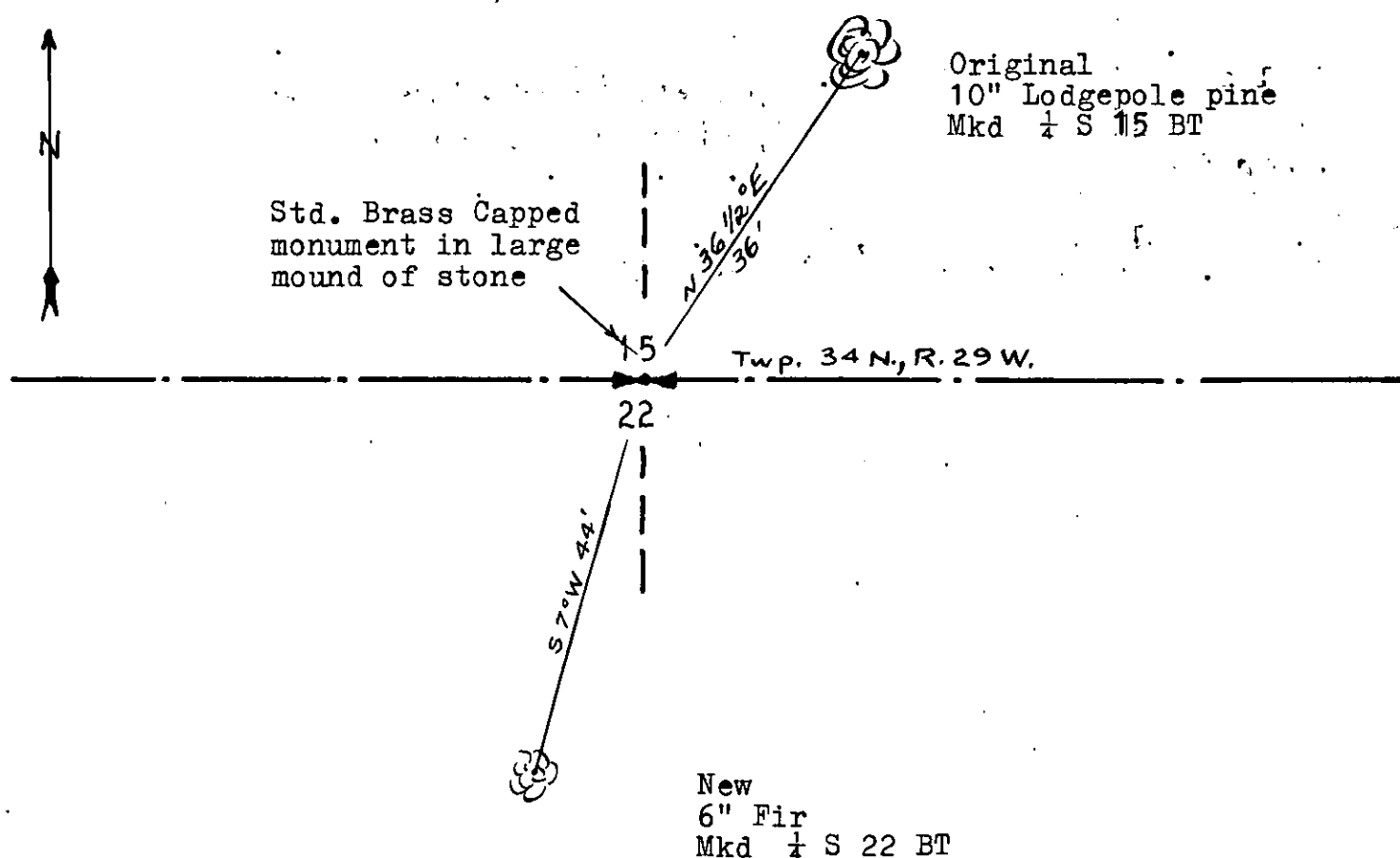

STATE OF MONTANA  
 COUNTY OF LINCOLN  
 Filed this 5th day of January A.D. 1967  
 at 2:33 P.M.  
 Charles A. Hueston  
 County Clerk  
 By [Signature] Deputy

