

CERTIFIED CORNER RECORDATION

Corner NW Sec. Corner Sec. 3 T. 34N R. 27W P.M, MT Lincoln County

I. 1911 G.L.O. original record by William C. Perkins: Set a stone and four bearing trees.

1970 B.L.M. remonumentation record by Joseph E. French: The corner of secs. 3, 4, 33 and 34, on the N. bdy. of the Tp., monumented with a shale stone, 14x8x5 ins., firmly set, mkd. with 3 notches on E. and 3 notches on W. edges, and witnessed by the original 4 bearing trees.

- A matured fir, 14 ins. diam., bears N38°E, 51 lks. dist., mkd "T35N R27W S34 BT". (G.L.O. record)
- A matured fir, 15 ins. diam., bears S37°E, 43 lks. dist., mkd with an overgrown blaze. (G.L.O. record)
- A matured larch, 24 ins. diam., bears S17°W, 75 lks. dist., mkd. with an overgrown blaze. (G.L.O. record)
- A matured fir, 24 ins. diam., bears N60°W, 41 lks. dist., mkd with an overgrown blaze. (G.L.O. record)

At the corner point, set an iron post, 30 ins. long, 2 1/2 ins. diam., 24 ins. in the ground, with brass cap marked:

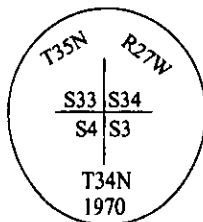

Established 4 new bearing trees:

- A fir, 6 ins. diam., bears N4 1/2°E, 22 lks. dist., mkd "T35N R27W S34 BT".
- A spruce, 6 ins. diam., bears S45°E, 21 lks. dist., mkd "T34N R27W S3 BT".
- A larch, 6 ins. diam., bears S76°W, 23 lks. dist., mkd. "T34N R27W S4 BT".
- A fir, 6 ins. diam., bears N11°W, 30 lks. dist., mkd "T35N R27W S33 BT".

bury the original stone alongside the iron post.

II. Found a B.L.M. brass cap, 6 in. out of ground, firmly set, mkd. as shown above: from which:

- A fir, 9 ins. diam., bears N5°E, 14.7 ft. (22 lks.) dist., with visible scribing.
- A downed fir long butt stump, 14 ins. diam., bears N38°E, 33.7 ft. (51 lks.) dist., mkd "T35N R27W S34 BT".
- A fir, 9 ins. diam., bears S45°E, 14.3 ft. (21 lks.) dist., with a healed face.
- A fir stump, 24 ins. diam., bears S30°E, 27.5 ft. (42 lks.) dist., no face remains. (rec. S37°E, 43 lks.)
- A larch, 26 ins. diam., bears S18°W, 50.0 ft. (75 lks.) dist., with a healed face. (rec. S17°W).
- A larch, 11 ins. diam., bears S76°W, 15.2 ft. (23 lks.) dist., with a healed face.
- A fir stump, 33 ins. diam., bears N57°W, 27.7 ft. (42 lks.) dist., no face remains. (rec. N60°W, 41 lks.)

III. Painted red bands around the bearing trees and attached Land Survey Monument and Bearing Tree signs.

Magnetic Declination: 20° East

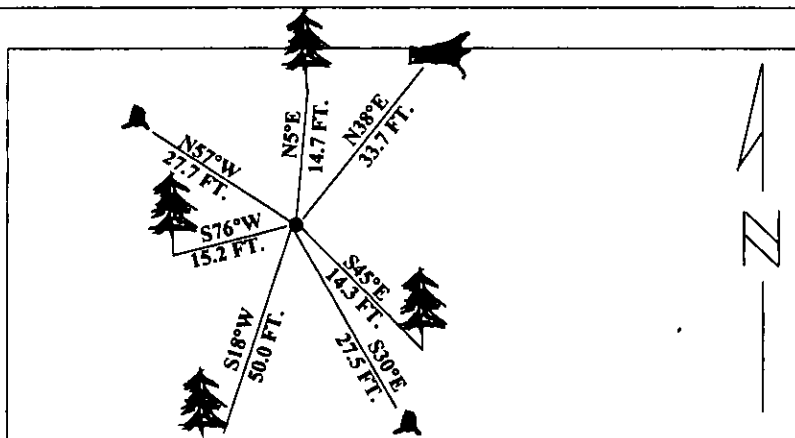

SKETCH OF CORNER

CERTIFICATION

I. Rex O. Rice

certify the information shown herein is true and correct.

Rex O. Rice

Signature Ground Party Chief

I. Alvah F. Hughes

certify that this Corner Record correctly represents work performed by me or under my direction in compliance with the "Corner Recordation Act" (70-22-101 et seq., M.C.A.)

Alvah F. Hughes

Signature of Surveyor & Sec.

Date: 12/19/95

Reg. No.: 7322LS

Employer: U.S. FOREST SERVICE

Office of Clerk and Recorder, County of LINCOLN. This "corner record" was filed for record on JULY 29, 1997 was noted on the cross-index plat and is assigned page No. 9791 in book No. CORAL M. CUMMINGS By DERB

County Official

Sec. 3

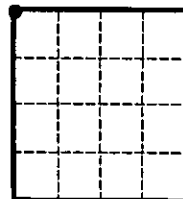

• - corner this sheet

Cross Index No.

A-13

T.

34N

R.

27W

PMM