

CERTIFIED CORNER RECORDATION

Corner W 1/4 Sec. 2 T. 34N R. 27W P.M., MT Lincoln County

I. 1912 G.L.O. original record by William C. Perkins: Set a slate stone, and 2 bearing trees.

1970 B.L.M. remonumentation record by Joseph E. French: The 1/4 cor. of sec's. 2 and 3, monumented with a slate stone, 14x10x6 ins., firmly set, mkd. 1/4 on W. face, and witnessed by the remains one of the original bearing trees:

A larch stump, 10 ins. diam., bears N53°E, 22 lks. dist., mkd "1/4 S2 BT".

At the corner point, set an iron post, 30 ins. long, 2 1/2 ins. diam., 24 ins. in the ground with brass cap mkd.:

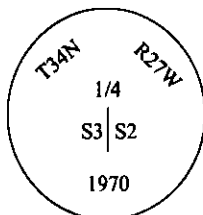

Established 2 new bearing trees:

A larch, 10 ins. diam., bears S14°E, 66 lks. dist., mkd "1/4 S2 BT".

A spruce, 10 ins. diam., bears S58 1/4°W, 89 lks. dist., mkd "1/4 S3 BT".

bury the orig. stone alongside iron post.

II. Found a 2 1/2 in. diam. iron post, 10 in. out of ground, firmly set, with a 3 1/4 in. diam. B.L.M. brass cap, mkd. as shown above; from which:

A larch stump, 12 ins. diam., bears N53°E, 14.5 ft. (22 lks.) dist., mkd. "S2 BT". (G.L.O.)

A larch stump, bears S14°E, 43.6 ft. (66 lks.) dist., with visible scribing.

A downed spruce, bears S58°W, 77.8 ft. (118 lks.) dist., mkd "1/4 S3 BT". (Rec: 89 lks.)

An uprooted larch stump, bears S76°W, 20.5 ft (31 lks.) dist., with no visible scribing. (G.L.O.)

III. Established 2 new bearing trees:

A larch, 8 ins. diam., bears N32°E, 22.9 ft. dist., mkd. "1/4 S2 BT".

A larch, 7 ins. diam., bears N28°W, 12.7 ft. dist., mkd. "1/4 S3 BT".

Painted red bands around the bearing trees and attached Land Survey Monument and Bearing Tree signs.

Set a 6 ft. steel guard post, 4 ft. W. of corner, with L.S.M. decal affixed.

Magnetic Declination: 20° East

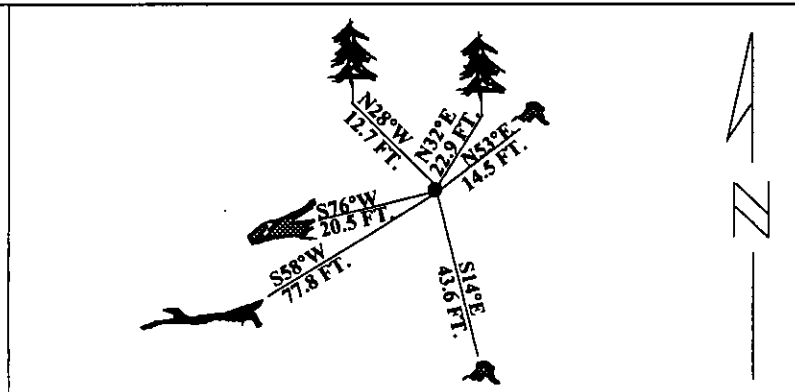

SKETCH OF CORNER

CERTIFICATION

I. Thomas M. Hommel

certify the information shown herein is true and correct.

Thomas M. Hommel
Signature Ground Party Chief.

I. Alvah F. Hughes

certify that this Corner Record correctly represents work performed by me or under my direction in compliance with the "Corner Recordation Act" (M.C.A.)

Alvah F. Hughes
Signature of Surveyor & Seal

Date: 12/15/95

Reg. No.: 7322LS

Employer: U.S. FOREST SERVICE

Office of Clerk and Recorder, County of LINCOLN. This "corner record" was filed for record on JULY 29, 1997 was noted on the cross-index plat and is assigned page No. 9790 in book No. _____

CORAL M. CUMMINGS By DUB
County Official

Sec. 2

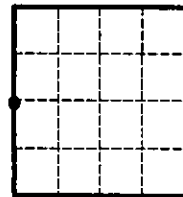

• - corner this sheet

Cross Index No. C-17

T. 34N R. 27W PMM