

CERTIFIED CORNER RECORDATION

Corner	Sec. Cor.	Sec.	13,18, 19&24	T.	34N T. 34N	R.	27W R. 26W	P.M., MT	Lincoln	County
--------	-----------	------	-----------------	----	---------------	----	---------------	----------	---------	--------

- I. 1894 G.L.O. Original Record by Frank L. Sizer et.al.: Set a limestone, 24x6x6 ins., 18 ins. in the ground, for cor. of secs. 13,18,19&24, mkd. with 3 notches on N. and S. edges.

Established three bearing trees:

- A fir, 32 ins. diam., bears S50°E, 120 lks. dist., mkd. "T34N R26W S19 BT".
- A fir, 14 ins. diam., bears S58°W, 198 lks. dist., mkd. "T34N R27W S24 BT".
- A larch, 14 ins. diam., bears N64°W, 260 lks. dist., mkd. "T34N R27W S13 BT".

- II. No corner monument found. Found all three original bearing trees.

from which:

- A fir snag, 41 ins. diam., bears S50°E, 79.2 ft. dist., with a healed face. (GLO-record)
- A fir, 26 ins. diam., bears S58°W, 130.7 ft. dist., with visible scribe. (GLO-record)
- A larch, 29 ins. diam., bears N64°W, 171.6 ft. dist., with a healed face. (GLO-record)

- III. At the corner position, as determined from the found original bearing trees, set an aluminum pipe, 30 ins. long, 2 1/2 in. diam., 28 ins. in the ground, with a 3 1/4 in. diam. aluminum cap, mkd. as shown.

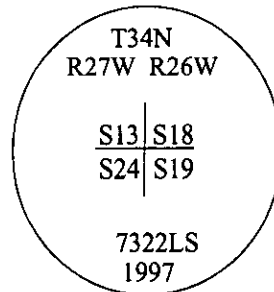

No new bearing trees set.

Painted bearing trees and attached Land Survey Monument and Bearing Tree signs.

Magnetic Declination: 20° East.

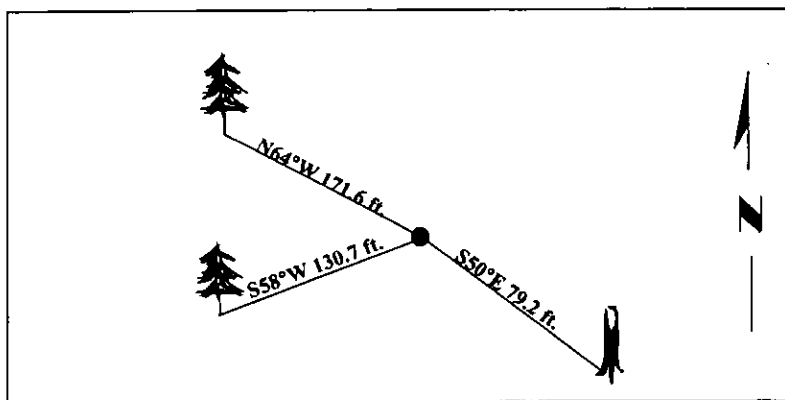

SKETCH OF CORNER

CERTIFICATION

I, Mark Federman
certify the information shown herein is true and correct

I, Alvah F. Hughes
certify that this Corner Record correctly represents work performed by me or under my direction in compliance with the "Corner Recordation Act" (70-22-101, et seq., M.C.A.)

Signature of Surveyor & Seal

Date: 09/02/97

Reg. No.: 7322LS

Employer: U.S. FOREST SERVICE

Office of Clerk and Recorder, County of Lincoln. This "corner record" was filed for record on 12-28-97 was noted on the cross-index plat and is assigned page No. 10054 in book No. _____

Coral M. Cumming Byler
 County Official

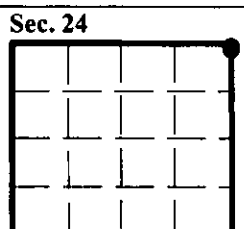

• - corner this sheet