

CERTIFIED CORNER RECORDATION

Corner Sec. Cor. Sec. 13,14, T. 34N R. 27W P.M., MT Lincoln County
23&24

- I. 1912 G.L.O. Original Record by William C. Perkins: Set a shale stone, 12x8x6 ins., 8 ins. in the ground, for cor. of secs. 13, 14, 23 & 24, mkd. with 1 notch on E. and 3 notches on S. edge.

Established four bearing trees:

- A pine, 14 ins. diam., bears N49°E, 22 lks. dist., mkd. "T34N R27W S13 BT".
- A pine, 10 ins. diam., bears S40°E, 16 lks. dist., mkd. "T34N R27W S24 BT".
- A pine, 12 ins. diam., bears S35°W, 45 lks. dist., mkd. "T34N R27W S23 BT".
- A larch, 12 ins. diam., bears N26°W, 26 lks. dist., mkd. "T34N R27W S14 BT".

- II. Found a shale stone, 12x8 ins., 6 ins. above the ground, firmly set, notches obliterated.

from which:

- A dead down pine, bears N49°E, 14.5 ft. dist., with visible scribe. (GLO-record)
- A dead down pine, bears S40°E, 10.5 ft. dist., with visible scribe. (GLO-record)
- A root crown, bears S35°W, 29.7 ft. dist. (GLO-record)
- A larch, 14 ins. diam., bears N66°W, 17.1 ft. dist., with visible scribe and a bearing tree tag. (GLO-record-N26°W)

- III. At the postition of the found stone, set in its place, an aluminum pipe, 30 ins. long, 2 1/2 in. diam., 18 ins. in the ground, with a 3 1/4 in. diam. aluminum cap, mkd. as shown.

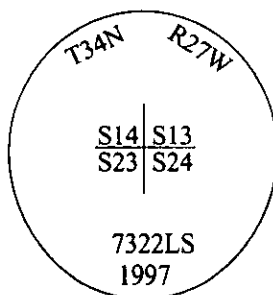

Established three new bearing trees:

- A larch, 18 ins. diam., bears N60°E, 28.4 ft. dist., mkd. "T34N R27W S13 BT".
- A spruce, 11 ins. diam., bears S62°E, 6.0 ft. dist., mkd. "T34N R27W S24 BT".
- A fir, 9 ins. diam., bears S60°W, 13.4 ft. dist., mkd. "T34N R27W S23 BT".

Buried the original stone alongside the alumunim pipe.

Painted bearing trees and attached Land Survey Monument and Bearing Tree signs.

Magnetic Declination: 20° East.

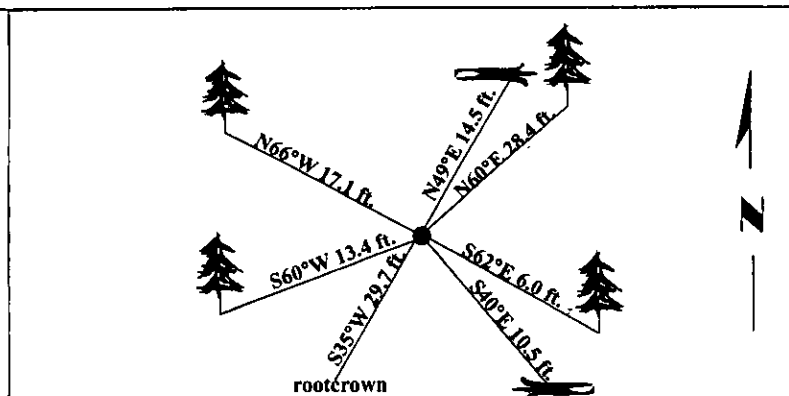
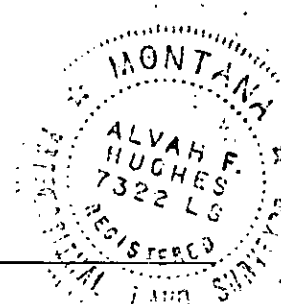

SKETCH OF CORNER

CERTIFICATION

I, Mark Federman
certify the information shown herein is true and correct.

I, Alvah F. Hughes
certify that this Corner Record correctly represents work performed by me or under my direction in compliance with the "Corner Recordation Act" (70-22-101, et seq., M.C.A.)

Alvah F. Hughes
Signature of Surveyor & Seal

Date: 08/25/97

Reg. No.: 7322LS

Employer: U.S. FOREST SERVICE

Office of Clerk and Recorder, County of Lincoln. This "corner record" was filed for record on 12-26-97 was noted on the cross-index plat and is assigned page No. 10032 in book No. _____

Carol M. Cummins B. DUB
County Official

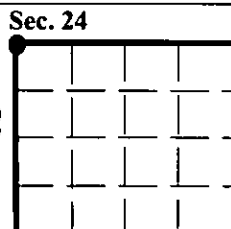

• - corner this sheet