

CERTIFIED CORNER RECORDATION

Corner 1/4 Secs. 13 & 14 T. 34N R. 27W P.M., MT Lincoln County

- I. 1912 G.L.O. Original Record by William C. Perkins: Set a shale stone, 15x8x5 ins., 10 ins. in the ground, for 1/4 sec. cor., mkd. "1/4" on the W. face..

Established two bearing trees:

A fir, 6 ins. diam., bears N55°E, 6 lks. dist., mkd. "1/4 S14 BT".
A pine, 10 ins. diam., bears S76°W, 66 lks. dist., mkd. "1/4 S13 BT".

- II. No evidence found of stone monument or the original bearing trees.
- II. At the corner position, set by single proportion, a 30 ins. long aluminum pipe, 2 1/2 in. diam., 22 ins. in the ground, with a 3 1/2 in. diam. aluminum cap, surrounded with a rock collar, mkd. as shown.

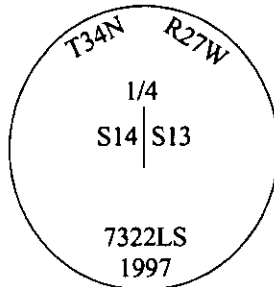

Established one new bearing tree:

A 3x3 mound of stone, bears S70°W, 3.8 ft. dist.
A larch, 24 ins. diam., bears N23°W, 134.4 ft. dist., mkd. "1/4 S14 BT".
A 6 ft. galvanized steel guard post, bears North, 3.0 ft. dist.

Painted bearing trees and attached Land Survey Monument and Bearing Tree signs.

Magnetic Declination: 20° East.

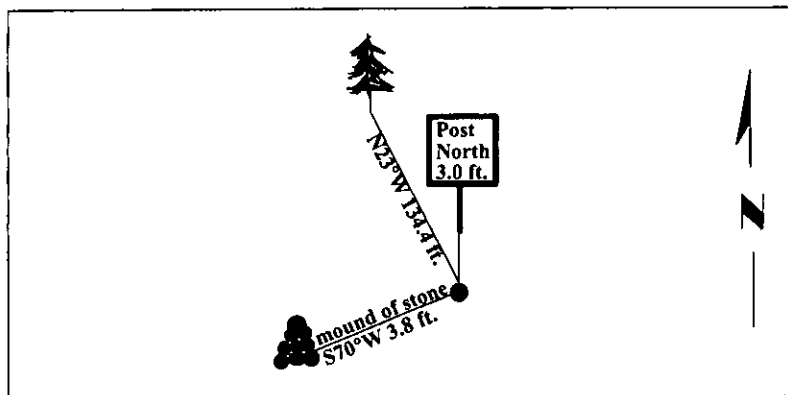

SKETCH OF CORNER

CERTIFICATION

I, Mark Federman
certify the information shown herein is true and correct.

Mark Federman

I, Alvah F. Hughes
certify that this Corner Record correctly represents work performed by me or, under my direction in compliance with the "Corner Recordation Act", (70-22-101, et seq., M.C.A.)

Alvah F. Hughes
Signature of Surveyor & Seal

Date: 10/22/97

Reg. No.: 7322LS

Employer: U.S. FOREST SERVICE

REGISTERED
LAND SURVEYOR
MONTANA
HUGHES
7322 LS

Office of Clerk and Recorder, County of Lincoln. This "corner record" was filed for record on 12-26-97 was noted on the cross-index plat and is assigned page No. 10007 in book No. _____

Coral M. Cunningham
County Official

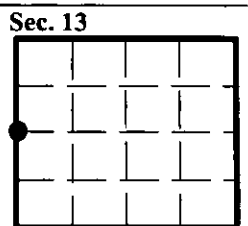

● - corner this sheet

Cross Index No. L-21 T. 34N R. 27W P.M., MT