

CERTIFIED CORNER RECORDATION

Corner S 1/4 Sec. 21 T. 34N R. 26W P.M., MT Lincoln County

- I. 1894 G.L.O. orig. record by Abram L. Jaqueth: At 40.09 chains: Set a post, 3 ft. long, 3 ins. square, 24 ins. in the ground, for 1/4 Sec. Cor. marked "1/4 S." on N. face, from which:
 A pine, 6 ins. diam., bears N13°30'E, 21 lks. dist., mkd. "1/4 S. BT".
 A fir, 10 ins. diam., bears S74°30'W, 27 lks. dist., mkd. "1/4 S. BT".
 At 41.37 chains: A larch, 12 ins. diam., on line, mkd. with 2 notches on E. and W. sides.

1987 U.S.F.S. C.C.R. by Alvah F. Hughes: Found a stump hole with a piece of the original pine bearing tree with legible scribing. Two stumps were found at approx. record bearing and dist. for the larch line tree, but log remains were not available. No remains of orig. post were found.

At record bearing and dist. from remains of the orig. pine bearing tree, set an aluminum post, 2 1/2 ins. diam., 30 ins. long, 24 ins. in the ground, in a mound of earth and stone, 3x3x1 ft. high, with a 3 1/4 in. diam. aluminum cap mkd. as shown:

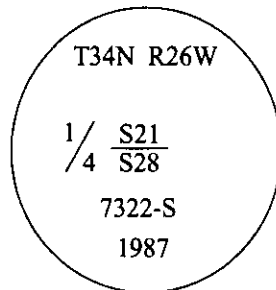

Established two new bearing trees.

Set a steel guard post with a "Survey Marker" decal attached, 2 ft. E. of the monument.

- II. Found a 2 1/2 in. alum. post, firmly set, protruding 4 ins. above the ground, with a 3 1/4 in. diam. alum. cap mkd. as shown above, from which:
 A fir, 8 ins. diam., bears S6°E, 10.8 ft. dist., mkd. with visible scribing. (U.S.F.S. record)
 A larch snag, 7 ft. high, 10 ins. diam., bears N77°W, 23.9 ft. dist., mkd. with visible scribing. (U.S.F.S. record)
 No evidence of orig. bearing trees found.
 A steel guard post with a survey Marker decal attached, 2 ft. E. of the monument.

- III. Established one new bearing tree:
 A fir, 7 ins. diam., bears N35°E, 14.9 ft. dist., mkd. "1/4 S21 BT".

Painted bearing trees and attached Land Survey Monument and Bearing Tree signs.

Magnetic Declination: 20° East.

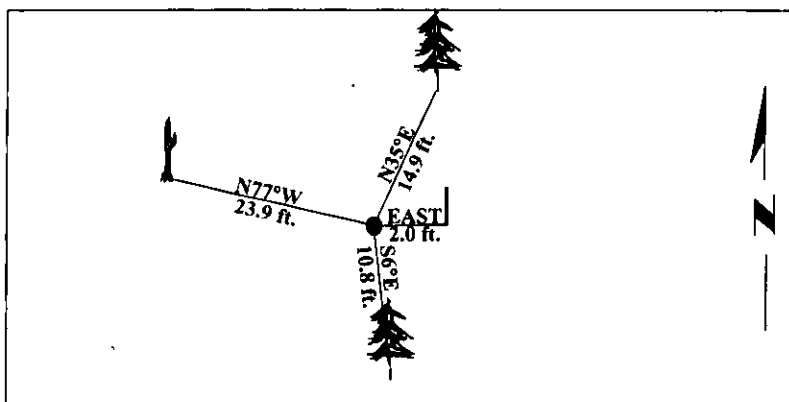

SKETCH OF CORNER

CERTIFICATION

I, Rex O. Rice
 certify the information shown herein is true and correct.

I, Alvah F. Hughes
 certify that this Corner Record correctly represents work performed by me or under my direction in compliance with the "Corner Recordation Act" (70-22-101; et seq., M.C.A.)

Alvah F. Hughes
 Signature of Surveyor's Seal

Date: 12/10/96

Reg. No.: 7322LS

Employer: U.S. FOREST SERVICE

Office of Clerk and Recorder, County of LINCOLN. This "corner record" was filed for record on FEB 3, 1997 and was noted on the cross-index plat and is assigned page No. 9179, in book No. CORAL M. CUMMINGS

County Official By DVB

Sec. 21

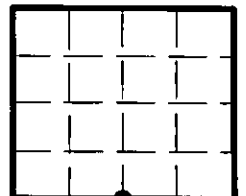

• - corner this sheet

