

# CERTIFIED CORNER RECORDATION

Corner E 1/16 Sec. 6 & 7 T. 34N R. 26W P.M., MT Lincoln County

- I. 1978 Certificate of Survey No. 2099 by Manfred L. Haiges No. 2520S: Set a 30 in. long, 2 in. diam. galvanized pipe, with a 2 in. diam. brass cap mkd. as shown:

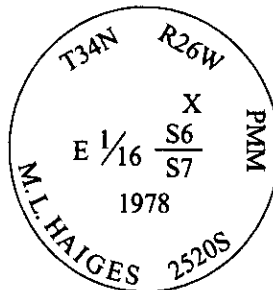

- II. Found a 2 1/4 in. diam. iron pipe, protruding 18 ins. above the ground, firmly set, with a 3 in. diam. brass cap mkd. as shown above.

from which:

- A fir, 11 ins. diam., bears S82°E, 31.3 ft. dist., mkd. with a healed face.  
A fir, 12 ins. diam., bears S33°W, 20.75 ft. dist., mkd. with a healed face.

Bearing trees had bearing tree signs attached.

- III. The Haiges brass cap was accepted as the E 1/16, based on survey.

Established two new bearing trees:

- A fir, 10 ins. diam., bears N10°E, 22.8 ft. dist., mkd. "E1/16 S6 BT".  
A fir, 7 ins. diam., bears S60°E, 21.4 ft. dist., mkd. "E 1/16 S7 BT".

Painted bearing trees and attached Land Survey Monument and Bearing Tree signs.

Magnetic Declination: 20° East.

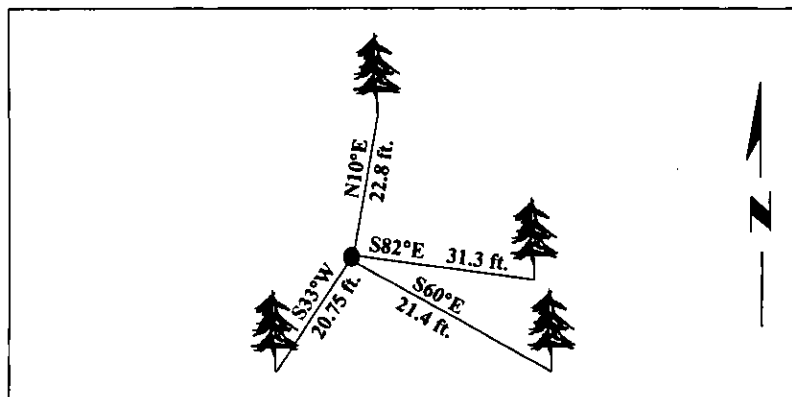

SKETCH OF CORNER

**CERTIFICATION**

I, Mark Federman  
certify the information shown herein is true and correct.

I, Alvah F. Hughes  
certify that this Corner Record correctly represents work performed by me or under my direction in compliance with the "Corner Recordation Act" (70-22-101, et seq., M.C.A.).

Alvah F. Hughes  
Signature of Surveyor & Seal

Date: 12/11/96

Reg. No.: 7322LS

Employer: U.S. FOREST SERVICE

**ALVANH F. HUGHES**  
**7322LS**  
**REGISTERED**

Office of Clerk and Recorder, County of LINCOLN. This "corner record" was filed for record on FEB 3, 1997 and was noted on the cross-index plat and is assigned page No. 9183, in book No. CORAL M. CUMMINGS By DAB

County Official

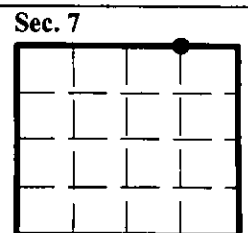

• - corner this sheet



RECEIVED  
FEB 10 1964  
U.S. AIR FORCE  
HEADQUARTERS  
AIR FORCE  
WASHINGTON, D.C.

RECEIVED  
FEB 10 1964  
U.S. AIR FORCE  
HEADQUARTERS  
AIR FORCE  
WASHINGTON, D.C.

RECEIVED  
FEB 10 1964  
U.S. AIR FORCE  
HEADQUARTERS  
AIR FORCE  
WASHINGTON, D.C.