

CERTIFIED CORNER RECORDATION

Corner C-E-E-SW Sec. 21 T. 34N R. 26W P.M., MT Lincoln County
1/256

- I. No previous history.
- II. Nothing found.
- III. At the position determined by survey, set a 3/4 in. diam., 30 in. long aluminum rod, 26 ins. in the ground, with a 3 1/4 in. diam. alum. cap, marked as shown:

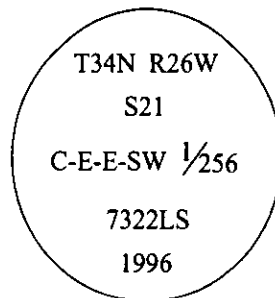

Established two bearing trees:

A fir, 10 ins. diam., bears N26°E, 17.7 ft. dist., scribed "C E E SW 1/256 S21 BT".
A larch, 7 ins. diam., bears N45°W, 41.2 ft. dist., scribed "X" "BT".

Painted bearing trees and attached Land Survey Monument and Bearing Tree signs.

Magnetic Declination: 20° East.

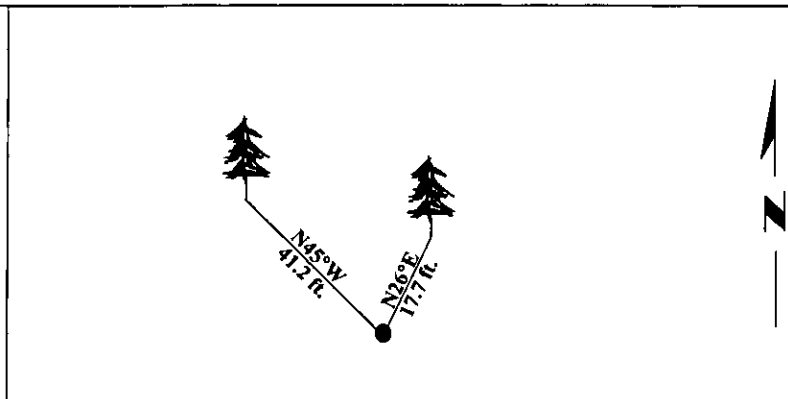

SKETCH OF CORNER

CERTIFICATION	
I, <u>Mark Federman</u>	certify the information shown herein is true and correct.
I, <u>Alvah F. Hughes</u>	certify that this Corner Record correctly represents work performed by me or under my direction in compliance with the "Corner Recordation Act" (70-22-101, et seq., M.C.A.).
Date: <u>12/11/96</u>	Signature of Surveyor & Seal
Reg. No.: <u>7322LS</u>	
Employer: <u>U.S. FOREST SERVICE</u>	

Office of Clerk and Recorder, County of LINCOLN. This "corner record" was filed for record on FEB 3, 1997 and was noted on the cross-index plat and is assigned page No. 9173, in book No. .

CORAL M. CUMMINGS County Official

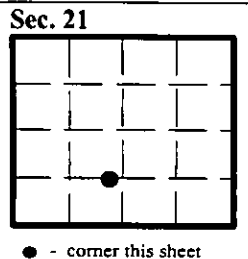

• - corner this sheet

