

CERTIFIED CORNER RECORDATION

Corner S 1/4 Sec. 1 T. 34N R. 26W P.M., MT Lincoln County

I. 1894 G.L.O. orig. record by Abram L. Jaqueth: Set a wooden post, and 2 bearing trees.

1961 B.L.M. remonumentation record by David Cunningham: The 1/4 sec. cor. of secs. 1 and 12, monumented with a disintegrated wooden post, firmly set in the ground and witnessed by one of the original bearing trees.

At the corner point, set an iron post, 30 ins. long, 2 1/2 ins. diam., 26 ins. in the ground, with a brass cap mkd. as shown:

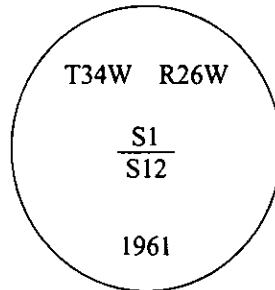

Established two bearing trees.

1983 CCR by Jack Ninneman (4661S): Painted monument and accessories. Established one new bearing tree:

A fir, 6 ins. diam., bears N34°E, 86.6 ft. dist., mkd. "1/4 S1 BT".

II. Found a 2 1/2 in. diam. iron pipe with a 3 1/4 in. diam. brass cap, protruding 4 ins. above the ground, mkd. as shown above, from which:

A fir stump, 18 ins. diam., bears N29°E, 18.5 ft. dist., mkd. with visible scribing. (B.L.M. rec.)

A fir, 10 ins. diam., bears N43°E, 86.6 ft. dist., mkd. with a healed face. (4661S rec.-N34°E)

A fir stump, 17 ins. diam., bears S14°E, 69.3 ft. dist., mkd. with a healed face. (B.L.M. record)

A fir stump, 24 ins. diam., bears S9°W, 14.5 ft. dist., mkd. with a healed face. (G.L.O. rec.-S5 1/4°W)

III. Established one new bearing tree:

A fir, 11 ins. diam., bears S55°E, 17.9 ft. dist., scribed "1/4 S12 BT".

Painted bearing trees and attached Land Survey Monument and Bearing Tree signs.

Magnetic Declination: 20° East.

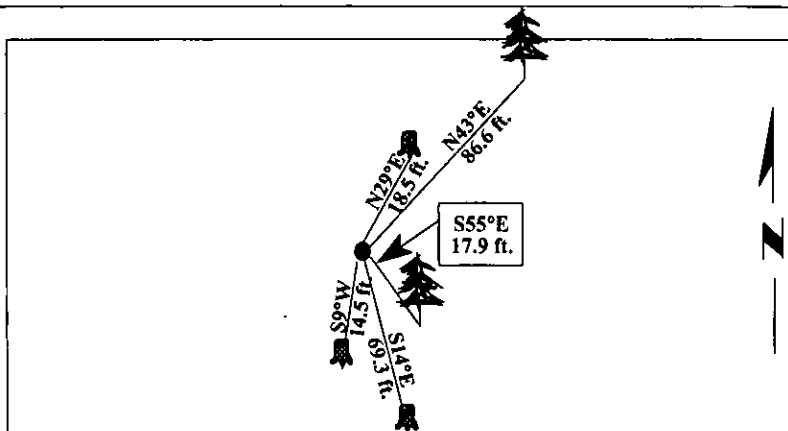

SKETCH OF CORNER

CERTIFICATION

I, Thomas M. Hommel
certify the information shown herein is true and correct.

I, Alvah F. Hughes
certify that this Corner Record correctly represents work performed by me or under my direction in compliance with the "Corner Recordation Act" (70-22-1019 et seq., M.C.A.)

Signature of Surveyor & Seal: Alvah F. Hughes

Date: 12/11/96

Reg. No.: 7322LS

Employer: U.S. FOREST SERVICE

Office of Clerk and Recorder, County of LINCOLN. This "corner record" was filed for record on FEB 3, 1997 and was noted on the cross-index plat and is assigned page No. 9169, in book No. CORAL M. CUMMINGS

County Official [Signature]

