

CERTIFIED LAND CORNER RECORDATION
(REFERENCE FSM 7153.53)

DESCRIPTION OF CORNER EVIDENCE FOUND, AND ORIGINAL RECORD (IF KNOWN)

NONE

DESCRIPTION OF MONUMENT AND ACCESSORIES ESTABLISHED
TO PERPETUATE THE ORIGINAL LOCATION OF THIS CORNER:

Set a 3" X 30" Aluminum pipe, 26" in ground with a collar of stone
Pipe marked as shown:

Date of work: 1979

From which: A 9" Fir, N11°51'W, 35.1', scribed X BT
A 8" Larch, N81°39'E, 66.2', scribed NW 1/16 23 BT

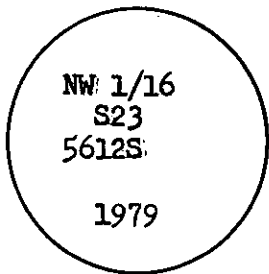

SKETCH, WITH COURSE AND DISTANCE TO ADJACENT CORNERS IF DETERMINED IN THIS SURVEY.
(MAY SKETCH OR PASTE REPRODUCTION ON REVERSE SIDE.)

See Certificate of Survey No. 750

Surveyor's Seal

I, _____
certify that the information shown herein is true and
correct.

Signature of Ground Party Chief

I, Thomas C. Hill
certify that I have carefully performed or reviewed the
work done on the diagrammed corner as reported on this
recordation form and approve the same.

Thomas C. Hill
Signature of Surveyor

5612S
Registration Number

DIAGRAM OF CORNER:

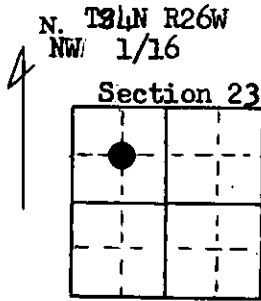

● = Corner recorded on the sheet

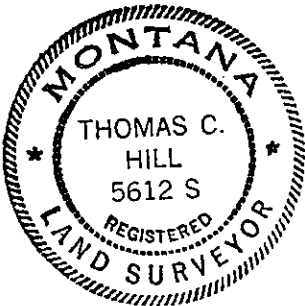

Office of Clerk and Recorder, County of Lincoln

This "corner record" was filed for record on the 3rd day of March 1980, was noted on the cross-index plat and is

assigned page No. 684, in book No. 1

Cleanor L. Vaughn, County Official
Sherry L. Hawks, Deputy

Cross Index No. 018 T. 34 R. 26 Mer.

[illegible]

... ..

11/11/1964