

CERTIFIED LAND CORNER RECORDATION
(REFERENCE FSM 7153.53)

DESCRIPTION OF CORNER EVIDENCE FOUND, AND ORIGINAL RECORD (IF KNOWN)

NONE

DESCRIPTION OF MONUMENT AND ACCESSORIES ESTABLISHED
TO PERPETUATE THE ORIGINAL LOCATION OF THIS CORNER:

Date of work: 1979

Set a 3" X 30" Aluminum pipe, 22" in ground, marked as shown:
from which a 6" Pine, bears N17°59'W, 15.0 Ft., scribed X BT
a 8" Larch bears S33°00'E, 6.2 Ft., scribed CW 1/16 S26 BT

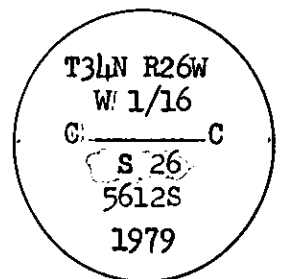

SKETCH, WITH COURSE AND DISTANCE TO ADJACENT CORNERS IF DETERMINED IN THIS SURVEY.
(MAY SKETCH OR PASTE REPRODUCTION ON REVERSE SIDE.)

See Certificate of Survey No. 748

Surveyor's Seal

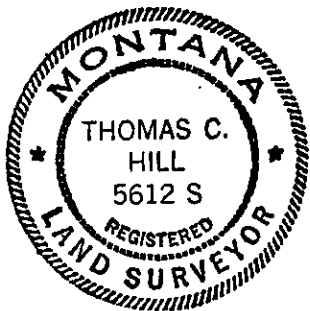

I, _____
certify that the information shown herein is true and correct.

Signature of Ground Party Chief

I, Thomas C. Hill
certify that I have carefully performed or reviewed the work done on the diagrammed corner as reported on this recordation form and approve the same.

Signature of Surveyor

5612-S
Registration Number

DIAGRAM OF CORNER:

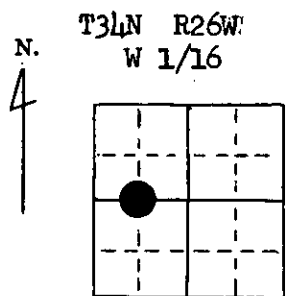

Section 26
● = Corner recorded on the sheet

Office of Clerk and Recorder, County of Lincoln

This "corner record" was filed for record on the 3rd day of March 1980, was noted on the cross-index plat and is assigned page No. 678, in book No. 1

Eleanor L. Chughn, Sherry L. Howes
County Official Deputy

Cross Index No. T18 T. 34 R. 26 Mer.

10

THE UNITED STATES OF AMERICA

1000000

1000000

1000000

1000000

1000000

1000000

1000000

1000000

1000000



1000000