

CERTIFIED LAND CORNER RECORDATION

DESCRIPTION OF CORNER EVIDENCE FOUND, AND ORIGINAL RECORD (IF KNOWN)

ORIGINAL G.L.O. NOTES: "SET a post 3 ft. long, 3 ins. square, 24 ins. in the ground, for 1-4 Sec. Cor., marked 1-4 S on N. face; from which
A fir 10 ins. diam. bears S.18°E 16 lks. dist. marked 1-4S.B.T.
A fir 10 ins. diam. bears N.2°30'E 14 lks. dist. marked 1-4S.B.T."

FOUND: FOUND S.E. BEARING TREE WITH SCRIBING VISIBLE AND N.E. BEARING TREE STUMP WITH SCRIBING VISIBLE AND SQUARE DISCOLORED HOLE IN THE GROUND WHERE THE POST ROTTED

DESCRIPTION OF MONUMENT AND ACCESSORIES ESTABLISHED TO PERPETUATE THE ORIGINAL LOCATION OF THIS CORNER:

ORIGINAL EVIDENCE FOUND

12" stump scribing visible

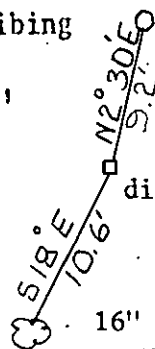

disintegrated post

16" Fir scribing visible

NEW EVIDENCE SET

6" larch scribed
"1/4 S9 RM"

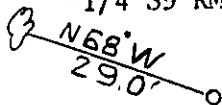

1" X 30" Alu. Mon
with 3 1/2" cap
marked as shown.

Date of work: Aug. 1979

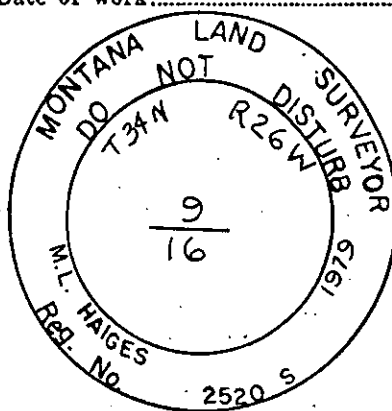

SKETCH, WITH COURSE AND DISTANCE TO ADJACENT CORNERS IF DETERMINED IN THIS SURVEY.
(MAY SKETCH OR PASTE REPRODUCTION ON REVERSE SIDE.)

Surveyor's Seal

I, JAMES BURTON
certify that the information shown herein is true and correct.

James Burton
Signature of Ground Party Chief

I, M. L. HAIGES
certify that I have carefully performed or reviewed the work done on the diagrammed corner as reported on this recordation form and approve the same.

M. L. Haiges
Signature of Surveyor

2520 S
Registration Number

DIAGRAM OF CORNER:

T34N R26W

N.



9
16

S. 1/4 COR. SEC. 9

= Corner recorded on the sheet

Office of Clerk and Recorder, County of Lincoln

This "corner record" was filed for record on the 24th day of September, 1979, was noted on the cross-index plat and is assigned page No. 553, in book No. 1

Clarence L. Taugher, Jr.
County Official

