

INSTRUCTIONS

1. Original and/or sub-record used to evaluate the corner position.
2. Description of evidence found, note discrepancies in the record, state method of establishing lost or obliterated corner.
3. Description of monument and accessories set to perpetuate the corner position.
4. Sketch or corner, show all pertinent data which can best be shown in a sketch example, corner marking, topography lies, position of accessories, etc.
5. Certification must be signed and sealed by Registered Land Surveyor in State of Montana.
6. Fill in Cross Index & Section Diagram at bottom of sheet.

CERTIFIED CORNER RECORDATION

Corner E1/16 22/27 T. 34N R. 26W P.M.M. Lincoln County

Record of Original Corner

No previous record on file.

Description of Corner Evidence Found

No evidence found on ground.

Description of Monument and Accessories Set

Set a standard 3 1/4" dia. Forest Service aluminum cap on a 3/4" x 30" aluminum shaft 25" in the ground with a rock cairn from which:

A 12" larch bears S27°W, 38.2 ft. dis. scribed E1/16S27BT

A 10 1/2" douglas fir bears N27°W, 32.4 ft. dis. scribed E1/16S22BT

Bearing trees were signed and blazes painted red. Placed a 6 ft. steel post with Land Survey Monument decal attached 6 ft. south of corner. Corner falls on flat ground in scattered timber. Placed a K tag on an 8 1/2" larch on north side of road 920' south of corner. Placed a K tag on a 13 1/2" douglas fir on east side of road 810' west of corner.

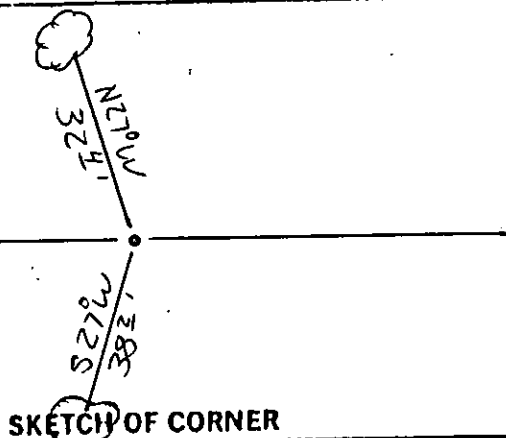
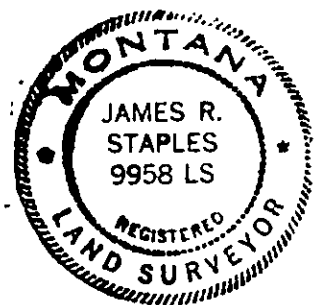

SKETCH OF CORNER

CERTIFICATION

I, Steven R. Moyer

certify the information shown herein is true and correct.

Steven R. Moyer
Signature Ground Party Chief

I, James R. Staples

certify that this Corner Record correctly represents work performed by me or under my direction in compliance with the "Corner Recordation Act" (70-22-101, et seq., M.C.A.)

James R. Staples
Signature of Surveyor & Seal

Date: 10/5/90 Reg. No. 9958LS

Employer: J.R.S. & Associates

Office of Clerk and Recorder, County of Lincoln. This "corner record" was filed for record on the Nov 9 day of 1990 was noted on the cross-index plat and is assigned page No. 4320, in book No.

David R. Sigel by Bill Buckell
County Official

Sec. 27

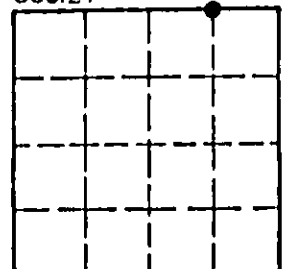

• corner this sheet

Cross-Index No. R-16 T. 34N R. 26W P.M.M.

