

INSTRUCTIONS

1. Original and/or subsequent record used to evaluate the corner position.
2. Description of evidence found, note discrepancies in the record, state method of establishing lost or obliterated corners.
3. Description of monument and accessories set to perpetuate the corner position.
4. Sketch of corner, show all pertinent data which can best be shown in a sketch example, corner marking, topography lies, position of accessories, etc.
5. Certification must be signed and sealed by Registered Land Surveyor in State of Montana.
6. Fill in Cross Index & Section Diagram at bottom of sheet.

CERTIFIED CORNER RECORDATION

 Corner $\frac{13}{24} \frac{18}{19}$

 T. 34N R. 26/25W P.M.M. Lincoln County

1. 80.00 chains: Set a post 4 feet long by 4" square, 24 inches in the ground for the corner to secs. 13, 18, 19, and 24 marked T34N S18 on the N.E. R25W S19 on the S.E. R26W S24 on the S.W. S13 on the N.W. faces with 3 notches on the N. and S. edges, from which:

An 8" pine bears N47W, 7 links, marked T34N R25W S18 BT
 A 10" pine bears S26E, 27 links, marked T34N R25W S19 BT
 A 12" pine bears S70W, 13 links, marked T34N R26W S24 BT
 A 10" pine bears N70W, 8 links, marked T34N R26W S13 BT

2. Found no evidence of the original corner or any subsequent monumentation. The corner falls in the middle of a large field. At the request of the landowner we did not set a monument in the field.
3. I set two 3"X30" aluminum capped monuments on the section line north and south of the position for the section corner as established by single proportion on the Horse Plains Guide Meridian, and marked as shown below.
- The first monument was set S100°06'59"E, 906.00 feet from the corner position in an E-W fenceline from which:
 A 14" fir bears S60E, 9.5 feet, T34N R25W S19 RM
 A 10" fir bears S79W 18.5 feet, T34N R26W S24 RM
- The second monument was set N00°06'59"W, 651.00 feet from the corner position, in an E-W fenceline. No bearing trees per landowner request.

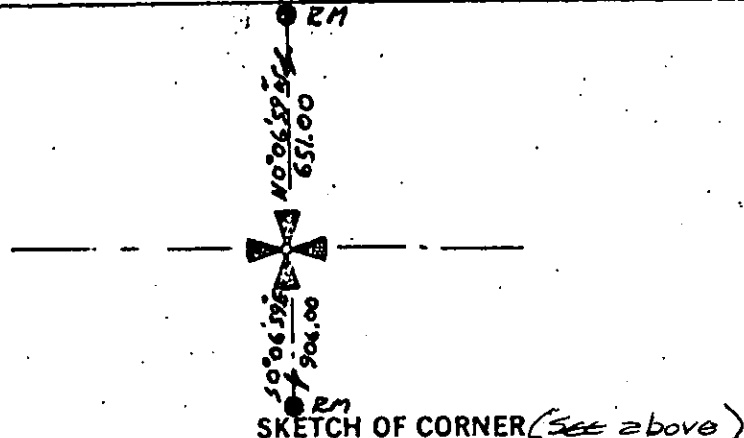
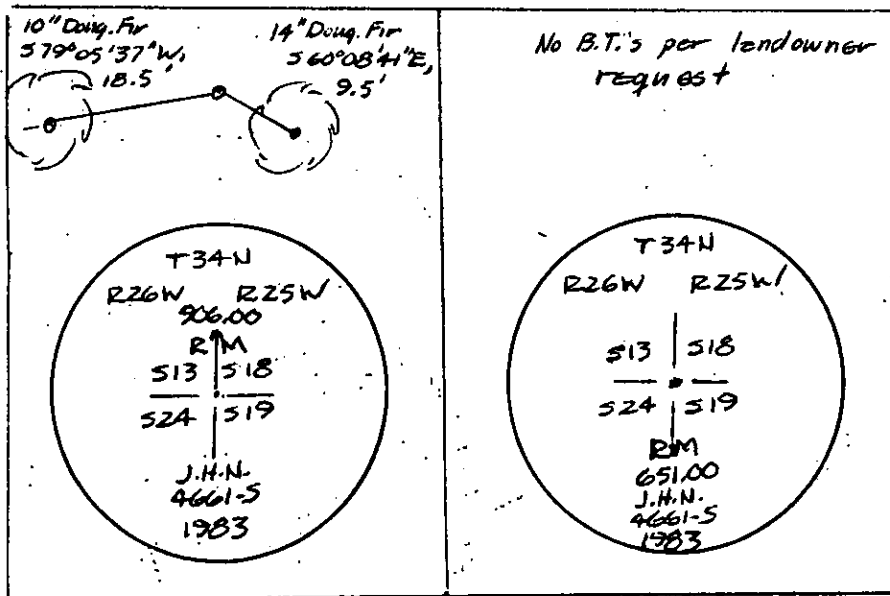

CERTIFICATION

 I, James R. Staples

certify the information shown herein is true and correct.

James R. Staples
 Signature Ground Party Chief

 I, Jack H. Ninneman

certify that this Corner Record correctly represents work performed by me or under my direction in compliance with the "Corner Recordation Act" (70-22-101, et seq., M.D.A.)

Jack H. Ninneman
 Signature of Surveyor & Seal

 Date: 11/15/83 Reg. No. 46613

 Employer: NINNEMAN ENGINEERING

SKETCH OF CORNER (See above)

Office of Clerk and Recorder, County of Lincoln. This "corner record" was filed for record on the March 1st day of 1984 was noted on the cross-index plat and is assigned page No. #2524, in book No. _____

Janet B. Siegel
 County Official

Karen L. Kemple
 Deputy

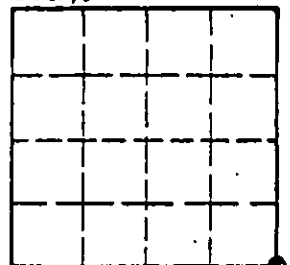
 Sec. 13

• • corner this sheet

RECEIVED
JAN 19 1971
FBI
FEDERAL BUREAU OF INVESTIGATION
U.S. DEPARTMENT OF JUSTICE