

INSTRUCTIONS

1. Original and/or subsequent record used to evaluate the corner position.
2. Description of evidence found, note discrepancies in the record, state method of establishing lost or obliterated corners.
3. Description of monument and accessories set to perpetuate the corner position.
4. Sketch or corner, show all pertinent data which can best be shown in a sketch example, corner marking, topography (ties, position of accessories, etc).
5. Certification must be signed and sealed by Registered Land Surveyor in State of Montana.
6. Fill in Cross Index & Section Diagram at bottom of sheet.

CERTIFIED CORNER RECORDATION

Corner

12	7
13	18

 T. 34 N R. 26/25 W P.M.M. Lincoln County

1. 80.00 chains: Set a limestone, 12"x10"x6", 8 inches in the ground for the corner to sections 7, 12, 13, and 18, marked with 4 notches on the south and 2 notches on the north, from which:

A 6" fir bears N 33° E, 6 links, marked T 34 N R 25 W S7 BT
 A 6" fir bears S 34° E, 46 links, marked T 34 N R 25 W S18 BT
 A 8" fir bears S 80° W, 29 links, marked T 34 N R 26 W S13 BT
 A 10" fir bears N 28° W, 12 links, marked T 34 N R 26 W S 12 BT

2. BLM 1960 - The cor. of secs. 7, 12, 13, and 18, on the W. bdy. of the Tp., monumented with a limestone, 12 x 8 x 6 ins., firmly set and mkd. with 2 grooves on the N. and 4 grooves on the S faces, and witnessed by the remains of three of the original bearing trees.

At the corner point

Set an iron post, 30 ins. long, 2½ ins. diam., 26 ins. in the ground, in concrete, with brass cap mkd. (as shown below) from which:

the remains of the original bearing trees:

A fir, 12 ins. diam., bears N 40½° E, 6 lks. dist., mkd. T 34N R25W S7 BT
 (Record: N 33° E, 6 lks.)
 A stump 12 ins. diam., bears S 34° E, 46 lks. dist., mkd. with an overgrown blaze. (Record)
 A stump, 20 ins. diam., bears S 78½° W, 29 lks. dist., visible marks BT. (Record: S 80° W, 29 lks.)

the new bearing trees:

A fir, 9 ins. diam., bears N 68½° E, 25 lks. dist., mkd.
 T34N R25W S7 BT
 A fir, 9 ins. diam., bears S 8° E, 16 lks. dist. mkd.
 T34N R25W S18 BT.
 A fir, 8 ins. diam., bears S 27½° W, 66 lks. dist., mkd.
 T34N R 26 W S13 BT.
 A fir, 9 ins. diam., bears N 60° W, 34 lks. dist., mkd.
 T34N R26W S12 BT

Bury the original stone alongside and raise a mound of stone, 3 ft. base, 2 ft. high, W. of the iron post.

3. Found a 1960 BLM brass cap marked as shown below, from which:

An 11" fir bears N 40½° E, 3.96 feet, with visible scribing (original)
 An 11" fir stump bears S 34° E, 30.36 feet with visible scribing (original)
 A 13" fir stump bears S 80° W, 10.14 feet with "BT" visible (original)
 A 9" fir bears N 68½° E, 16.9 feet, with visible scribing (1960-BLM)
 An 11" fir stump bears S 8° E, 10.4 feet with "BT" visible (1960-BLM)
 An 11" fir bears N 60° W, 22.44 feet, with visible scribing (1960-BLM)
 An 11" fir bears S 27½° W, 43.60 feet, with overgrown blaze (1960-BLM)

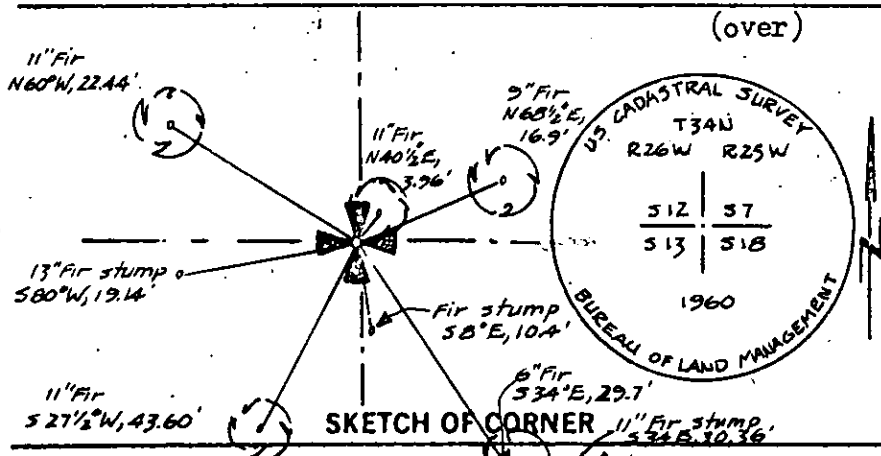

CERTIFICATION

1. James R. Staples

certify the information shown herein is true and correct.

James R. Staples
 Signature Ground Party Chief

1. Jack H. Ninneman

certify that this Corner Record correctly represents work performed by me or under by direction in compliance with the "Corner Recordation Act" (70-22-101, et seq., M.D.A.)

Jack H. Ninneman
 Signature of Surveyor & Seal

Date: 12/16/83 Reg. No. 46615

Employer: Ninneman Engineering

Office of Clerk and Recorder, County of Lincoln. This "corner record" was filed for record on the March 15 day of 1984 was noted on the cross-index plat and is assigned page No. # 2520, in book No. Sanit B. F. Siegel by Karen L. Kampke

County Official Deputy

Sec. 12

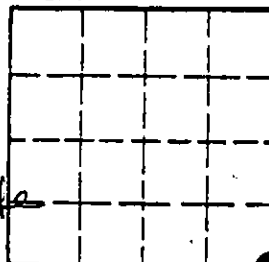

4. I scribed 1 new bearing tree in section 18

A 6" fir bears S 34° E, 29.7 feet, marked T34N R25W S18 BT

I painted the bearing trees and accessories with bright red paint and attached a Land Monument sign to a metal fence post next to the corner.

