

INSTRUCTIONS

1. Original and/or subsequent record used to evaluate the corner position.
2. Description of evidence found, note discrepancies in the record, state method of establishing lost or obliterated corners.
3. Description of monument and accessories set to perpetuate the corner position.
4. Sketch of corner, show all pertinent data which can best be shown in a sketch example, corner marking, topography ties, position of accessories, etc.
5. Certification must be signed and sealed by Registered Land Surveyor in State of Montana.
6. Fill in Cross Index & Section Diagram at bottom of sheet.

CERTIFIED CORNER RECORDATION

Corner SE 1/16, Sec. 12 T. 34 N R. 26 W P.M.M. Lincoln County

1. This corner was not previously set.

2. Set a 3"X30" aluminum capped monument marked as shown below, from which:
 A 7" Tamarack bears N $54\frac{1}{2}^{\circ}$ W, 14.83 feet, marked "SE 1/16 S 12 BT" and posted.
 A 6" Fir bears S $48\frac{1}{2}^{\circ}$ E, 15.42 feet, marked "SE 1/16 S 12 BT" and posted.
 I painted the monument and accessories with bright red paint and attached a Land Monument sign to a metal fence post next to the corner.

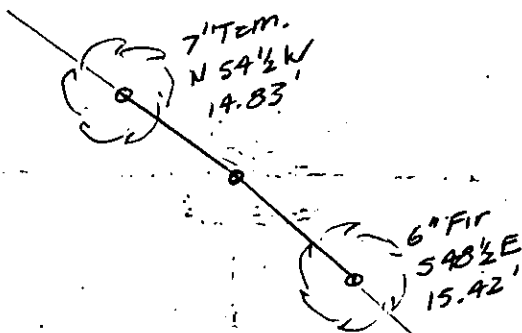
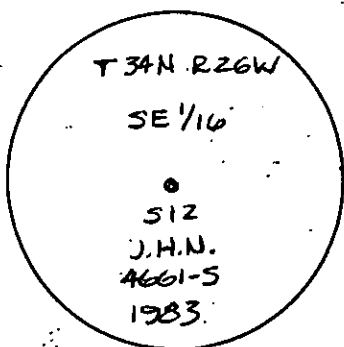

SKETCH OF CORNER

CERTIFICATION

James R. Staples

I certify the information shown hereby is true and correct.

James R. Staples
 Signature Ground Party Chief

Jack H. Ninneman

I certify that this Corner Record correctly represents work performed by me or under my direction in compliance with the "Corner Recordation Act" (70-27-101, et seq., M.D.A.)

Jack H. Ninneman
 Signature of Surveyor & Seal

Date: 11/15/83 Reg. No. 46615

Employer: NINNEMAN ENGINEERING

of Clerk and Recorder, County of Lincoln. This "corner
 ord" was filed for record on the March 1st day of 1984

noted on the cross-index plat and is assigned page No. #2506, in

No. _____

Janet B. F. Siegel by Karen L. Kample
 County Official *deputy*

Sec. 12

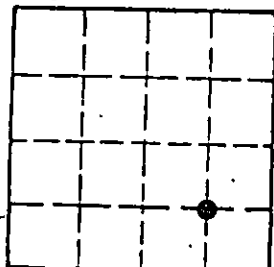

corner this sheet

