

INSTRUCTIONS

1. Original and/or subsequent record used to evaluate the corner position.
2. Description of evidence found, note discrepancies in the record, state method of establishing lost or obliterated corners.
3. Description of monument and accessories set to perpetuate the corner position.
4. Sketch of corner, show all pertinent data which can best be shown in a sketch example, corner marking, topography ties, position of accessories, etc.
5. Certification must be signed and sealed by Registered Land Surveyor in State of Montana.
6. Fill in Cross Index & Section Diagram at bottom of sheet.

CERTIFIED CORNER RECORDATION

Corner WC 1/4 cor. Sec. 3 T. 34N R. 26W P.M.M. Lincoln County

- (1) This corner set in original survey now falls in Marl Lake approximately 90 feet North of South shore. Therefore I set a monument on line between NW cor. of Sec. 3 and W.C. on south end of Deep Lake.
- (3) Set 3 1/2" aluminum cap on a 30" alum. pipe stamped as shown below from which
 A 13" Larch (scribed SC 1/4 S4BT) bears S34°W 37.4 ft.
 An 11" larch (scribed WC 1/4 S3BT) bears S38°E 36.3 ft.
 A location poster on a 1 1/4" larch bears S22°E 16.5 ft.

Painted monument and accessories with bright red paint.

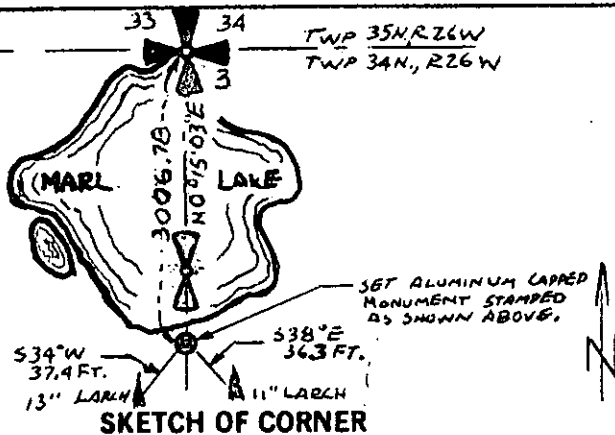
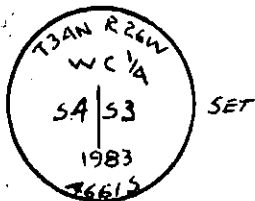

SKETCH OF CORNER

CERTIFICATION

Walter Gibbons

I, Walter Gibbons
 certify the information shown herein is true and correct.

Signature Ground Party Chief

I, Jack H. Ninneman

certify that this Corner Record correctly represents work performed by me or under my direction in compliance with the "Corner Recordation Act" (70-22-101, et seq., M.D.A.)

Jack H. Ninneman
 Signature of Surveyor & Seal

Date: 1/26/84 Reg. No. 46615

Employer: Ninneman Engineering Inc.

Office of Clerk and Recorder, County of Lincoln. This "corner record" was filed for record on the March 1st day of 1984 was noted on the cross-index plat and is assigned page No. #2484, in book No. _____

Cross Index No. _____ T. 34N R. 26W P.M.M.

Sec. 3

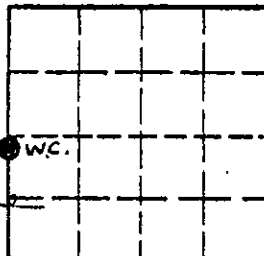

• - corner this sheet

County Official

deputy

