

# CERTIFIED CORNER RECORDATION

Corner E1/16 Secs. 23 <sup>14</sup> T 34 N. R. 26 W. P.M.M. LINCOLN County

- I. Record: No previous record.
- II. No evidence found.
- III. At the position determined by survey, set a 3/4 in. diam. aluminum rod, 42 ins. long, 35 ins. in the ground, with a 3 1/4 in. diam. aluminum cap marked as shown. Raise a collar of stone 1.5 ft. diam. around monument.

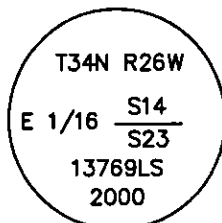

The new bearing trees:

- A larch, 14 ins. diam., N15°E, 138.6 ft., marked E 1/16 S14 BT.
- A fir, 8 ins. diam., N50°E, 105.6 ft., marked "X" BT.

Set a 6 ft. galvanized steel guard post 3.0 ft. north and east, with Property Boundary and Land Survey Monument decals attached. Attached Bearing Tree and Land Survey Monument signs to the bearing trees. Attached brass disc directly above scribed "B" on both bearing trees. Disc reads LS 13769. Painted red bands around the bearing trees.

Date of Fieldwork: 7/13/2000  
 Survey crew: Linda Smith, Robin Glazier  
 Magnetic declination: 17° East assumed  
 Equipment used: Hand compass and loggers tape  
 U.S. Forest Service, Supervisors Office, 1101 Hwy. 2 West, Libby, MT 59925 (406) 293-6211

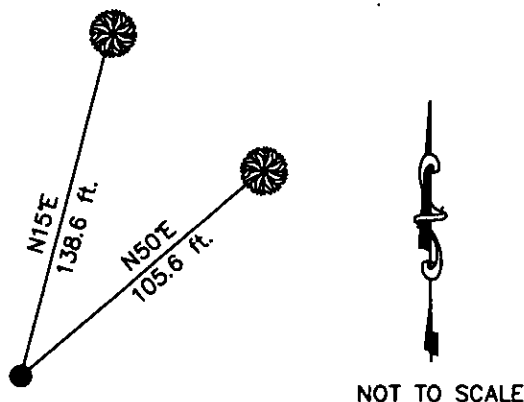
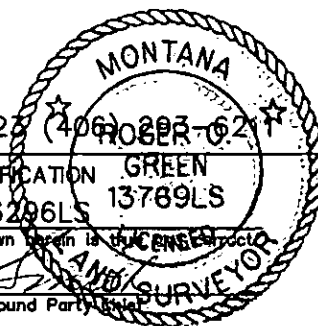

CERTIFICATION GREEN  
 Linda Smith 6296LS 13769LS  
 certify the information shown herein is true and correct.  
*Linda Smith*  
 Signature Ground Party  
 Roger O. Green  
 certify that this Corner Record correctly represents work performed by me or under my direction in compliance with the "Corner Recordation Act" (70-22-101, et seq., M.C.A.)  
*Roger O. Green*  
 Signature of Surveyor & Seal  
 Date: 4/02/2003 Reg. No. 13769LS  
 Employer: U. S. Forest Service

Office of Clerk and Recorder, County of Lincoln This "corner record" was filed for record on 7-10-03  
 was noted on the cross-index plat and is assigned page No. \_\_\_\_\_, in book No. 168793

County Official

Sheet 2 of 2

Cross Index No. N-20 T. 34N. R. 26W. P.M., MT

Adopted July 1, 1981, Montana Board of Professional Engineers & Land Surveyors

Sec. 14

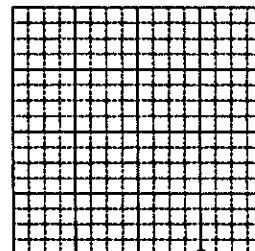

• corner this sheet



7-10-03

170000

100-100