

CERTIFIED CORNER RECORDATION

Corner C 1/4 T. 34 N., R. 26 W., P.M.M. Lincoln County

Record :

Per C. of S. No. 679 Lincoln County Records for Section breakdown.

Found Evidence :

3 ins. x 3 ins. square steel plate welded to a 15 ins. long 5/8 inc. rebar, 3 feet Westerly of Corner (origin unknown).

Perpetuation :

Set a 3 1/4 inch alum. monument 3 ins. dia. 30 ins. long 26 ins. in the ground stamped: (See sketch)

Established the following bearing trees; from which:

A 8 1/2 inch DBH spruce which bears S 53° W, 6.2 feet dist. scribed C 1/4 S 9 BT.

A 11 1/2 inch DBH spruce which bears N 69° E 13 feet dist. scribed C 1/4 S 9 BT. Attached bearing tree signs.

Declination: 18° E

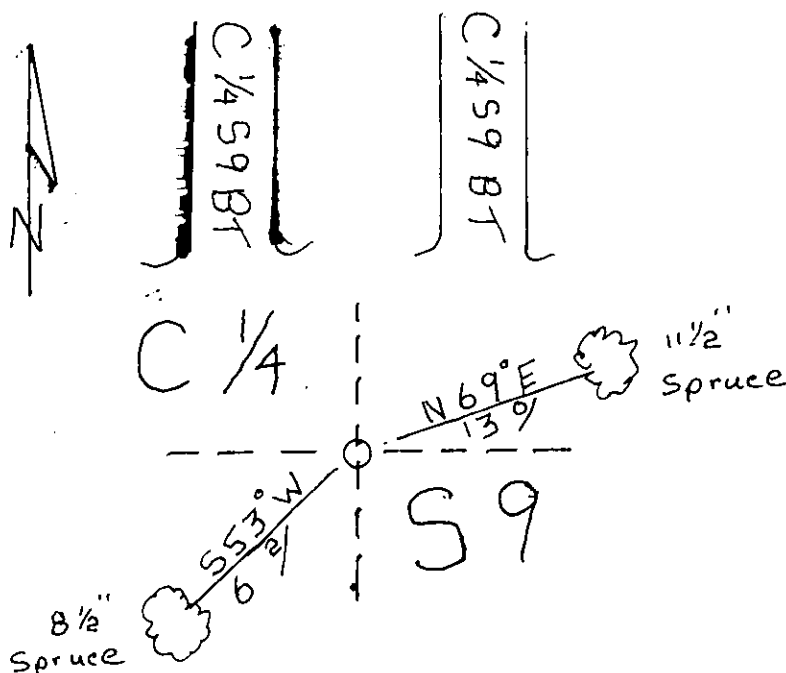

Sketch of Corner

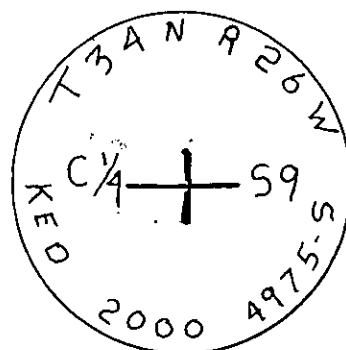

3 1/4 alum

CERTIFICATION

I, George Clark certify the information shown herein is true and correct

Signature of Ground Party Chief

I, Kenneth E. Davis

certify that this Corner Record correctly represents work performed by me or under my direction in compliance with the "Corner Recordation Act"

KENNETH E. DAVIS, M.C.A.

(7-22-10 DAVIS, M.C.A.)

4975 S

State of Wisconsin

Date: 4/7/2000

Employer: Davis Surveying, Inc.

Section

Office of Clerk and Recorder, County of Lincoln

This "corner record" was filed for record on Apr 7, 2000 10439

was noted on the cross-index plat and is assigned page No. 10439

in book No. Coral M. Cumming By DUB

County Official

Cross Index No. T 34 N., R 26 W., P.M.M. THIS CORNER

