

CERTIFIED CORNER RECORDATION

Corner CS 1/16 Sec. 17 T. 34N R. 25W P.M., MT Lincoln County

- I. 1981 Certified Corner Recordation by John H. Ninneman, Book 1, page 1021: Set a 5/8 in. x 24 in. capped steel pin stamped "J.H.N. 4661S".

from which:

A fence post bears East, 6.1 ft. dist., with a location poster.

- II. Found a 5/8 in. diam. rebar.

- III. As determined by survey, I accept the position of the found rebar and set a 30 in. long, 3/4 in. diam. alum. rod, alongside of rebar, with 3 1/4 in. alum. cap, mkd. as shown:

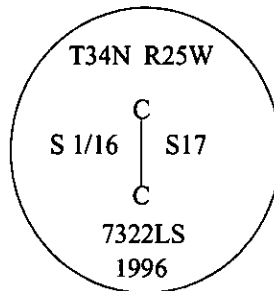

Established two bearing trees:

A spruce, 4 ins. diam., bears N24°E, 22.7 ft. dist., scribed "X BT".

A spruce, 7 ins. diam., bears S2°E, 11.2 ft. dist., scribed "CS 1/16 S17 BT".

Painted bearing trees and attached Land Survey Monument and Bearing Tree signs.

Set a 6 ft. steel guard post, South, 3.0 ft., with Land Survey Monument and Property Boundary decals.

Magnetic Declination: 20° East.

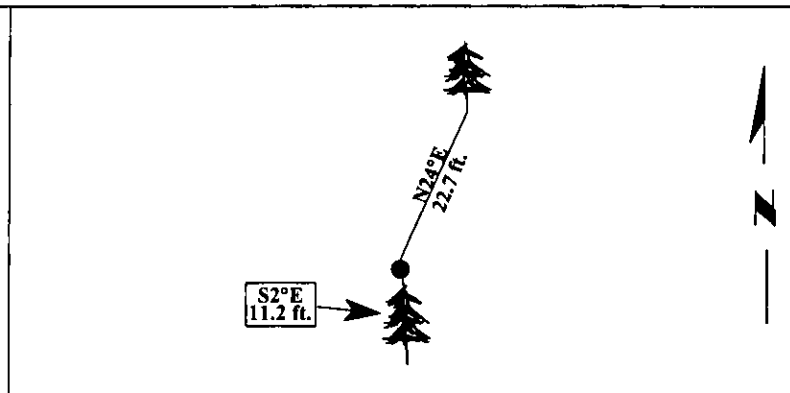

SKETCH OF CORNER

CERTIFICATION

I, Thomas Hommel

certify the information shown herein is true and correct.

I, Alvah F. Hughes

certify that this Corner Record correctly represents work performed by me or under my direction in compliance with the "Corner Recordation Act" (7-22-101, et seq., M.C.A.)

Alvah F. Hughes
Signature of Surveyor's Seal
7322 LS

Date: 12/31/96

Reg. No.: 7322LS

Employer: U.S. FOREST SERVICE

Sec. 17

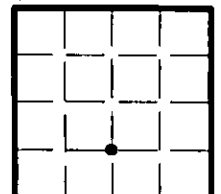

• - corner this sheet

Office of Clerk and Recorder, County of LINCOLN. This "corner record" was filed for record on FEB 3, 1997 and was noted on the cross-index plat and is assigned page No. 9152, in book No. CORAL M. CUMMINGS By DJB

County Official

