

# CERTIFIED CORNER RECORDATION

Corner C-E-SE 1/64 Sec. 17 T. 34N R. 25 W P.M., MT Lincoln County

- I. No previous history.
- II. No evidence found.
- III. At the corner position as determined by survey, set a 3/4 in. diam., 30 in. long alum. rod, 26 ins. in the ground, with a 3 1/4 in. diam. alum. cap, mkd. as shown:

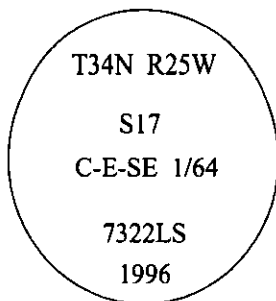

Established two bearing trees:

- A fir, 8 ins. diam., bears S55°W, 58.0 ft. dist., scribed "C-E-SE 1/64 S17 BT".
- A fir, 10 ins. diam., bears N17°W, 73.3 ft. dist., scribed "C-E-SE 1/64 S17 BT".

Painted bearing trees and attached Land Survey Monument and Bearing Tree signs.

Set a 6 ft. steel guard post, West, 3.0 ft., with Land Survey Monument and Property Boundary decals.

Magnetic Declination: 20° East.

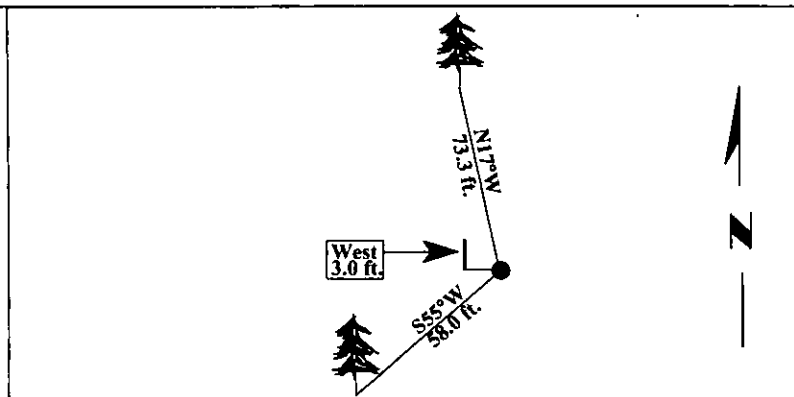

SKETCH OF CORNER

CERTIFICATION	
I. <u>Rex O. Rice</u>	certify the information shown herein is true and correct.
<u>Rex O. Rice</u>	
II. <u>Alvah F. Hughes</u>	certify that this Corner Record correctly represents work performed by me or under my direction in compliance with the "Corner Recordation Act" (70-22-101, et seq., M.C.A.)
<u>Alvah F. Hughes</u>	
Signature of Surveyor & Seal	
Date: <u>12/31/96</u>	
Reg. No.: <u>7322LS</u>	
Employer: <u>U.S. FOREST SERVICE</u>	

Office of Clerk and Recorder, County of LINCOLN. This "corner record" was filed for record on FEB 3, 1997 and was noted on the cross-index plat and is assigned page No. 9143, in book No. \_\_\_\_\_.

CORAL M. CUMMINGS  
County Official

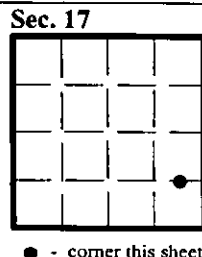

• - corner this sheet



10/10/10

10/10/10

10/10/10

10/10/10

10/10/10

10/10/10

10/10/10

10/10/10