

## INSTRUCTIONS

1. Original and/or subsequent record used to evaluate the corner position.
2. Description of evidence found, note discrepancies in the record, state method of establishing lost or obliterated corners.
3. Description of monument and accessories set to perpetuate the corner position.
4. Sketch of corner, show all pertinent data which can best be shown in a sketch example, corner marking, topography ties, position of accessories, etc.
5. Certification must be signed and sealed by Land Surveyor registered in the State of Montana.
6. Fill in Cross Index & Section Diagram at bottom of sheet.

## CERTIFIED CORNER RECORDATION

Corner NW Sec. Cor. of S17 T. 34 N. R. 25 W. P.M.M. Lincoln County

I. 1894 G.L.O. record by A. Jaqueth et al: Set a post and three bearing trees.

1960 BLM remonumentation: The cor. of secs. 7, 8, 17 and 18, as determined from the remains of two of the original bearing trees.

At the corner point, set an iron post, 30 ins. long, 2 1/2 ins. diam., 26 ins. in the ground, with brass cap mkd.

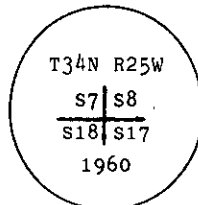

From which the remains of the original bearing trees:

A stump, 22 ins. diam., bears N33° E, 92 lks. (60.72 ft.) dist., visible marks BT.

[Record: N 30 1/4° E, 92 lks. (60.72 ft.)]

A stump, 14 ins. diam., bears S82 3/4° E, 325 lks. (214.50 ft.) dist., visible marks BT.

[Record: S84° E, 325 lks. (214.50 ft.)]

The new bearing trees:

A fir, 6 ins. diam., bears N52 1/4° E, 169 lks. (111.54 ft.) dist., mkd. T34N R25W S8 BT.

A fir, 9 ins. diam., bears S82 3/4° E, 337 lks. (222.42 ft.) dist., mkd. T34N R25W S17 BT.

An aspen, 8 ins. diam., bears N24 1/4° W, 101 lks. (66.66 ft.) dist., mkd. T34N R25W S7 BT.

II. Found a 2 1/2 ins. diam. pipe, 2 ins. out of the ground, with BLM brass cap mkd. as shown, from which

A root crown, bears N30° E, 60.2 ft. dist.

A fir, 15 ins. diam., bears N53° E, 112.0 ft. dist., healed face.

A fir, 14 ins. diam., bears S82° E, 223.0 ft. dist., healed face.

An aspen, 11 ins. diam., bears N19° W, 67.9 ft. dist., healed face.

A stump, 16 ins. diam., bears N4° W, 55.0 ft. dist.

III. Painted red bands around the bearing trees and attached Land Survey Monument and Bearing Tree signs.

Set a 6 ft. galvanized steel guard post with Land Survey Marker and Property Boundary decals, North, 3 ft.  
Magnetic Declination: 20° East

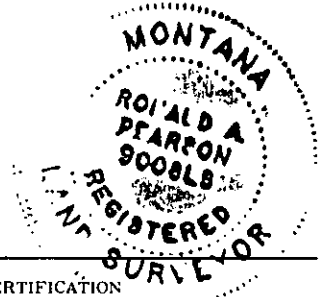

## CERTIFICATION

I, Kevin A. Todd  
certify the information shown herein is true and correct.

Kevin A. Todd  
Signature Ground Party Chief

I, Ronald A. Pearson  
certify that this Corner Record correctly represents work performed by me or under my direction in compliance with the "Corner Recordation Act" (70-22-101, et seq., M.C.A.)

Ronald A. Pearson  
Signature of Surveyor & Seal

Date: 10/1/92 Reg. No. 9008 LS

Employer: U. S. FOREST SERVICE

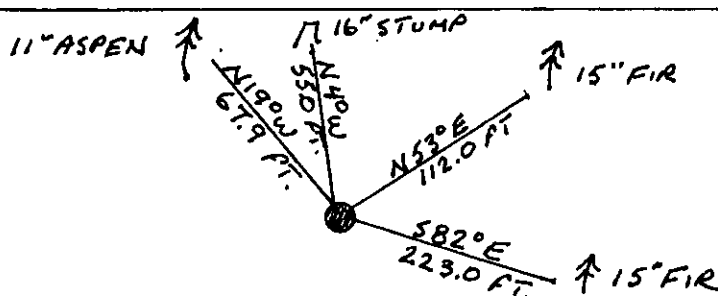

SKETCH OF CORNER

Office of Clerk and Recorder, County of Lincoln. This "corner record" was filed for record on 12-7-92

was noted on the cross-index plat and is assigned page No. 5109, in book No. Coral M. Cummings

County Official ✓

J-5 34 N 25 W  
Cross Index No. T. R. PMM

Sec. 17

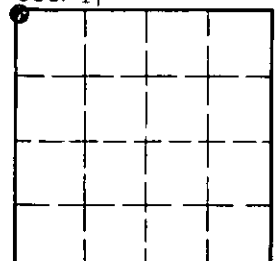

• - corner this sheet

+

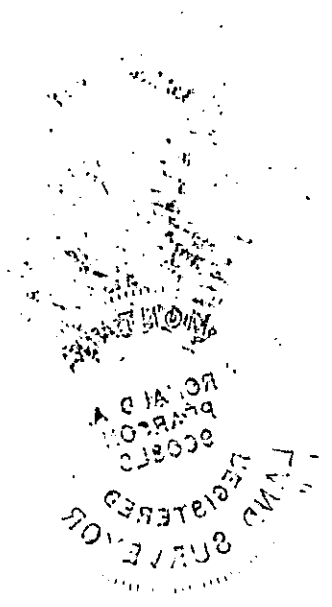

Handwritten notes and signatures, including the name "W. H. HARRIS" and other illegible text.