

CERTIFIED LAND CORNER RECORDATION

Corner for Sections 21,22,28,27 Twp. 34N., R.25W.M.P.M.

1894

DESCRIPTION OF CORNER EVIDENCE FOUND, AND ORIGINAL RECORD (IF KNOWN)

80:00 Set a limestone 12x10x8 ins. 8 ins. in the ground for cor. to secs.21,22,27 & 28 marked with 2 notches on S & 3 notches on E. edges - from which a tamarack 12 ins. diam. bears N.40° 45'E. 19 lks. dist. marked T.34 N. R.25 W.S 22 B.T. a fir 6 ins. diam. bears S. 10°30'E. 25 lks. dist. marked T.34 N. R. 25 W.S. 27 B.T. a fir 6 ins. diam. bears S. 24° 45'W. 17 lks. dist. marked T.34 N. R. 25 W.S. 28 B.T. a pine 8 ins. diam. bears N. 8°30' W. 41 lks. dist. marked T. 34N. R.25 W.S. 21 B.T.

Found original stone SEE REVERSE SIDE

DESCRIPTION OF MONUMENT AND ACCESSORIES ESTABLISHED TO PERPETUATE THE ORIGINAL LOCATION OF THIS CORNER:

Date of work: Nov.5,1965

Set a Std. brass U.S. F.S. tablet in concrete with large stone around pipe.

Tablet marked 21 22
28 27
1965

Original stone on top of mound all new bearing trees tagged with Std.BLM bearing tree signs. Corner is in South East corner of small natural clearing about 100 feet South of rocky clearing overlooking valley to North

(See sketch below for witness trees)

SKETCH, WITH COURSE AND DISTANCE TO ADJACENT CORNERS IF DETERMINED IN THIS SURVEY. (MAY SKETCH OR PASTE REPRODUCTION ON REVERSE SIDE.)

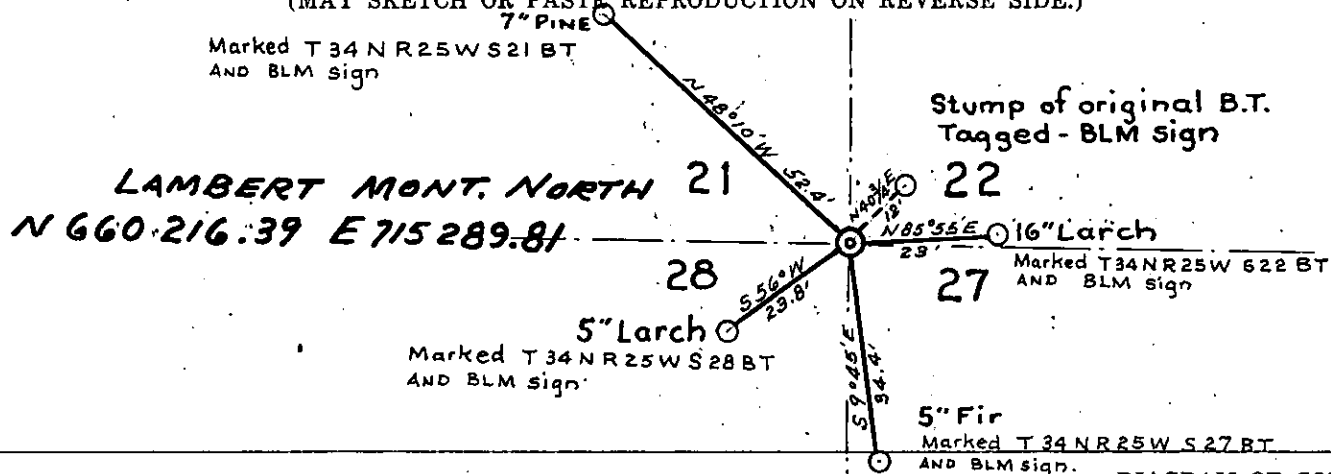

Surveyor's Seal

I, J. W. Ninneman
certify that the information shown herein is true and correct.

J. W. Ninneman
Signature of Ground Party Chief

I, J. W. Ninneman
certify that I have carefully performed or reviewed the work done on the diagrammed corner as reported on this recordation form and approve the same.

J. W. Ninneman
Signature of Surveyor

DIAGRAM OF CORNER:

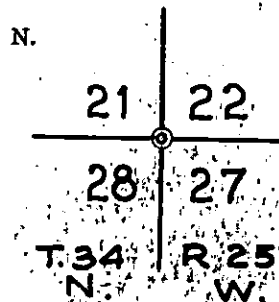

⊙ = Corner recorded on the sheet

Montana 534 E.S.
Registration Number

Office of Clerk and Recorder, County of Lincoln

This "corner record" was filed for record on the 4th day of April 19. 66, was noted on the cross-index plat and is assigned page No. 42, in book No. 1

ELEANOR L. VAUGHN, By: *V. L. Vaughn*
County Official Deputy

(See face of this form for new bearing trees)

Found original stone

Position confirmed by all BTs F.S. location poster on 16" larch marked 15 feet west to corner.

Actually original stone is S 78°30'W. 23 feet from this tree

Except the larch the remaining 3 original bearing trees are too rotted to tag.

SW Bearing tree-6" fir found blown down partially burned - partly positively legible

SE Bearing tree - 6" fir found - blown down, partially burned - blaze positive but marking illegible

NW Bearing tree - 8" pine - found blown down, badly burned and rotted but position checks report

NE Bearing tree 12" larch - only partially burned stump found but position checks reported (tagged this-BIM Tag)

STATE OF MONTANA
COUNTY OF LINCOLN
Filed this 4th day of April
at 10:40 A.M.
A. D. 19 66
By James D. Houghton
James Houghton
Deputy Clerk

42