

## INSTRUCTIONS

1. Original and/or subsequent record used to evaluate the corner position.
2. Description of evidence found, note discrepancies in the record, state method of establishing lost or obliterated corners.
3. Description of monument and accessories set to perpetuate the corner position.
4. Sketch of corner, show all pertinent data which can best be shown in a sketch example, corner marking, topography ties, position of accessories, etc.
5. Certification must be signed and sealed by Land Surveyor registered in the State of Montana.
6. Fill in Cross Index & Section Diagram at bottom of sheet.

## CERTIFIED CORNER RECORDATION

Corner SE of Sec. 36 T. 34N R. 25W P.M.M. Lincoln County

- I. 1894 Original GLO Record: Set a limestone, 14x12x8 ins. 10 ins. in the ground, for the cor. to Tps. 33 and 34 N., Rs. 24 and 25 W. marked with 6 notches on N.S.E. and W. edges; with four blazed bearing trees.

1934 Resurvey of the North Bdy. of T33N R25W: From the cor. of Tps. 33 and 34 N., Rs. 24 and 25 W., which is a limestone, 12x8x4 ins. in the ground, in a mound of stone, marked and witnessed, as described in the official record, with the exception that the bearing trees are charred. Additional bearing trees are established:

A pine, 6 ins. diam., bears N49°E 41 lks. dist., mkd. T34N R24W S31 BT.  
 A pine, 7 ins. diam., bears S32½°E 140 lks. dist., mkd. T33N R24W S6 BT.  
 A pine, 6 ins. diam., bears S70°45'W 129 lks. dist., mkd. T33N R25W S1 BT.  
 A fir, 14 ins. diam., bears N76½°W 67 lks. dist., mkd. T34N R25W S36 BT.

1961 BLM Remonumentation: The corner of Tps. 33 and 34 N., Rs. 24 and 25 W., monumented with a limestone, 20x12x8 ins., loosely set and marked with 6 notches on the N., E., S. and W. faces, and witnessed by the remains of the original bearing trees.

At the corner point

Set an iron post, 30 ins. long, 2½ ins. diam., 8 ins. in the ground, to bedrock, and in a mound of stone, 4 ft. diam., to top, with brass cap mkd.

T34N  
 R25W R24W  
S 36 1/2 S 31  
 S 11 S 6  
 T33N  
 1961  
 1977

from which:

The remains of the original bearing trees:

A pine, 6 ins. diam., bears N.30°E, 42 lks. dist., mkd. T34N R24W S31 BT. (Record: N.49°E., 41 lks.)  
 A dead fir, 14 ins. diam., bears N.41°E., 144 lks. dist., mkd. T34N R24W S31 BT. (Record)  
 A dead fir, 14 ins. diam., bears S.36°W., 61 lks. dist., visible marks BT. (Record: S.33°W., 61 lks.)  
 A dead fir, 16 ins. diam., bears N.74½°W., 67 lks. dist., mkd. T34N R25W S36 BT. (Record: N.76½°W., 67 lks.)  
 A stumphole, bears N67½°W., 93 lks. dist., remains of tree lying on ground, mkd. T34N R25W S36 BT. (Record: N.71½°W., 92 lks.)

The new bearing trees:

A pine, 6 ins. diam., bears N.36°E., 58 lks. dist., mkd. T34N R24W S31 BT.  
 A pine, 5 ins. diam., bears S.47½°E., 28 lks. dist., mkd. T33N R24W S6 BT.  
 A pine, 5 ins. diam., bears S.20½°W., 48 lks. dist., mkd. T33N R25W S1 BT.  
 A pine, 5 ins. diam., bears N.61°W., 56 lks. dist., mkd. T34N R25W S36 BT.

Bury the original stone alongside of the iron post.

See back side for additional corner data.

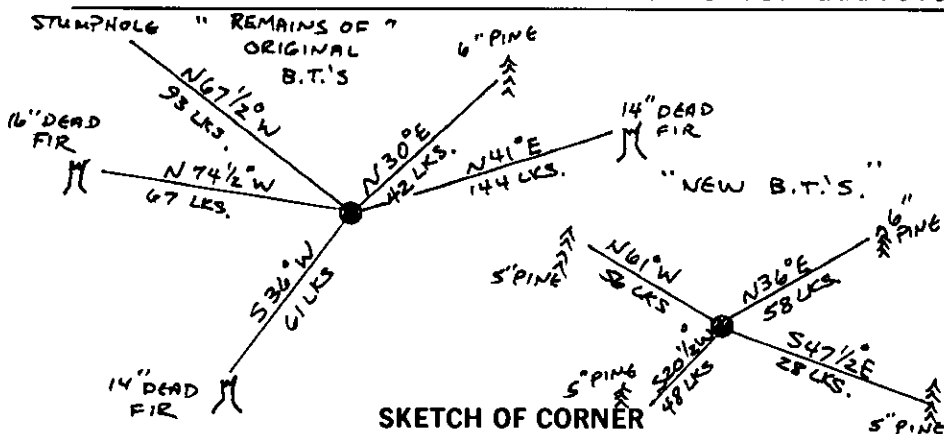

## CERTIFICATION

I, Douglas R. Maday  
 certify the information shown herein is true and correct.

Douglas R. Maday  
 Signature Ground Party Chief

I, Thomas C. Hill  
 certify that this Corner Record correctly represents work performed by me or under my direction in compliance with the "Corner Recordation Act" (70-22-101, et seq., M.C.A.)

Thomas C. Hill  
 Signature of Surveyor & Seal

Date: 8/86 Reg. No. 5612-S

Employer: U.S.F.S.

Office of Clerk and Recorder, County of Lincoln. This "corner

record" was filed for record on Sept. 18, 1986

was noted on the cross-index plat and is assigned page No. 3352, in

book No. \_\_\_\_\_

Grant E. Sigil by Bill Bickel  
 County Official Deputy

Cross Index No. \_\_\_\_\_ T. \_\_\_\_\_ R. \_\_\_\_\_ PMM

Sec. 36

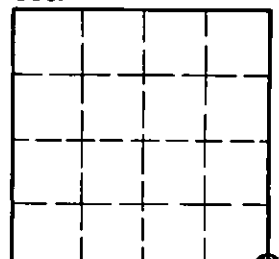

• - corner this sheet

# INSTRUCTIONS TO SURVEYORS FOR COMPLETION OF CERTIFIED CORNER RECORDATION FORMS

## I. ORIGINAL AND/OR SUBSEQUENT RECORD:

This item should describe or quote those portions of the original or subsequent record which were used in evaluating the corner position. The original record will usually be the General Land Office field notes. Subsequent record can come from several sources: Previously filed corner records, maps and plats, private and public records, etc. Some of the subsequent record, even though not in the public record, but known to have validity by the surveyor, may be quoted and appropriately noted.

The record data helps support the reestablished corner position because it clearly shows what history the surveyor based his corner position on. In some cases, however, the record may be unknown or not pertinent. A statement to that effect should appear on the corner record.

## II. DESCRIPTION OF EVIDENCE FOUND OR METHOD OF LOCATING CORNER POSITION:

This item will describe the original or subsequent record evidence found. If portions of the found evidence cannot be reconciled with the record, then the disregarded record should be noted, and, if possible, an opinion as to its cause narrated.

If no physical evidence of the original or subsequent monuments and accessories can be found, then the method used to reestablish the lost or obliterated corner (single proportion, fence intersection, parol evidence, terrain calls, centerline of road, etc.) shall be indicated.

## III. DESCRIPTION OF MONUMENTS AND ACCESSORIES SET TO PERPETUATE THE CORNER POSITION:

This item should list all details about the corner and its location which will help exclusively identify the corner position; including size and type of monument, how marked if not shown in sketch, and distinguishing topographic calls which help locate the corner. In many cases, instructions on how to find the corner should be included.

References or ties to other corners are optional and may be drawn on the face or back of the corner record form, or references to Certificate of Survey may be made. Separate drawings may be attached to the corner form.

If state plane coordinate values for the corner position are shown, then the control upon which they are based should be indicated.

## IV. SKETCH OF CORNER:

This item will usually show how a found or set corner is marked and may also show topography or accessory monuments found or set and their relation to the corner. There is no stipulated format; the sketch could be transcribed field note entries.

## V. CERTIFICATION:

The name and signature of the ground party chief is optional.

The Surveyor who performed or directed the field work which is depicted on the "Certified Corner Record" shall sign and affix his seal in the Certification.

The employer blank is optional but useful in tracking down original field note data or adjacent record if, in the future, questions arise about the corner.

## VI.

The Cross Index at the bottom of the page should be completed by the Surveyor. Only the single Township Index where the corner is filed shall be completed.

The lower righthand corner is a corner location diagram and should have the pertinent section filled in at the top and a closed circle indicating the appropriate corner position in the section filled in. This is intended to be an aid in searching the "Record" once it has been filed.

1977 BLM Remonumentation: The cor. of Tps. 33 and 34 N., Rs. 24 and 25 W., monumented with an iron post, 2½ ins. diam., firmly set projecting 6 ins. above the ground, with brass cap properly marked, and witnessed by the 1961 bearing trees which are all alive except in the NW quadrant.

A root hole, bears N61°W, 56 lks. dist., with the remains of a pine, mkd. T34N R25W S36 BT lying alongside.

Add the marks 1977 to the brass cap, as shown, from which new bearing trees:

A pine, 8 ins. diam., bears S20½°E, 104 lks. dist., mkd T33N R24W S6 BT.

A pine, 6 ins. diam., bears S56°W, 16 lks. dist., mkd. T33N R25W S1 BT.

A fir, 11 ins. diam., bears N10½°W, 39 lks. dist., mkd T34N R25W S36 BT.

Rebuilt a flat mound of stone, 4 ft. diam., around the iron post.

II. I found a BLM brass cap, 6 ins. above and in a mound of stone, 4x4x2 ft., mkd as shown, from which:

A pine, 8 ins. diam., bears N36°E, 27.9 ft. dist., scribing visible.

A down 6 ft. larch, bears N49°E, 39.1 ft. dist., scribing visible.

A dead snag bears S46°E, 18.6 ft. dist., scribing visible.

A pine, 9 ins. diam., bears S20°E, 69.2 ft. dist., scribing visible.

A pine, 7 ins. diam., bears S55°W, 10.6 ft. dist., scribing visible.

A 6 ft. broken snag, bears N77°W, 44.6 ft. dist., scribing visible.

A snag bears N64°W, 37.3 ft. dist., scribing visible.

A fir, 14 ins. diam., bears N11°W, 25.9 ft. dist., scribing visible.

Rotten remains bears S32°E, 92.4 ft. dist., no mks. visible.

A stump hole bears S70°W, 85.9 ft. dist.

III. I set a 6 ft. galvanized steel guard post with a Survey Marker decal attached, next to the brass cap. I painted red bands around bearing trees and attached BT and Land Survey Monument signs.